

DRAINAGE SYSTEM # 30

12+636, 6.4m LT ~ 12+644, 6.4m LT

601.0@15 450mm RCP, CLASS III 9.175 M

204.20 TRENCH EXCAVATION OF EARTH

CATCH BASIN 1 (Area = 1.54)		CATCH BASIN 2 (Area = 1.54)		HEADWALL		PIPE	
7.75	171.74	6.4	172.192	7.5	170.00	-5.05	170.88
7.25	170.45	6.4	172.539	9.3	170.00	7.5	170.43
5.05	170.15	6.4	172.539	9.3	170.00	7.5	171.41
5.05	170.62	7.75	173.24	8.9	170.00	-5.05	172.12
6.4	170.82	7.75	171.74	8.9	171.35	-5.05	170.88
6.4	171.039	6.4	171.039	7.5	171.41		
7.75	171.74	6.4	171.039	7.5	170.00		
		5.05	170.62				
		6.4	172.192				
AREA = 1.546 km x 1.5		AREA = 4.05 km		Area 2.059 x 3.4		Area 12.1676 x 1.75	
Vol = 2.319 km		Vol = 6.261 km		Vol 7.00 cm		Vol = 22.1183	
Vol = 2.319 km x 2.7 m		Vol = 6.261 km					
		Vol = 4.05 km x 2.7 m					
		Vol = 10.925 km					
TOTAL T.E. 46.379 cm							

DRAINAGE SYSTEM # 29 D

12+781, 6.4m LT ~ 12+781, 8.8m RT

50/1.25 CONC CLASS B
STANDARD D-21
2.0 cm

50/1.5 REINFORCING STEEL
4 #16 BARS @ 2.1 m CA
8.4 x 1.552 = 13.04 kg

604.20 PRECAST CON. CATCH BASIN
1 EA

615.10 STONE FILL, TYPE I
0.3m x 2.7m x 5.1m = 4.13 cu

Elev = 170.90
Sump = 170.0
Road = 170.0
Elev = 170.450

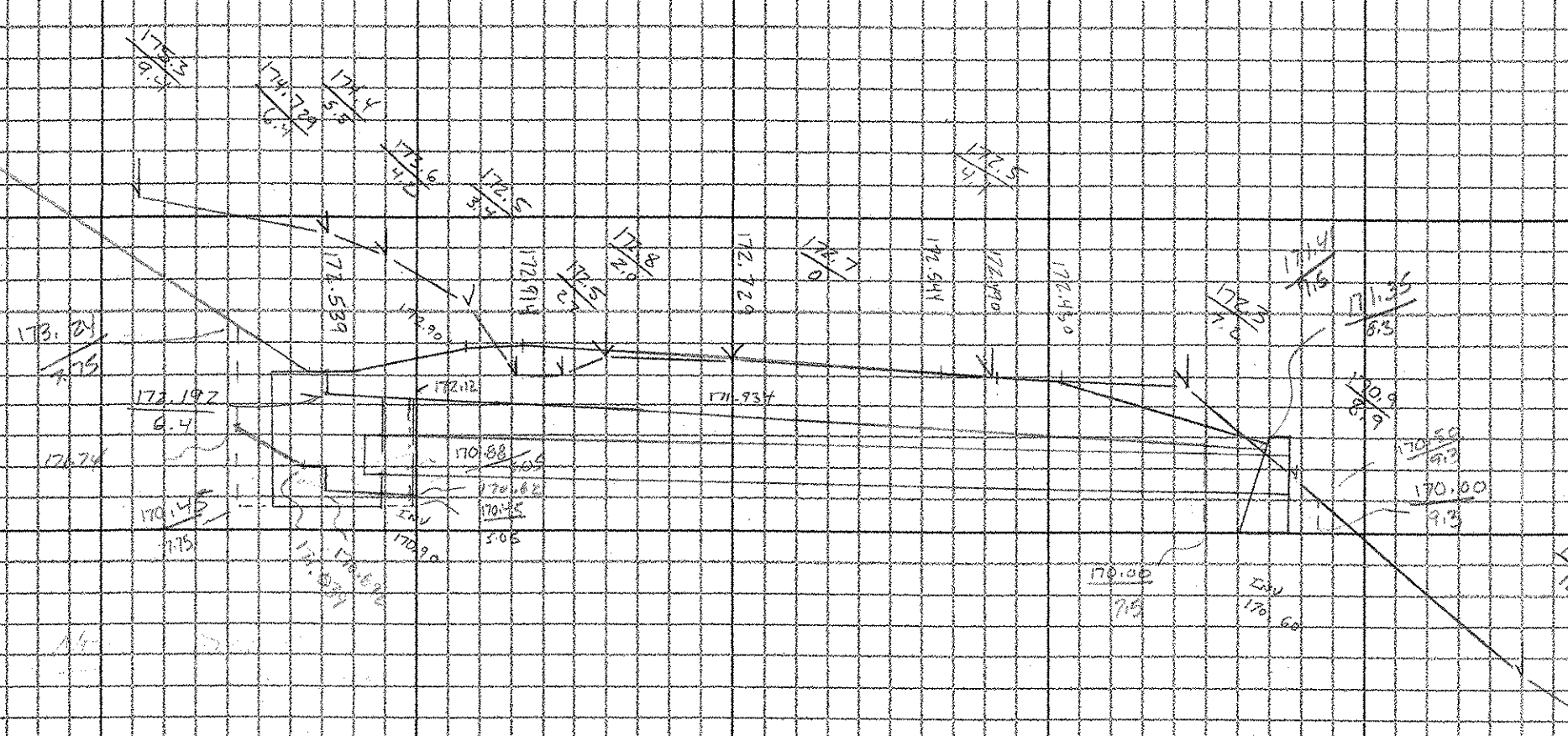

Area 14.63m = 48.11

12+781

NEW 15.2m x 600mm RCP W/ PRECAST CATCH BASIN & CONCRETE HEADWALL
15.24 m



CROSS SECTION SHEET

PROJECT NAME: GRAFTON - Rockingham
 PROJECT NUMBER: STP 0126 (4)5 CONTRACT # 2
 FILE NAME: DRAINAGE PLOT DATE: 07-JUN-2000 13:
 PROJECT LEADER: _____ DRAWN BY: C. GREENWOOD
 DESIGNED BY: _____ CHECKED BY: D. BERRY
 const: g:/common/cadd/m-xsection.dgn SHEET 23 OF 23

144 DRAIN