

DRAINAGE SYSTEM # 27
 STA 12+419, 9.0m LT - 12+463, 8.5m RT

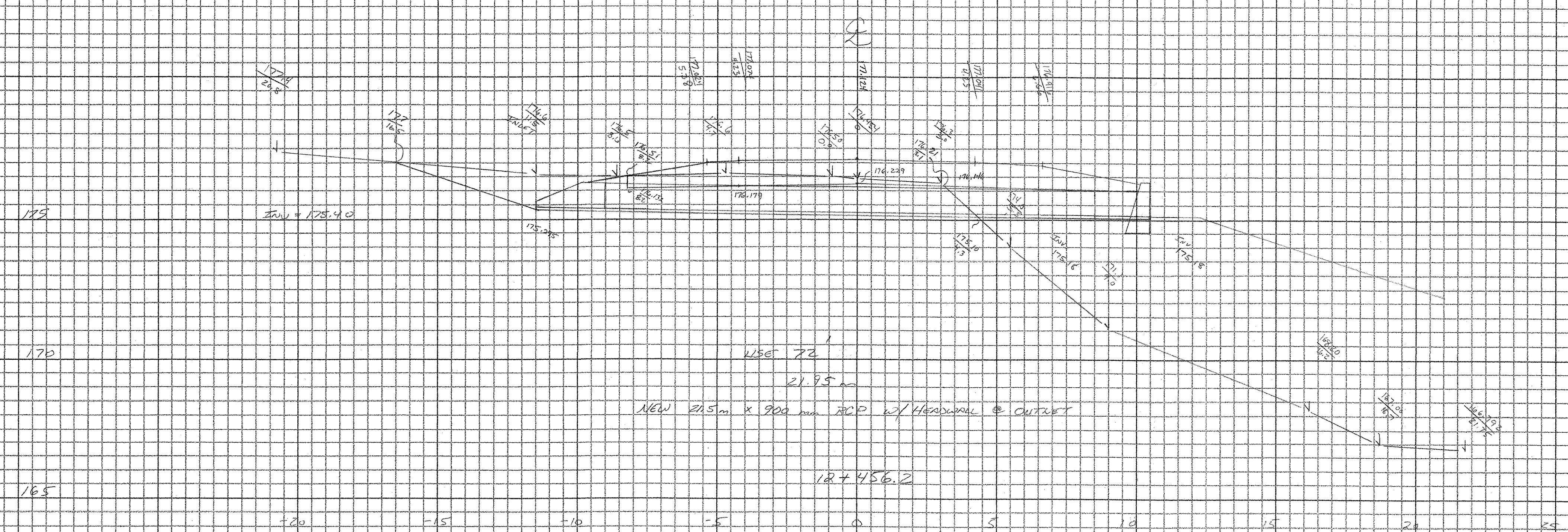

61311 STONE FILL, TYPE II
 5m @ C. GREENWOOD
 0.6m x 5.0m @ 23.5m = 170.5 cu m
 61931 GRD UNDER STONE FILL
 5.0m x 23.5m = 117.5 cu m

TRN 51.54 = 3.3
 Y = 2.670
 SUM 51.24 = 3.3
 X = 4.226
 TRN 51.31 = 5.2
 Y = 4.160
 SUM 51.31 = 5.2
 X = 6.859

Station	Ground Elevation	Proposed Elevation	Depth
12+403.6	172.026	172.026	0.00
12+452.8	173.107	173.107	0.00
12+456.2	173.184	173.184	0.00
12+458.6	173.199	173.199	0.00
12+458.6	173.199	172.088	1.111
12+458.6	173.199	172.144	1.055

SLOPE RT =
 = 205.01310 / 156.310 = 1.313
 = 1.313
 OR 1:1.31

Depth	Width	Area
-16.5	17.70	293.0
-11.5	17.5295	201.6
-4.3	17.510	75.5
-3.1	17.621	54.6
-2.2	17.6299	38.9
-2.2	17.6132	38.7
-2.2	17.651	38.8
-2.2	17.658	38.9
-11.5	17.6167	201.5
-16.5	17.701	293.1
Total		19.486 cu m

Vol = 19.486 cu m x 2.11 m
 Total = 41.115 cu m

6612845 900mm RCP, CLASS III
 21.95m
 601 601G 900mm DPIPE'S
 * NO END SECTION ASSED
 5M 65 CONCRETE CLASS B
 * NO HEADWALL ASSED
 5015 REIN STEEL
 * NO HEADWALL USED

NOT TO SCALE



CROSS SECTION SHEET

PROJECT NAME: GRAFTON - ROCKINGHAM
 PROJECT NUMBER: STP 0136 (4)S CONTRACT # 2
 FILE NAME: DRAINAGE PLOT DATE: 07-JUN-2000 13:
 PROJECT LEADER: C. GREENWOOD DRAWN BY: C. GREENWOOD
 DESIGNED BY: BRENN CHECKED BY: BRENN
 const: g:/common/cadd/m-xsection.dgn SHEET 21 OF 23

142 DRAIN