

**WALL CONSTRUCTION NOTES:**

**GENERAL:**

1. ALL MATERIALS AND CONSTRUCTION SHALL CONFORM TO STATE OF VERMONT, AGENCY OF TRANSPORTATION STANDARD SPECIFICATIONS FOR CONSTRUCTION, DATED 2001, AND ITS LATEST REVISIONS, AND THE AASHTO STANDARD SPECIFICATIONS FOR HIGHWAY BRIDGES, DATED 1996, AND ITS LATEST REVISIONS.
2. ALL DIMENSIONS ARE HORIZONTAL OR VERTICAL AND ARE GIVEN AT 68 DEGREES F UNLESS NOTED OTHERWISE.
3. FOR EXISTING SOIL INFORMATION, SEE BORING LOGS PREPARED BY NOBIS ENGINEERING IN THE CONTRACT DOCUMENTS. SEE ROADWAY PLANS FOR BORING LOCATIONS.
4. THE CONTRACTOR SHALL PROVIDE SUFFICIENT SURVEY CONTROL LINES SO THAT THE RETAINING WALLS CAN BE LAYED OUT ACCURATELY.

**WALLS ON LEDGE:**

1. WHERE FOOTINGS ARE FOUNDED ON LEDGE, THE LEDGE SHALL BE CLEANED OF ALL LOOSE ROCK AND OTHER DEBRIS. THE LEDGE SHALL BE REMOVED AS REQUIRED TO ENSURE THE FOOTINGS ARE PLACED ON COMPETENT ROCK.
2. WHERE LEDGE IS 300mm OR LESS BELOW THE DESIGN BOTTOM OF FOOTING ELEVATION, THE FOOTING SHALL BE POURED FROM THE TOP OF THE LEDGE USING "CONCRETE CLASS B".
3. THE SUBSTRUCTURE UNITS HAVE BEEN DESIGNED FOR THE BOTTOM OF FOOTING ELEVATIONS AS SHOWN ON THE PLANS. WHEN THE LEDGE ELEVATION IS GREATER THAN 300mm BELOW THE DESIGN BOTTOM OF FOOTING, THE FOOTING SHALL BE FOUNDED ON SOIL.
4. WHERE THE LEDGE ELEVATION IS 300 mm ABOVE THE DESIGN BOTTOM OF FOOTING, THE LEDGE SHALL BE EXCAVATED DOWN TO THE BOTTOM OF FOOTING ELEVATION. ALL OVERBREAKAGE BELOW THIS ELEVATION SHALL BE REPLACED WITH "CONCRETE CLASS B". A MAXIMUM OF 150mm AVERAGE DEPTH OF OVERBREAKAGE REPLACEMENT SHALL BE PAID FOR AS "CONCRETE CLASS B". ANY ADDITIONAL CONCRETE SHALL BE PAID FOR AT THE CONTRACTORS EXPENSE. ALL LEDGE REMOVAL IS PAID FOR UNDER THE ITEM 208.35 - COFFERDAM EXCAVATION (ROCK).
5. IF LEDGE IS GREATER THAN 300 mm ABOVE THE DESIGN BOTTOM OF FOOTING, THE BOTTOM OF FOOTING ELEVATION MAY BE RAISED, BUT THE BOTTOM OF FOOTING MUST REMAIN A MINIMUM OF 1.0M BELOW FINISH GRADE. BEFORE ANY ADJUSTMENT IS MADE TO FOOTING ELEVATIONS THE ENGINEER SHALL BE CONTACTED FOR APPROVAL OF THE CONFIGURATION.
6. MINIMUM BOTTOM OF FOOTING DEPTH BELOW FINISH GRADE WHERE FOUNDED ON SOIL IS 1.5M AND 1.0M WHERE FOUNDED ON LEDGE.
7. BLASTING FOR WALL CONSTRUCTION IS NOT ALLOWED EXCEPT BY APPROVAL OF THE ENGINEER. IF BLASTING IS REQUIRED AND/OR PERMISSIBLE IN THIS LOCATION THEN THE CONTRACTOR SHALL ACT IN ACCORDANCE WITH VERMONT STANDARD SPECIFICATION 501.10 (f).

**CONCRETE:**

1. THE MINIMUM COVER FOR REINFORCING STEEL IN THE SUBSTRUCTURES SHALL BE 50mm ALONG WALL FACES AGAINST EARTH, AND 75mm ELSEWHERE UNLESS DETAILED OTHERWISE.
2. REINFORCING STEEL PLACEMENT TOLERANCES SHALL BE AS FOLLOWS:  
 SPACING +/- 50 mm  
 CLEARANCE +/- 6 mm
3. THE KEY IN CONCRETE CONSTRUCTION JOINTS SHALL BE MONOLITHIC AND CONTINUOUS FOR THE FULL LENGTH OF THE JOINT. UPWARD KEYS SHALL BE PLACED INTEGRALLY WITH THE CONCRETE BELOW THE JOINT. JOINTS AND SCORE MARKS IN THE CONCRETE SHALL BE CONSTRUCTED AS INDICATED ON THE PLANS OR AS DIRECTED BY THE ENGINEER.
4. ALL EXPOSED EDGES OF CONCRETE SHALL BE CHAMFERED 25 mm X 25 mm.

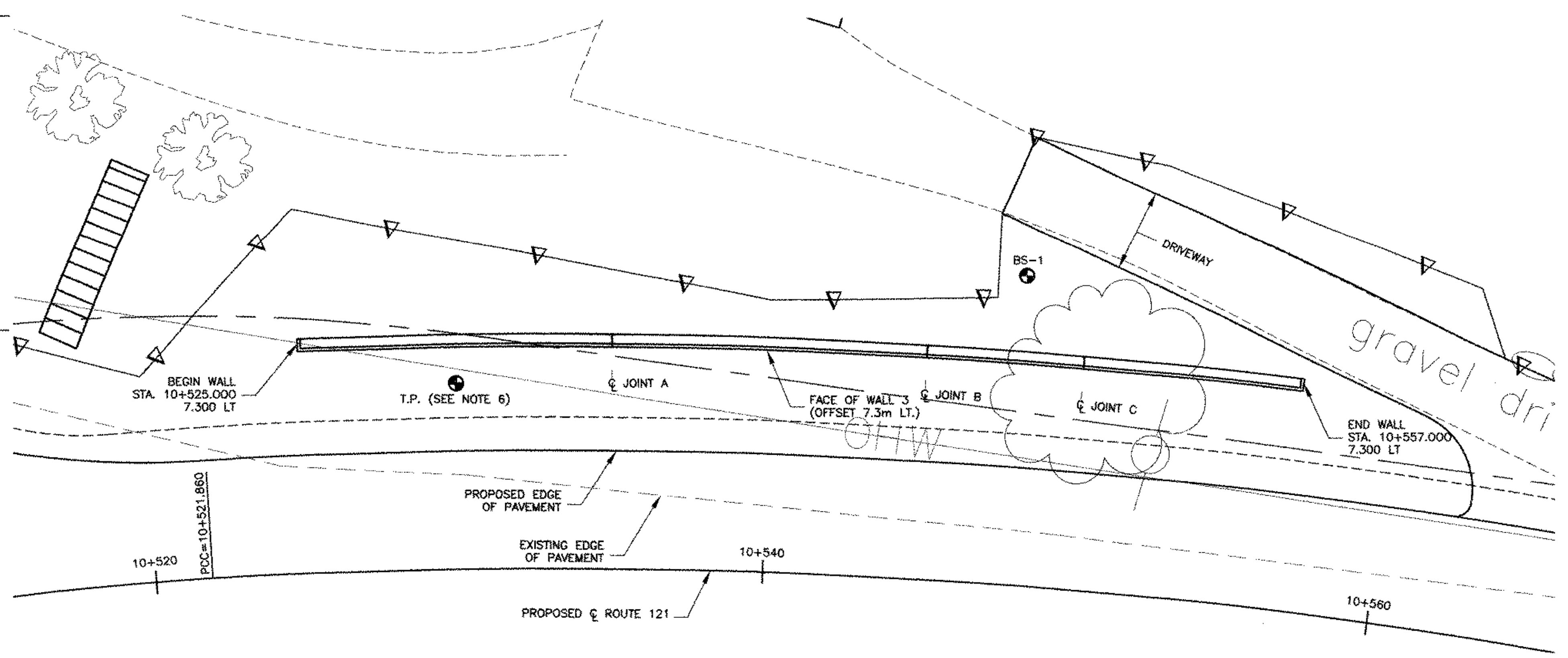

**PLAN**  
SCALE 1:100

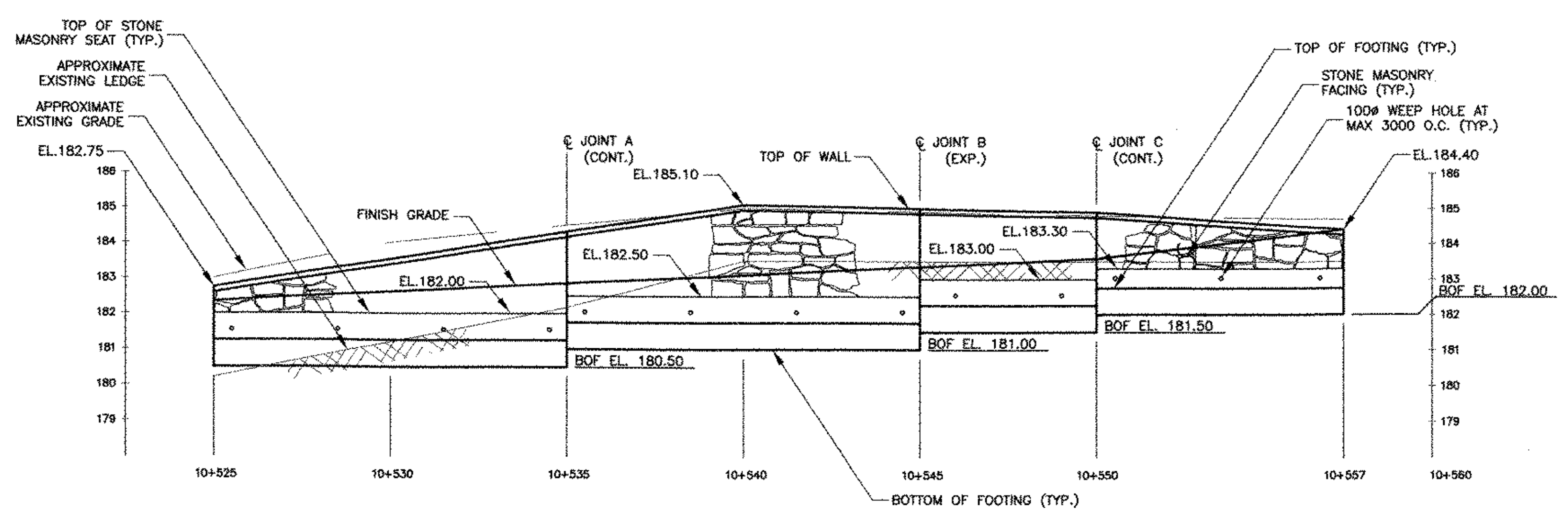

**WALL 3 ELEVATION**  
SCALE 1:100

**NOTES:**

1. SEE ROADWAY PLAN SHEETS FOR PROJECT LIMITS OF CONSTRUCTION, ROADWAY GEOMETRY, ROADWAY CROSS SECTIONS AND BORING LOCATIONS. SEE THIS SHEET FOR WALL CONSTRUCTION NOTES.
2. WALL OFFSETS TO FACE OF WALL.
3. WALL LENGTHS AND DISTANCE BETWEEN JOINTS ARE BASED ON ROADWAY STATIONING, ACTUAL WALL LENGTHS AT FACE OF WALL ARE SHORTER THAN STATIONING SHOWN.
4. STONE MASONRY FACING ON WALL SHALL NOT COVER THE JOINTS IN THE WALL.
5. REFER TO WALL SHEET 2 FOR WEEP HOLE AND JOINT DETAILS.  
(CONT) = CONTRACTION JOINT.  
(EXP) = EXPANSION JOINT.
6. A TEST PIT (T.P.) TAKEN AT THE LOCATION SHOWN ON 9/26/02 INDICATES THE MATERIAL TO BE A CLEAN BANK RUN GRAVEL. THE TEST PIT WAS DUG TO 1.8 m BELOW EXISTING GRADE AND NO LEDGE WAS ENCOUNTERED.

DATUM	
VERTICAL	NGVD 1929
HORIZONTAL	NAD 1927

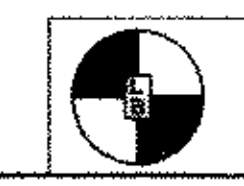
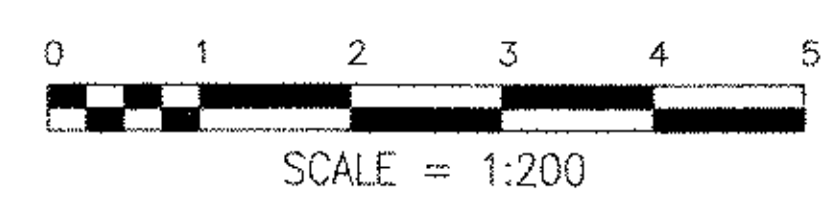

THE LOUIS BERGER GROUP, INC.

Town Of <b>GRAFTON - ROCKINGHAM</b>	Bridge No.
Highway No. <b>ROUTE 121</b>	Log Sta.
	Surv. Sta.
<b>ROUTE 121</b>	
<b>GENERAL PLAN AND ELEVATION - WALL 3</b>	
Designed By JPB	Drawn By JBB
Checked By JPC	Date 12/03
Bridge Design Supervisor	
Date	
PROJECT <b>GRAFTON - ROCKINGHAM</b>	PROJECT NO. <b>STP 0126(4)-S</b>
I.G.C. Info. <b>V:\1261\Cadd\STRUCTURAL\PLANS\WallPlanC2.dwg</b>	
Wall Sheet No. 1	Sheet 112 of 116