

$A_1 = \frac{3.01}{2.94} = 1.02$   
 $A_2 = \frac{1.86}{1.84} = 1.01$   
 $\frac{2.94}{8.9/3} = 2.97$   
 $\frac{1.86}{5.56/3} = 1.01$

AREA: 4.82 sqm

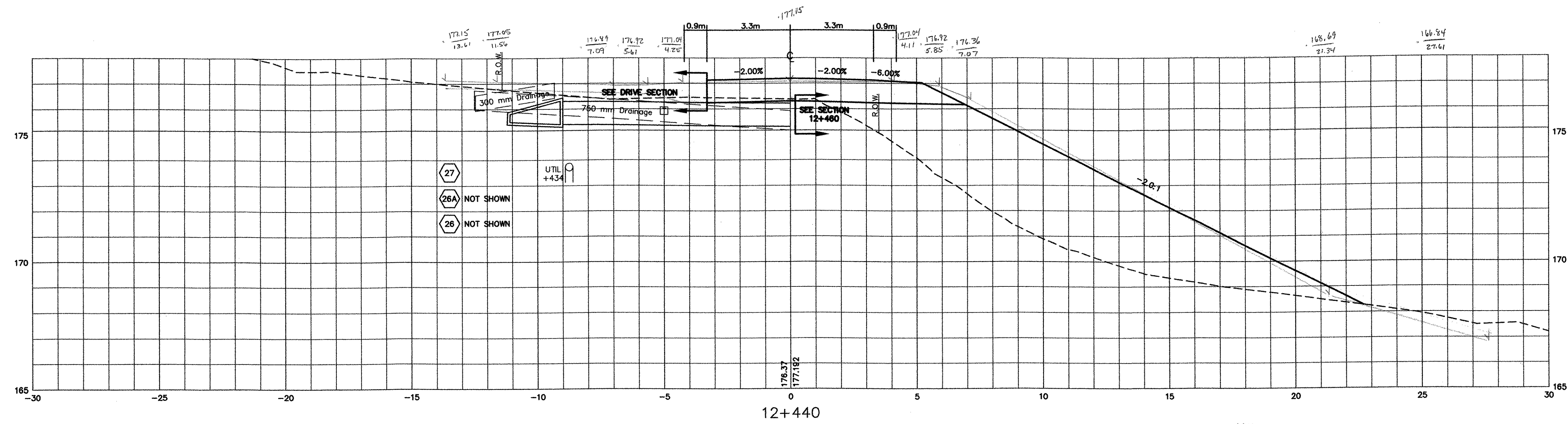

AREA 0.86  
 $\frac{0.79}{2.38/3} = 0.79$

Lead  
 0.86  
 2/10/06

JT  
 2/10/06

DATUM	
VERTICAL	NGVD 1929
HORIZONTAL	NAD 1927

V:/1261/CADD/PLANS/SECTIONS-FINAL-ROUTE121-C2C.DWG

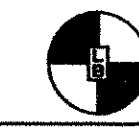

THE LOUIS BERGER GROUP, INC.

ROUTE 121 CROSS SECTIONS	
PROJECT: GRAFTON-ROCKINGHAM, ROUTE 121	PROJECT NO. : STP 0126(4)S
DESIGN FILE NAME: IPARM FILE NAME: SURVEYED BY: SQUAD LEADER:	PLOT DATE: 12/08/03 SURVEY DATE: DRAWN BY: SHEET: 92 OF 116