

- 1.) CONSTRUCT ROADWAY UTILIZING ALTERNATING ONE WAY TRAFFIC.
- 2.) CONSTRUCT RIGHT SIDE OF ROADWAY FIRST
- 3.) ROADWAY MUST BE CONSTRUCTED TO AT LEAST TOP OF SUBBASE AT THE END OF EVERY WORK DAY.
- 4.) CONTRACTOR TO INSTALL TEMPORARY FENCE AS NECESSARY IN FIELDS.

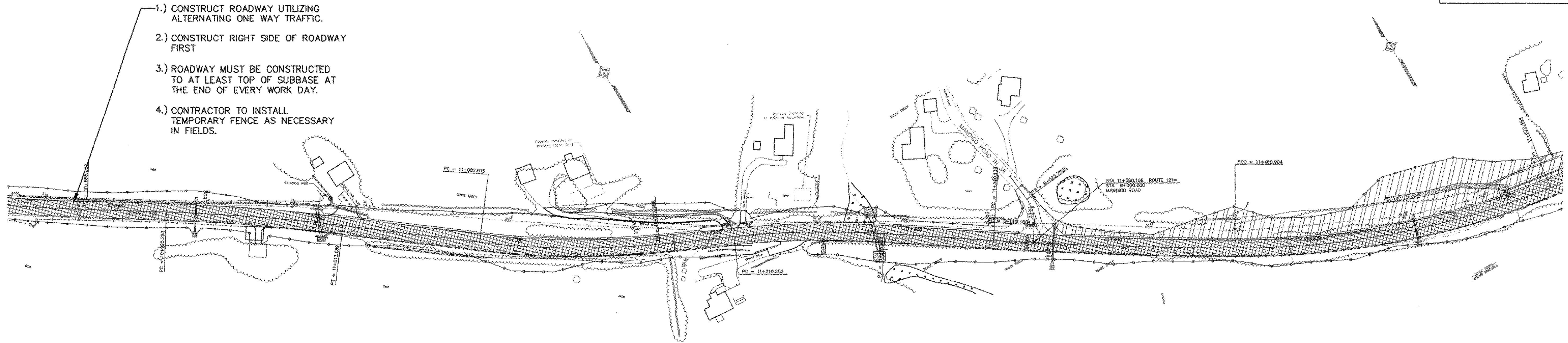

- 1.) CONSTRUCT ROADWAY UTILIZING ALTERNATING ONE WAY TRAFFIC.
- 2.) CONSTRUCT RIGHT SIDE OF ROADWAY FIRST
- 3.) ROADWAY MUST BE CONSTRUCTED TO AT LEAST TOP OF SUBBASE AT THE END OF EVERY WORK DAY.

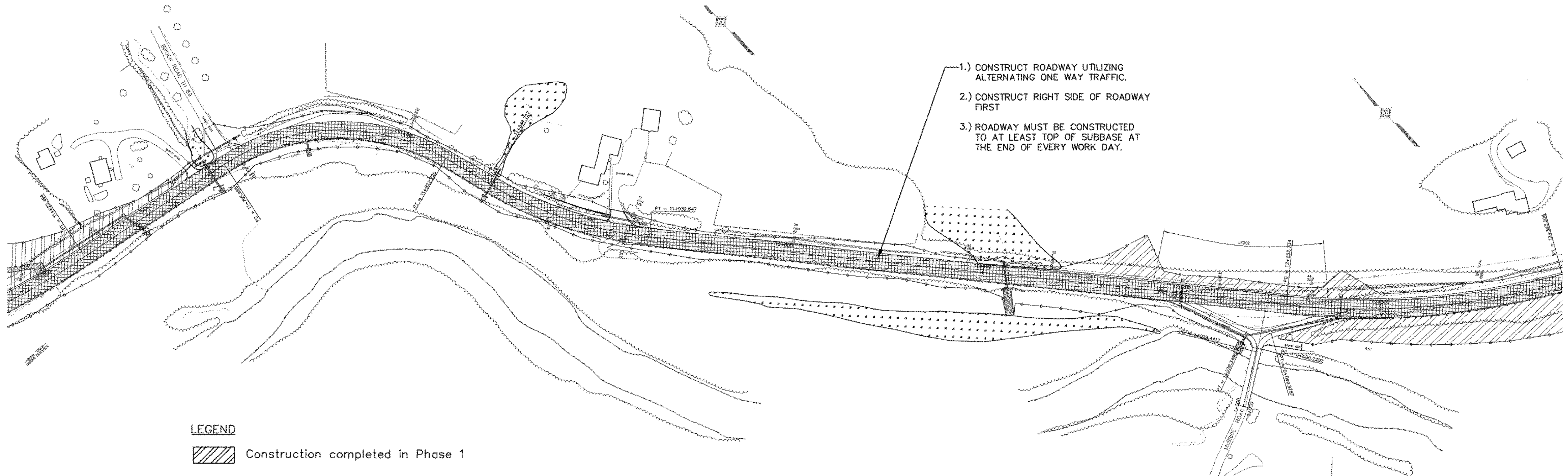

- LEGEND**
- Construction completed in Phase 1
  - Construction after completion of Weaver Brook Bridge
  - Construction concurrent with Weaver Brook Bridge

DATUM  
 VERTICAL NGVD 1929  
 HORIZONTAL NAD 1927

V: /1261/CADD/PLANS/TCP--C2.DWG

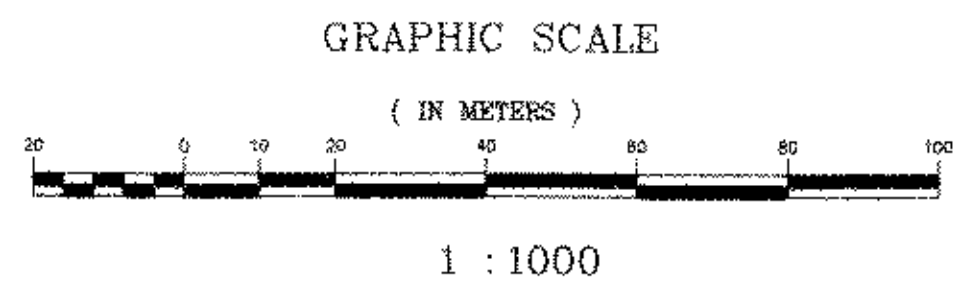

THE LOUIS BERGER GROUP, INC.

ROUTE 121 TRAFFIC CONTROL PLAN	
PROJECT: GRAFTON-ROCKINGHAM, ROUTE 121	PROJECT NO. : STP 0126(4)S
DESIGN FILE NAME: IPARM FILE NAME: SURVEYED BY: SQUAD LEADER:	PLOT DATE: 12/08/03 SURVEY DATE: DRAWN BY: SHEET: 41 OF 116