

3+010
END APPROACH
BEGIN PROJECT
BETHEL MILLS DRIVE
BM STA 3+010.000

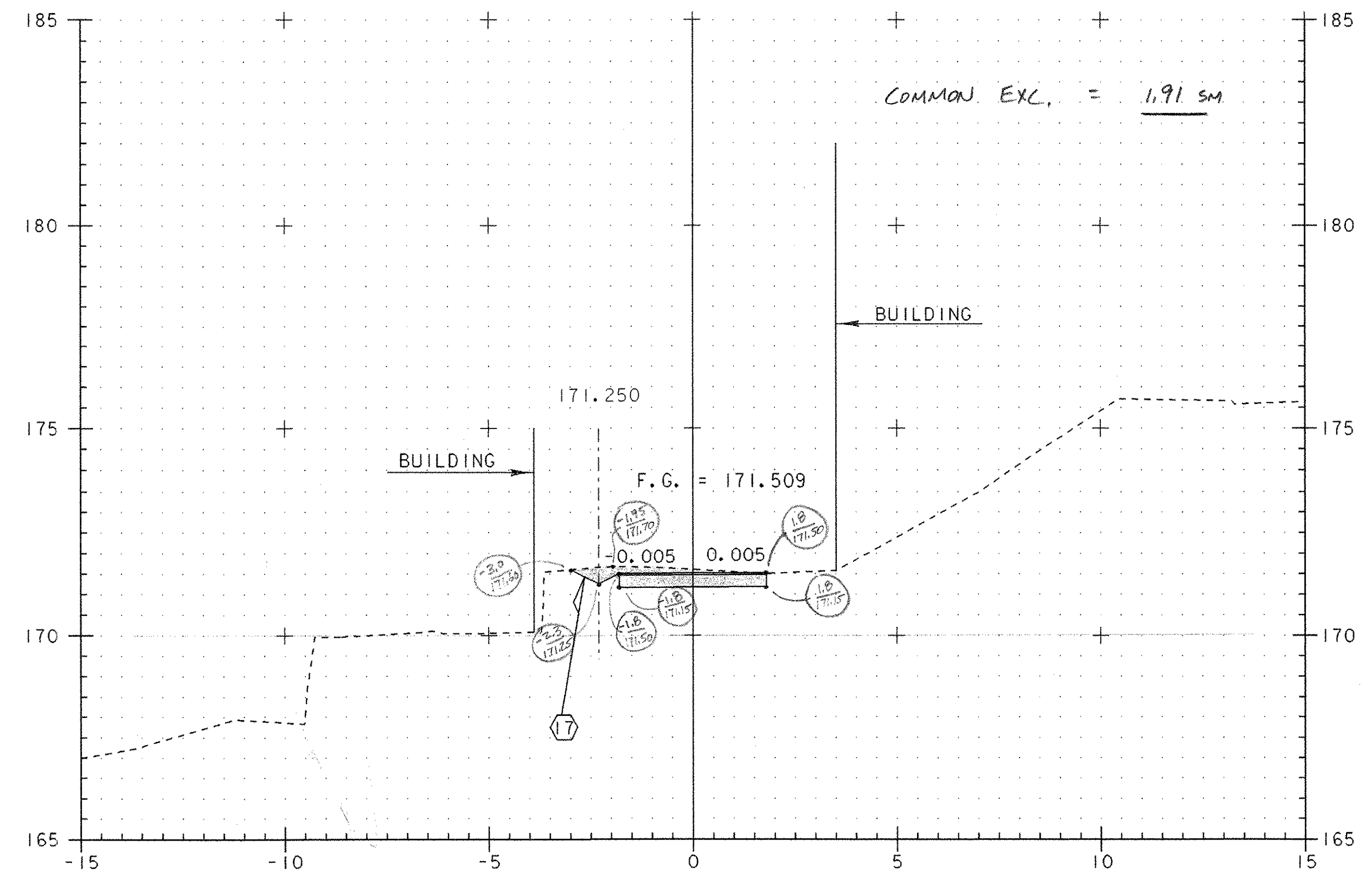

3+020

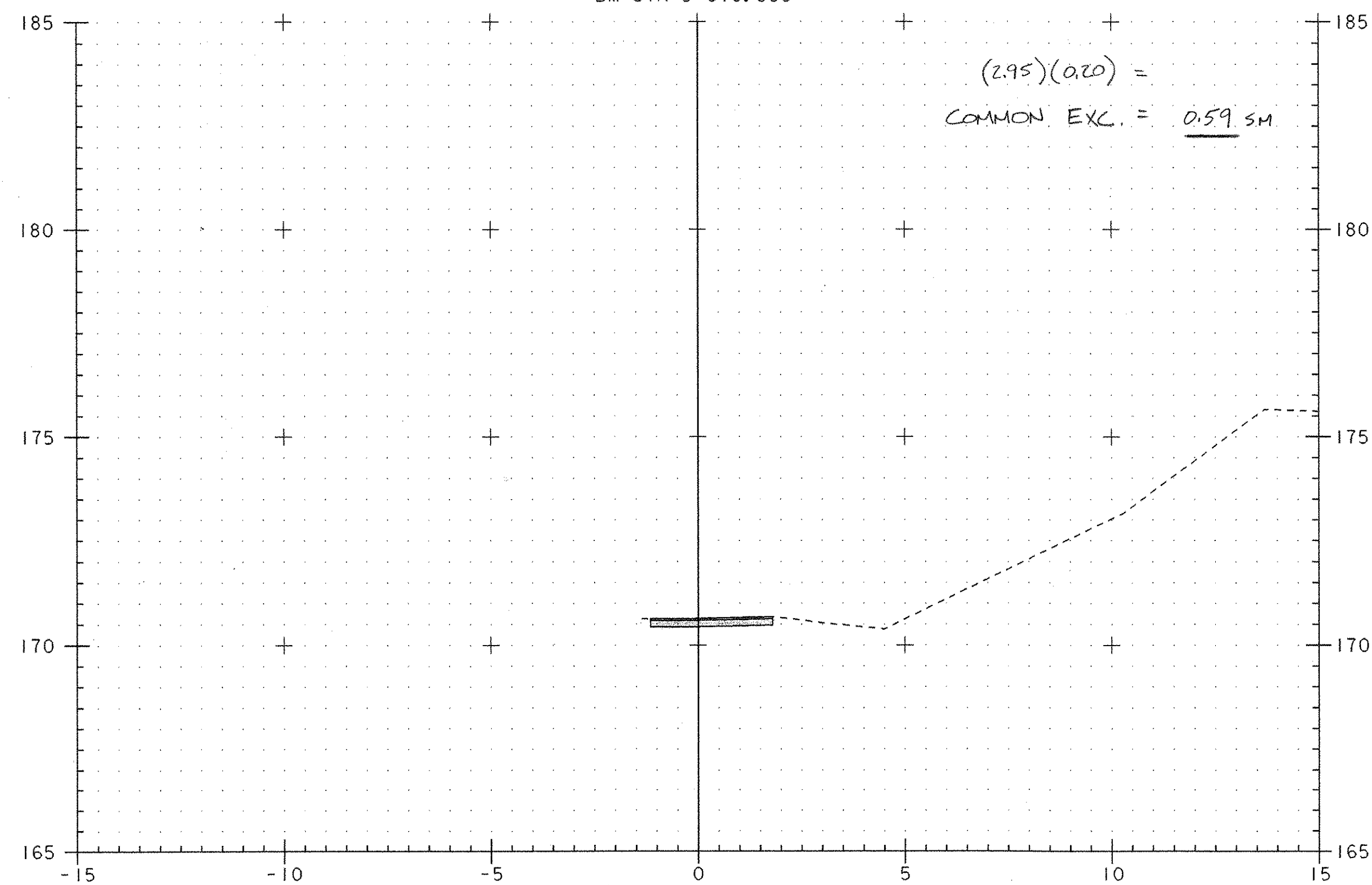

3+005
BEGIN APPROACH
BETHEL MILLS DRIVE
STA 3+003.500

COMMON EXC. = 0.59 SM

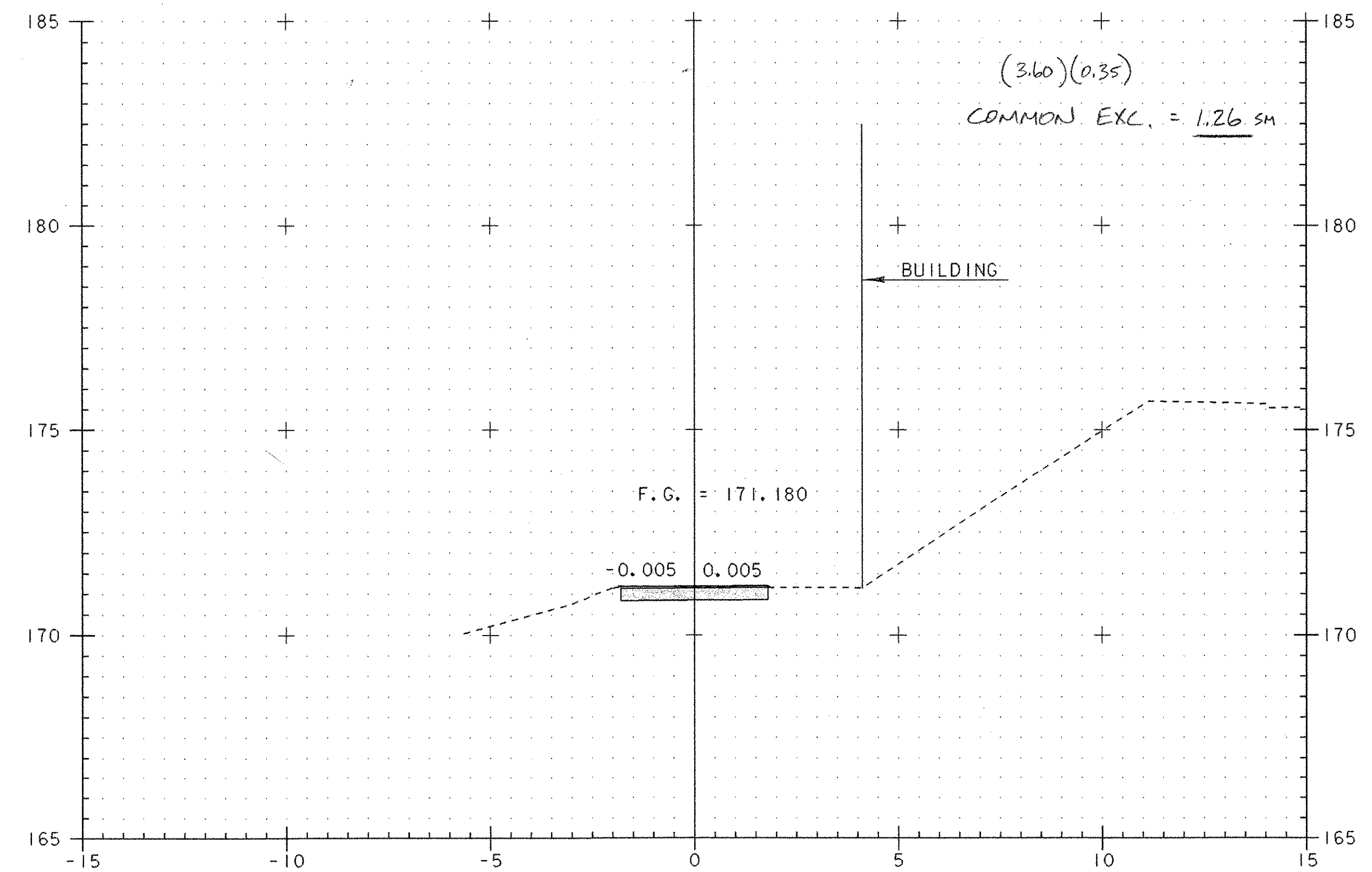

3+015



PROJECT: BETHEL	PROJECT NO. : BRF0241 (33) C/2
DESIGN FILE NAME: 02c180/Structures/s02c180xsec.dgn	PLOT DATE: 14-APR-2005
IPARM FILE NAME: sc180bml.i	
BETHEL MILLS DRIVE SECTIONS	
STA 3+005 Thru STA 3+020	SHEET: 94 OF 130

Pat
4-9-07