

TEMPORARY 4" YELLOW LINE, PAINT  
 STA 257+00 TO STA 264+50, SOLID LT & RT  
 4" YELLOW LINE  
 STA 257+00 TO STA 264+50, SOLID LT & RT

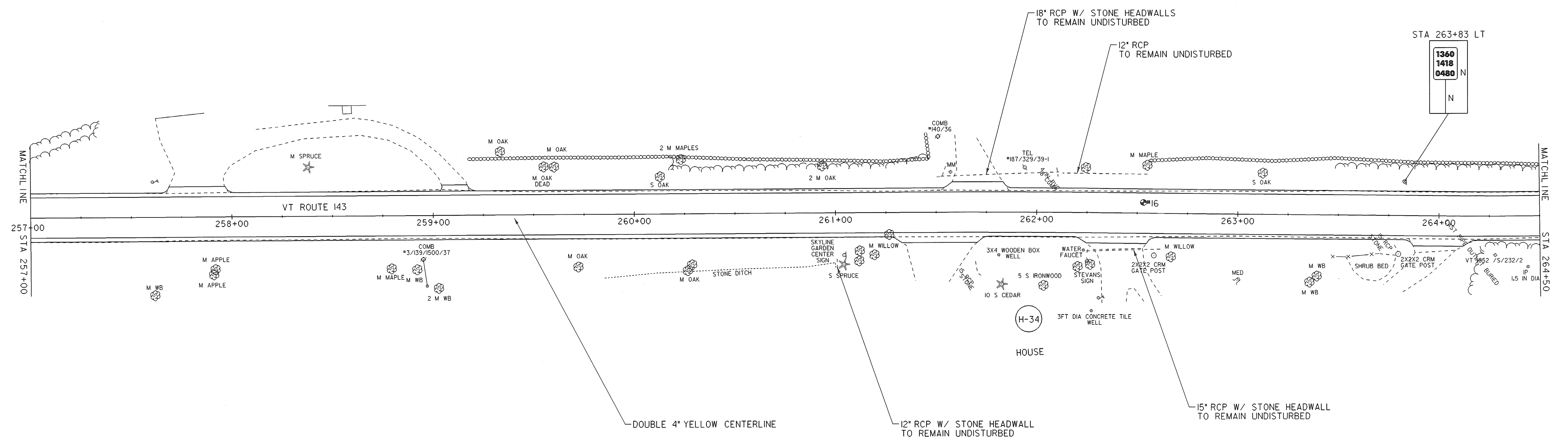
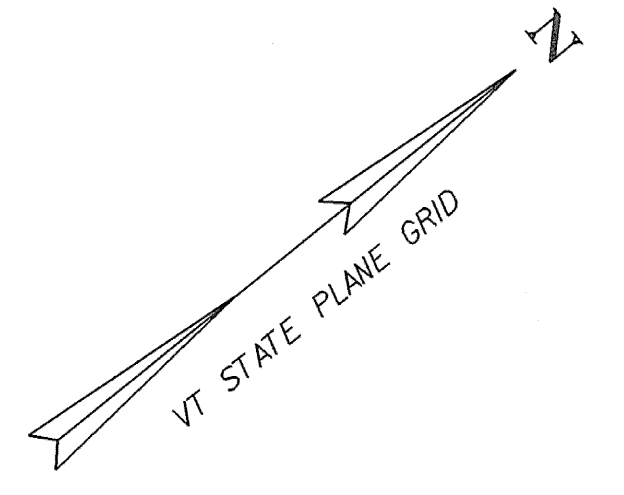

STA 263+83 LT  
 1360  
 1418  
 0480 N  
 N

**LEGEND**

R	= REMOVE EXISTING
S	= SALVAGE
R&S	= REMOVE & SALVAGE
N	= NEW
RET	= RETAIN
B-B	= BACK TO BACK

- NOTES:**
- EXISTING SHOULDER MATERIAL ON TOWN HIGHWAYS SHALL BE EXCAVATED TO A DEPTH OF 3' OR AS DIRECTED BY THE RESIDENT ENGINEER. SEE GENERAL NOTE #6 SHEET 3 FOR MORE INFORMATION.
  - SEE SHEET 5 & 10 FOR REDUCED STEEL BEAM GUARDRAIL POST SPACING FOR CULVERT AND UTILITY POLE DETAILS.
  - WHITE LINES SHOWN ON PLANS IS FOR DISPLAY PURPOSES ONLY.

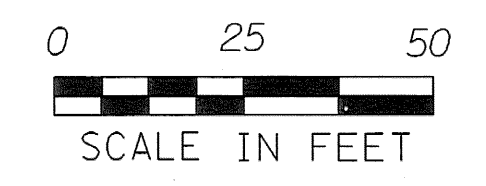

⊕ PAVEMENT CORES

NUMBER	TOTAL DEPTH	SOLID CORE	COMMENTS
16	6 1/2'	TOP 4 1/2'	NO

**LAYOUT SHEET #27**

PROJECT NAME:	SPRINGFIELD
PROJECT NUMBER:	STP 0136(I)
FILE NAME: ...02C084\...02C084_nul.dgn	PLOT DATE: 30-DEC-2008
PROJECT LEADER: K. UPMAL	DRAWN BY: B. KIPP\N. PAPPAS
DESIGNED BY: B. KIPP\N. PAPPAS	CHECKED BY: N. PAPPAS
IPARM FILE NAME: 02c084_lay_27	SHEET 40 OF 68