

TEMPORARY 4" YELLOW LINE, PAINT
 STA 197+00 TO STA 198+53, SOLID LT & RT
 STA 198+95 TO STA 204+50, SOLID LT & RT
 STA 198+67 LT, SOLID LT & RT

4" YELLOW LINE, PAINT
 STA 197+00 TO STA 198+53, SOLID LT & RT
 STA 198+95 TO STA 204+50, SOLID LT & RT
 STA 198+67 LT, SOLID LT & RT

REMOVING SIGNS
 STA 198+80 LT

TEMPORARY 24" STOP BAR, PAINT
 STA 198+56 LT GREELY ROAD

TEMPORARY LETTER OR SYMBOL, PAINT
 STA 198+62 LT "STOP"

STEEL BEAM GUARDRAIL, GALVANIZED
 STA 197+00 TO STA 197+15 LT
 STA 197+43 TO STA 198+37 LT

ANCHOR FOR STEEL BEAM RAIL
 STA 197+18 LT
 STA 197+43 LT
 STA 198+37 LT

DELINEATOR WITH STEEL POSTS
 STA 197+18 LT
 STA 197+43 LT
 STA 198+37 LT

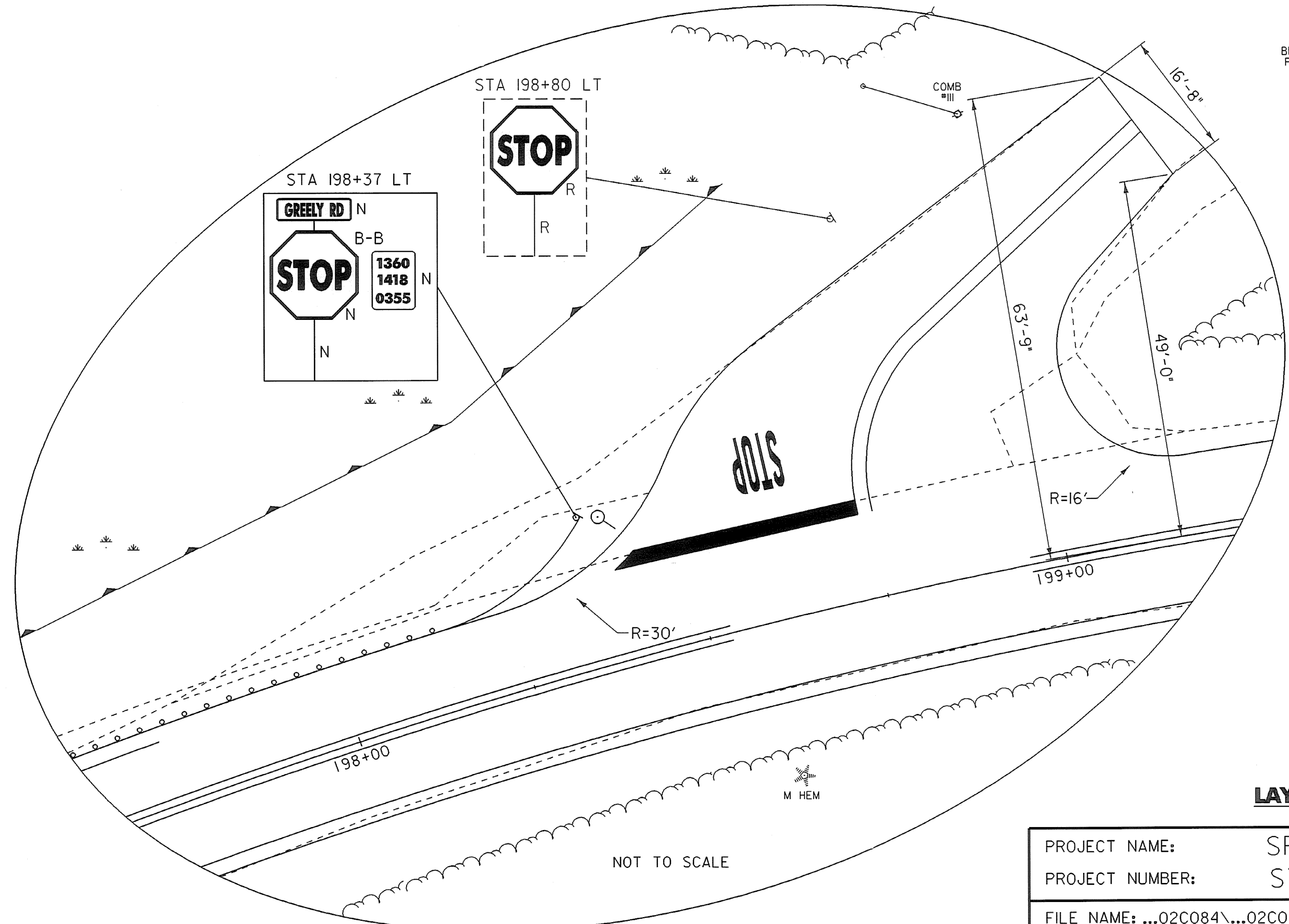
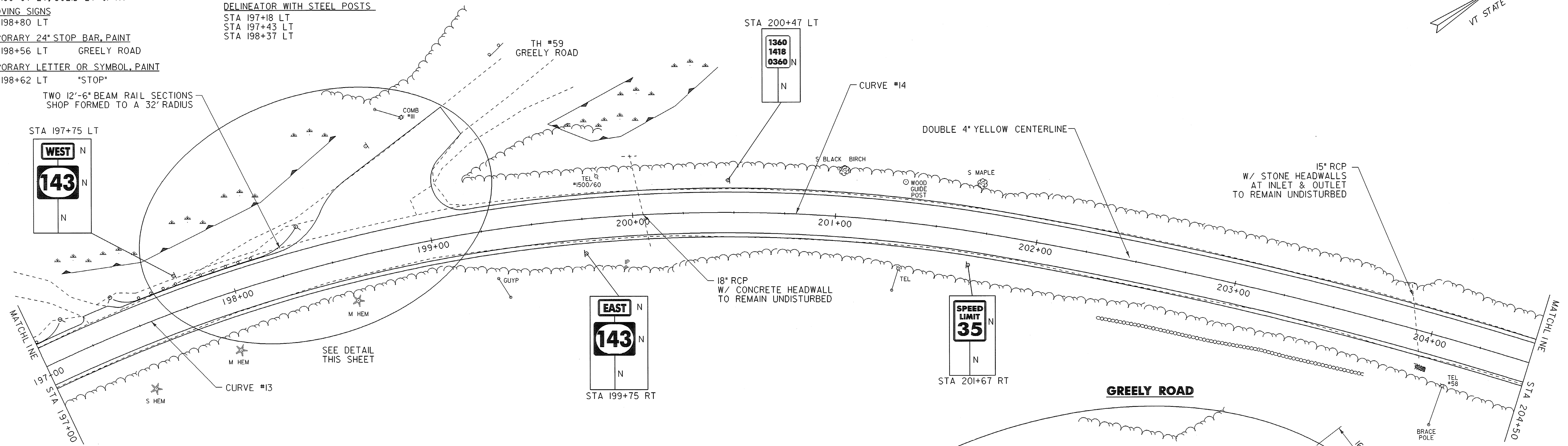
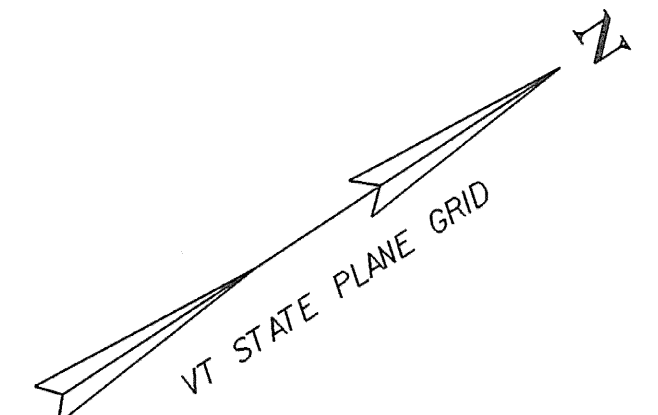

LEGEND

R = REMOVE EXISTING
 S = SALVAGE
 R&S = REMOVE & SALVAGE
 N = NEW
 RET = RETAIN
 B-B = BACK TO BACK

NOTES:

- EXISTING SHOULDER MATERIAL ON TOWN HIGHWAYS SHALL BE EXCAVATED TO A DEPTH OF 3" OR AS DIRECTED BY THE RESIDENT ENGINEER. SEE GENERAL NOTE #6 SHEET 3 FOR MORE INFORMATION.
- SEE SHEET 5 & 10 FOR REDUCED STEEL BEAM GUARDRAIL POST SPACING FOR CULVERT AND UTILITY POLE DETAILS.
- WHITE LINES SHOWN ON PLANS IS FOR DISPLAY PURPOSES ONLY.



LAYOUT SHEET #19

PROJECT NAME: SPRINGFIELD
 PROJECT NUMBER: STP 0136(1)

FILE NAME: ...02C084...02C084_nul.dgn PLOT DATE: 06-JAN-2009
 PROJECT LEADER: K. UPMAL DRAWN BY: B. KIPP\N. PAPPAS
 DESIGNED BY: B. KIPP\N. PAPPAS CHECKED BY: N. PAPPAS
 IPARM FILE NAME: 02c084.lay_19 SHEET 32 OF 68