

TEMPORARY 4" YELLOW LINE, PAINT
 STA 92+00 TO STA 97+57, SOLID LT & RT
 STA 97+99 TO STA 99+50, SOLID LT & RT
 STA 99+96 RT, SOLID LT & RT

4" YELLOW LINE
 STA 92+00 TO STA 97+57, SOLID LT & RT
 STA 97+99 TO STA 99+50, SOLID LT & RT
 STA 99+96 RT, SOLID LT & RT

REMOVING SIGNS
 STA 95+08 LT
 STA 97+96 RT
 STA 98+02 RT

ERECTING SALVAGED SIGNS
 STA 97+94 RT

RELOCATE MAILBOX, MULTIPLE SUPPORT
 STA 98+53 LT

TEMPORARY 24" STOP BAR, PAINT
 STA 97+85 RT PARK FARM ROAD

TEMPORARY LETTER OR SYMBOL, PAINT
 STA 97+85 RT "STOP"

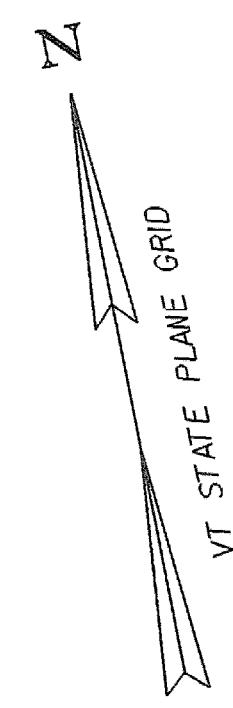
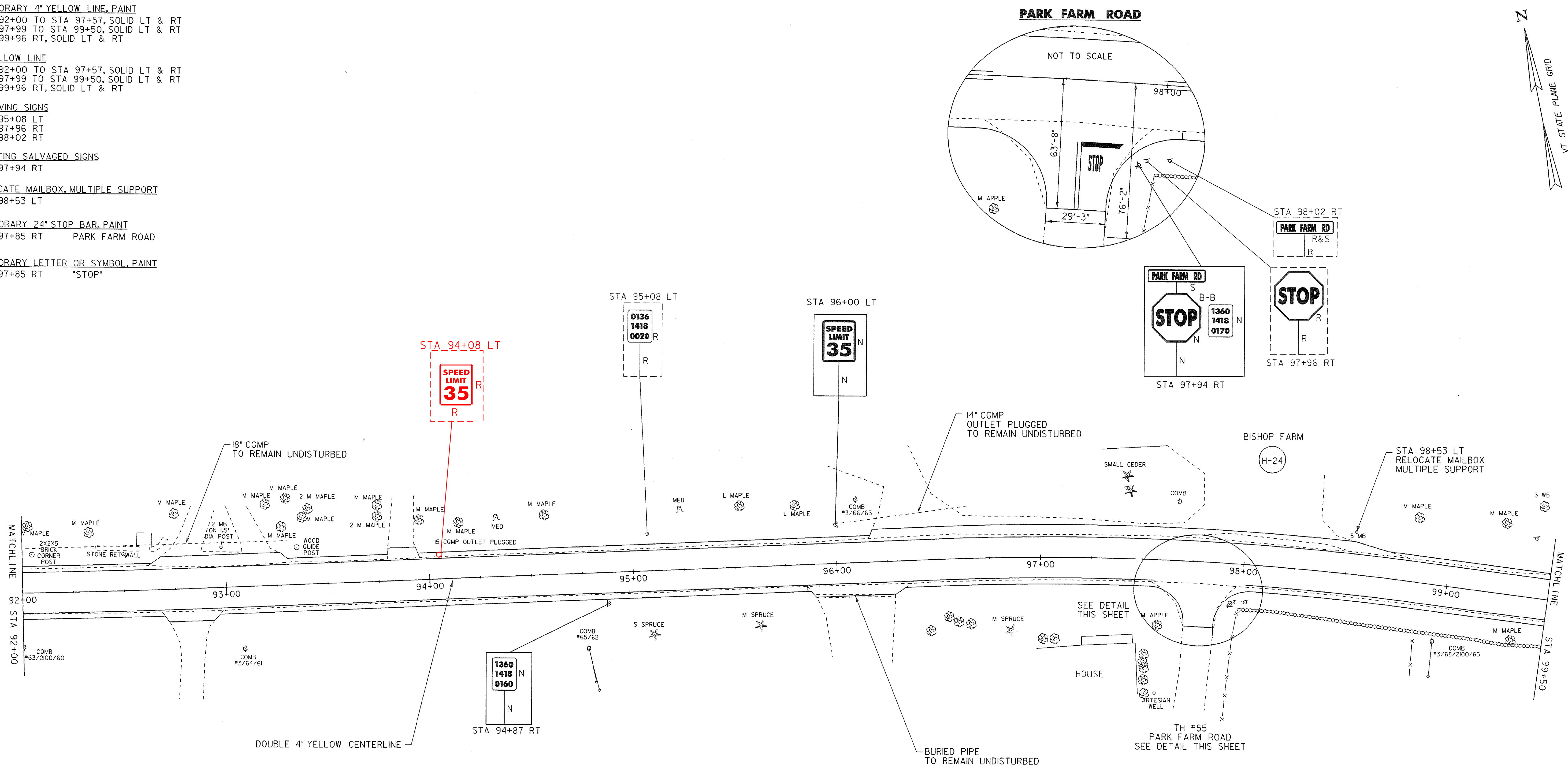

LEGEND	
R	= REMOVE EXISTING
S	= SALVAGE
R&S	= REMOVE & SALVAGE
N	= NEW
RET	= RETAIN
B-B	= BACK TO BACK

- NOTES:
- EXISTING SHOULDER MATERIAL ON TOWN HIGHWAYS SHALL BE EXCAVATED TO A DEPTH OF 3" OR AS DIRECTED BY THE RESIDENT ENGINEER. SEE GENERAL NOTE #6 SHEET 3 FOR MORE INFORMATION.
 - SEE SHEET 5 & 10 FOR REDUCED STEEL BEAM GUARDRAIL POST SPACING FOR CULVERT AND UTILITY POLE DETAILS.
 - WHITE LINES SHOWN ON PLANS IS FOR DISPLAY PURPOSES ONLY.

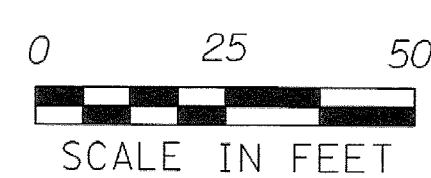

LAYOUT SHEET #5

PROJECT NAME:	SPRINGFIELD	PLOT DATE:	30-DEC-2008
PROJECT NUMBER:	STP 0136(I)	DRAWN BY:	B. KIPPAN, PAPPAS
FILE NAME:	...02c084\...02c084_nul.dgn	CHECKED BY:	N. PAPPAS
DESIGNED BY:	B. KIPPAN, PAPPAS	IPARM FILE NAME:	02c084_lay_05
		SHEET	18 OF 68