

**TEMPORARY 4" YELLOW LINE, PAINT**  
 STA 63+00 TO STA 68+65, SOLID LT & RT  
 STA 68+86 RT, SOLID LT & RT  
 STA 69+07 TO STA 69+50, SOLID LT & RT

**TEMPORARY 24" STOP BAR, PAINT**  
 STA 68+97 RT CUTLER DRIVE

**TEMPORARY CROSSWALK MARKING, PAINT**  
 STA 68+84 RT CUTLER DRIVE

**4" YELLOW LINE**  
 STA 63+00 TO STA 68+65, SOLID LT & RT  
 STA 68+86 RT, SOLID LT & RT  
 STA 69+07 TO STA 69+50, SOLID LT & RT

**24" STOP BAR**  
 STA 68+97 RT CUTLER DRIVE

**CROSSWALK MARKING**  
 STA 68+84 RT CUTLER DRIVE

**REMOVING SIGNS**  
 STA 62+99 RT  
 STA 63+06 RT  
 STA 69+10 RT  
 STA 69+12 RT

**ERECTING SALVAGED SIGNS**  
 STA 63+00 RT  
 STA 69+15 RT

**REMOVAL AND DISPOSAL OF GUARDRAIL**  
 STA 63+04 TO STA 63+76 RT

**STEEL BEAM GUARDRAIL, GALVANIZED**  
 STA 63+05 TO STA 63+79 RT

**ANCHOR FOR STEEL BEAM RAIL**  
 STA 63+05 RT  
 STA 63+79 RT

**REHAB, DROP INLETS, CATCH BASINS, OR MANHOLES, CLASS III**  
 STA 65+04 RT

**DELINEATOR WITH STEEL POSTS**

STA 63+05 RT  
 STA 63+79 RT

~~**CAST IN PLACE CONCRETE CURB, TYPE B**~~  
~~STA 62+89 TO 65+58 RT~~  
~~STA 66+07 TO 66+75 RT~~  
~~STA 67+12 TO 67+87 RT~~  
~~STA 68+08 TO 68+63 RT~~  
~~STA 69+07 TO 70+15 RT~~

**BITUMINOUS CONCRETE SIDEWALK**  
 STA 63+00 TO 65+55 RT 62+96 TO 65+54  
 STA 66+10 TO 66+69 RT 66+07 TO 66+69  
 STA 67+18 TO 67+84 RT 67+18 TO 67+84  
 STA 68+11 TO 68+43 RT TO 68+54  
 STA 69+18 TO 70+21 RT 69+15 TO 70+19

**DETECTABLE WARNING SURFACE**  
 STA 62+95 RT  
 STA 68+45 RT  
 STA 69+20 RT

**VERTICLE GRANITE CURB**  
 STA 62+96 TO 65+54 RT  
 STA 66+09 TO 66+67 RT  
 STA 67+20 TO 67+81 RT  
 STA 68+10 TO 68+52 RT  
 STA 69+15 TO 70+15 RT

**CUTLER DRIVE**

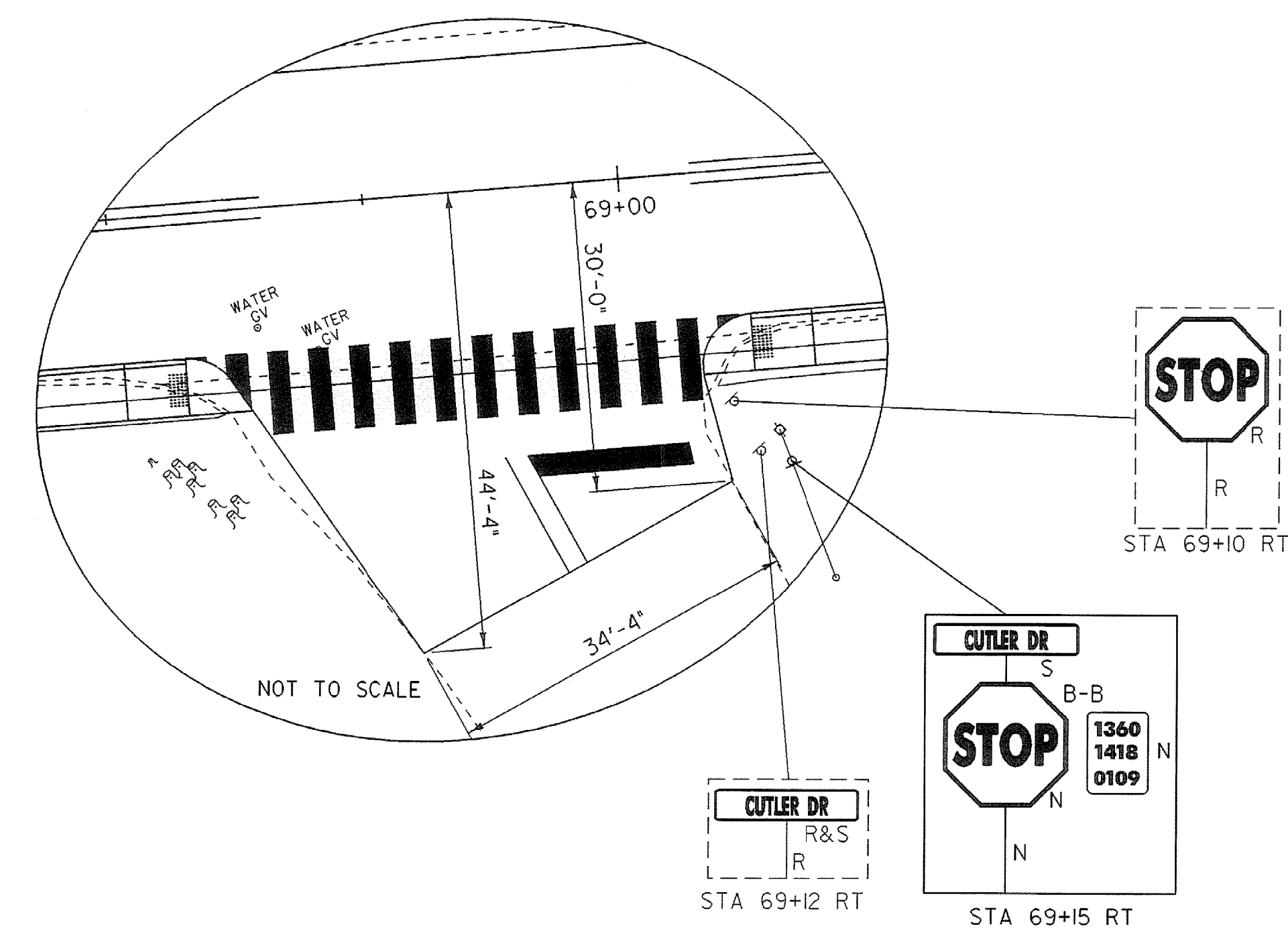

TOWN HIGHWAY 143  
 STA 63+00 = MM 1.00  
 BEGIN PROJECT STP 0136 (I)

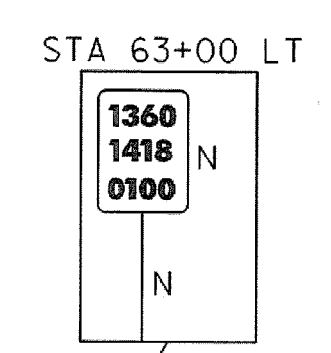

24" RCP W/ CRM HEADWALL AT INLET AND DI AT INLET TO REMAIN UNDISTURBED

BEGIN SHOULDER TRANSITION STA 63+00

DOUBLE 4" YELLOW CENTERLINE

12" PIPE (TYPE UNKNOWN) TO REMAIN UNDISTURBED

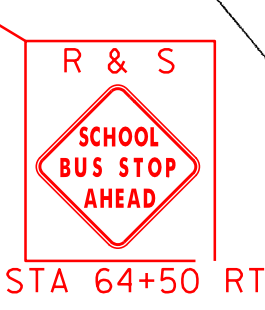
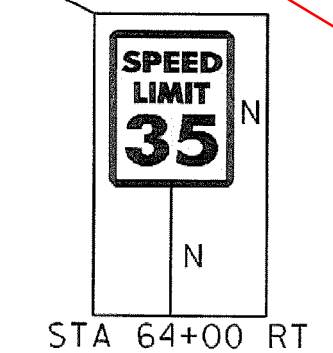
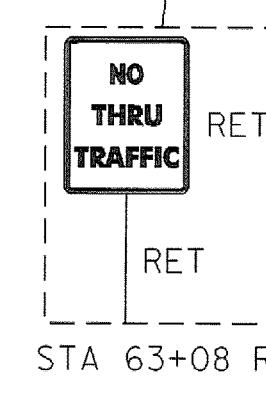
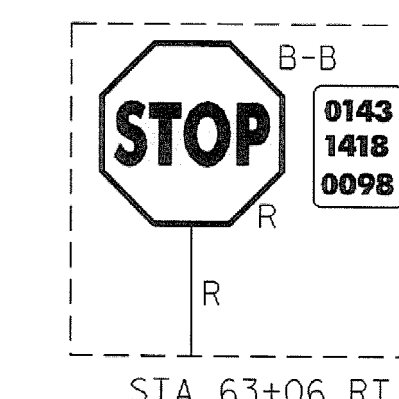
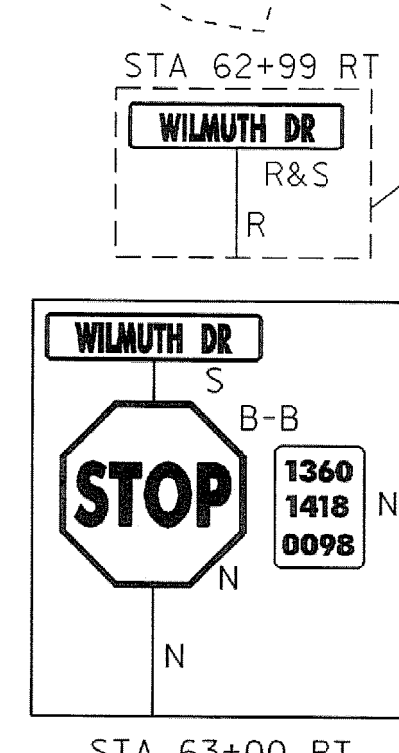
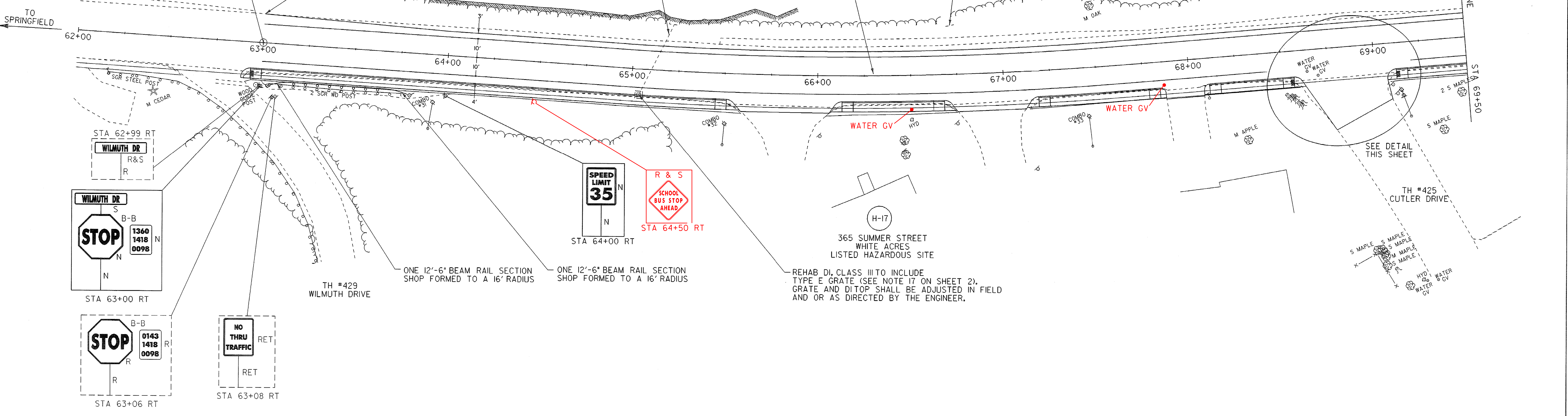

**LEGEND**

R	= REMOVE EXISTING
S	= SALVAGE
R&S	= REMOVE & SALVAGE
N	= NEW
RET	= RETAIN
B-B	= BACK TO BACK

- NOTES:**
- EXISTING SHOULDER MATERIAL ON TOWN HIGHWAYS SHALL BE EXCAVATED TO A DEPTH OF 3" OR AS DIRECTED BY THE RESIDENT ENGINEER. SEE GENERAL NOTE #6 SHEET 3 FOR MORE INFORMATION.
  - SEE SHEET 5 & 10 FOR REDUCED STEEL BEAM GUARDRAIL POST SPACING FOR CULVERT AND UTILITY POLE DETAILS.
  - WHITE LINES SHOWN ON PLANS IS FOR DISPLAY PURPOSES ONLY.

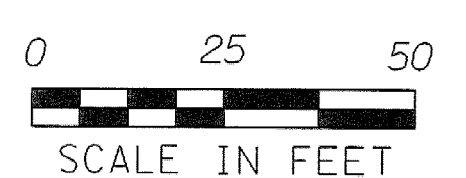

**LAYOUT SHEET #1**

PROJECT NAME:	SPRINGFIELD
PROJECT NUMBER:	STP 0136(I)
FILE NAME: ...02C084\...02C084_nul.dgn	PLOT DATE: 06-JAN-2009
PROJECT LEADER: K. UPMAL	DRAWN BY: B. KIPP\N. PAPPAS
DESIGNED BY: B. KIPP\N. PAPPAS	CHECKED BY: N. PAPPAS
IPARM FILE NAME: 02c084_lay_01	SHEET 14 OF 68