

* Ppc BH: A-23.43
 B-1.00
 C-1.00
 D-1.00
 E-1.00
 110.79 cm (6.6) + 2.35 = 113.14

* Ppc B-l-a = F-8.46
 G-1.00
 H-1.43
 119.08 15.5
 1.25
 10.36

Headwall @ 15+475.5 (L=4) 5.05m * 1.5 = 3m (approx) = 23.63 cm
 Pipe ST = (0.205m (ring) * 3.1m (width) * 1.1m (height) = 0.706 cm
 = (0.205m (ring) * 1.97m (width) * 1.0m (height) = 0.3926 cm
 Structure @ 15+475.5 RT=(D) 9T 1.6m * 2.1m (height) = 16.88 cm
 (E) of 1.1m * 0.5m (width) = 1.90 cm
 Ppc B-l-a=(F) 1.9m (width) * 2.7m (width) * 1.65m (height) = 8.46 cm
 (G) 1.9m (width) * 2.7m (width) * 0.7m (height) = 3.19 cm
 Headwall @ 15+475.5 (L=4) 4.5m (width) * 1.65m (height) * 1.65m (height) = 7.43 cm

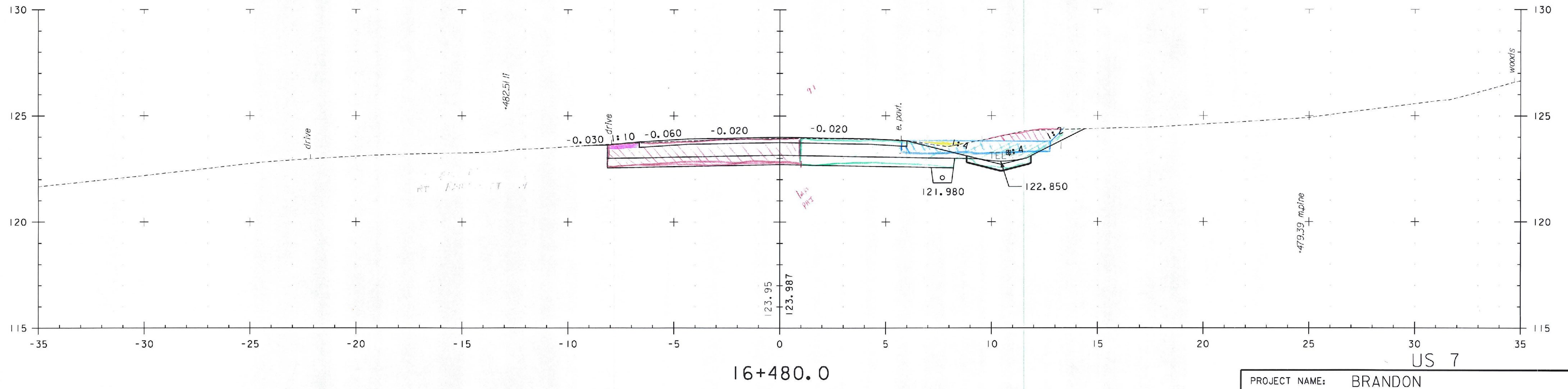
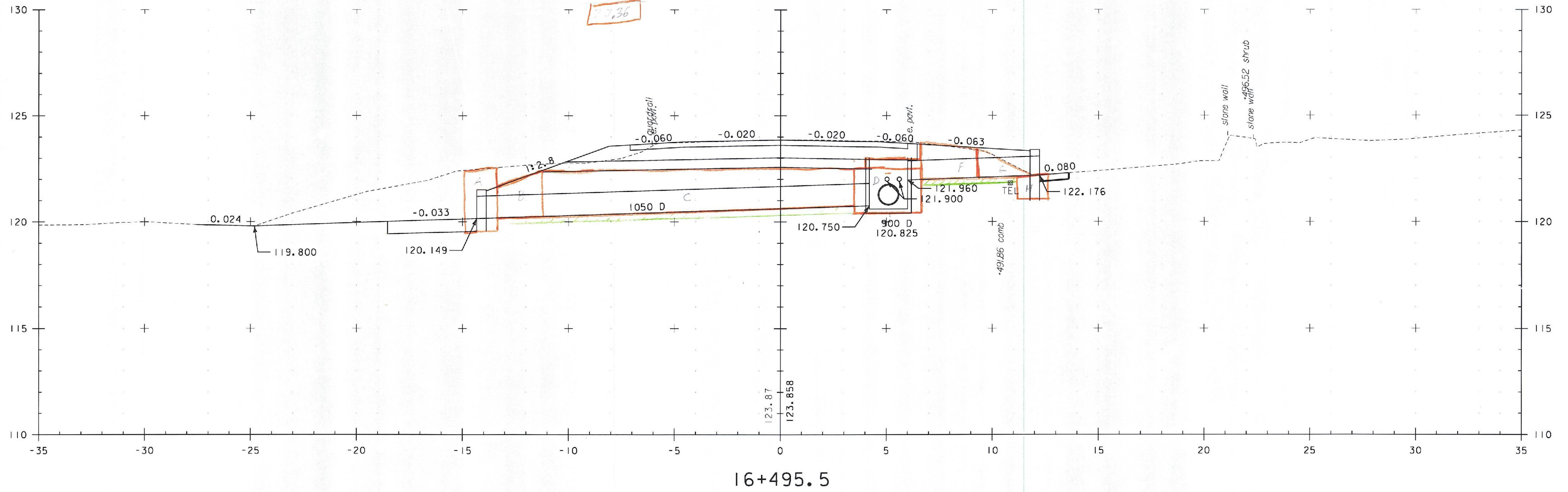

PROJECT NAME:	BRANDON	PLOT DATE:	9/
PROJECT NUMBER:	NH 019-3(495)	DRAWN BY:	NL
FILE NAME:	zb008s5-xs006.dgn	DESIGNED BY:	PTS
PROJECT LEADER:	CRB	CHECKED BY:	DA
CLD 02-0149		SHEET	387

