



TEMPORARY 100mm WHITE LINE, PAINT
 DURABLE 100mm WHITE LINE, THERMOPLASTIC
 STA 20+650 TO 20+820 SOLID LT & RT

TEMPORARY 100mm YELLOW LINE, PAINT
 DURABLE 100mm YELLOW LINE, THERMOPLASTIC
 STA 20+650 TO 20+820 SOLID LT & RT

REMOVING SIGNS
 AS SHOWN - 11

ERECTING SALVAGED SIGNS
 AS SHOWN - 2

STA 20+820.000 AHD
 END APPROACH

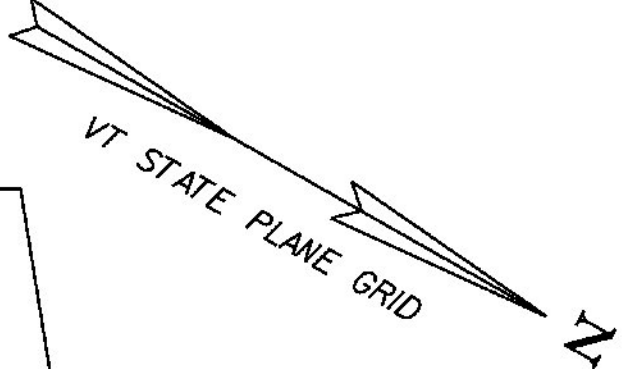

STA 20+777.617 BK
 END PROJECT
 NH 019-3(495)
 BEGIN APPROACH

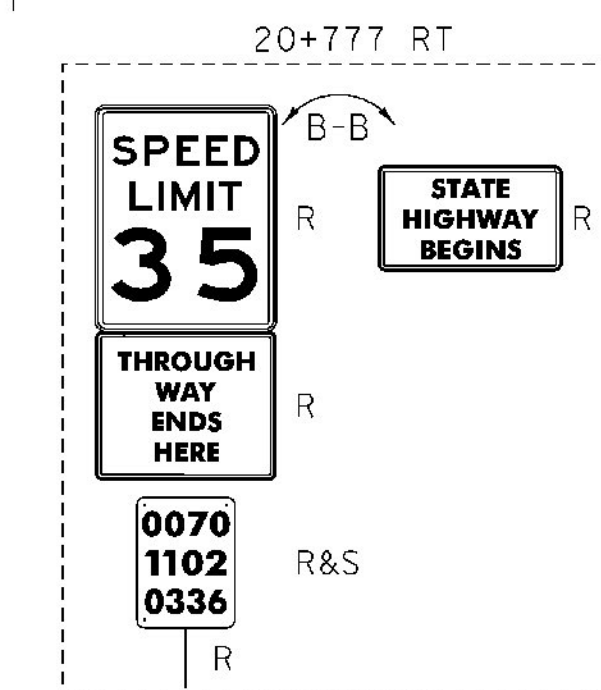
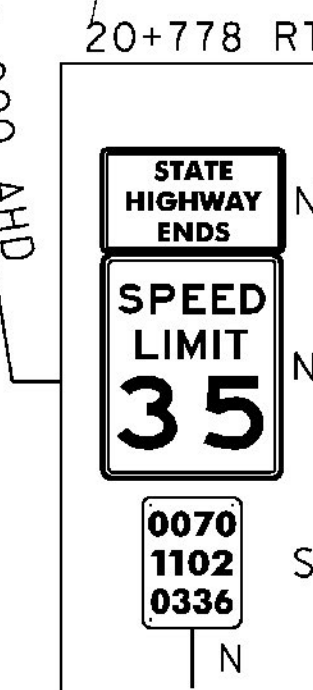
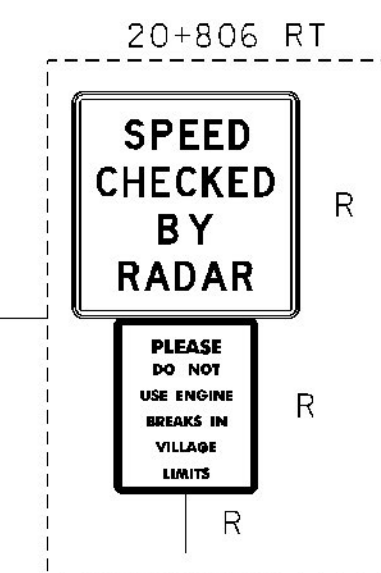
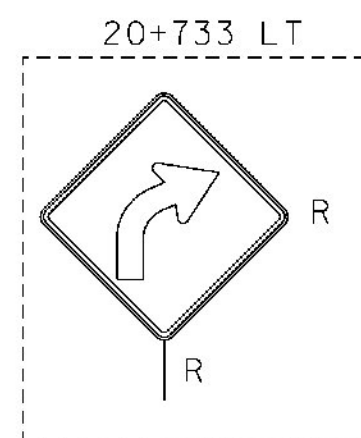
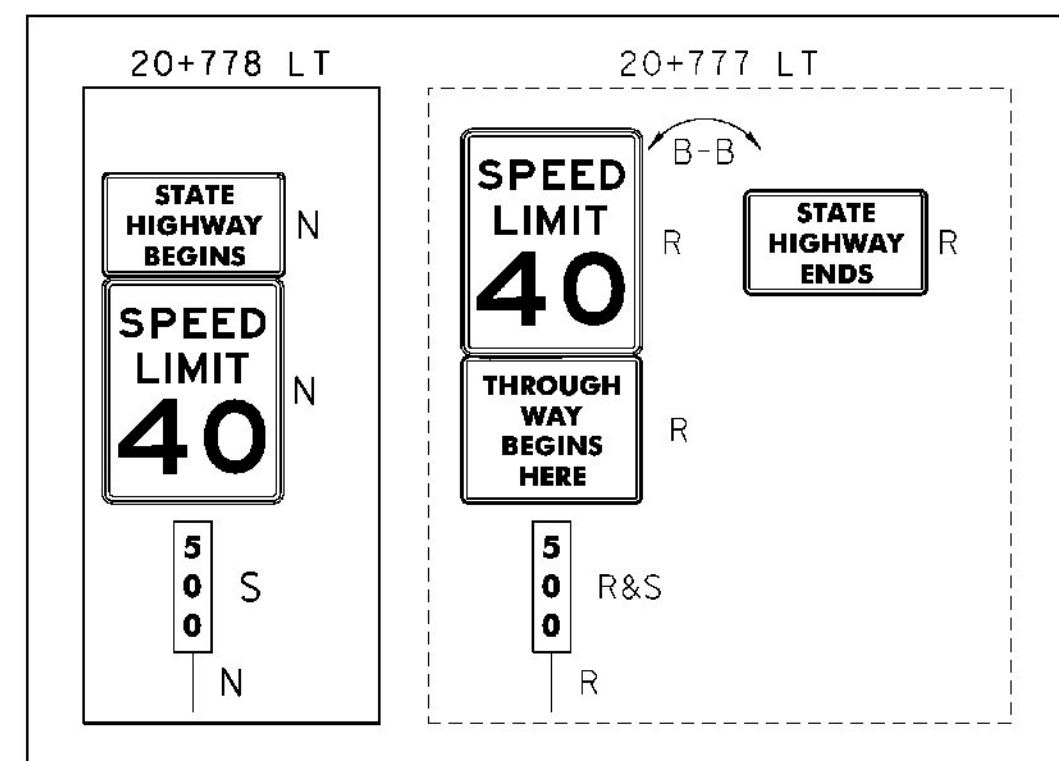

MATCH LINE STA 20+650

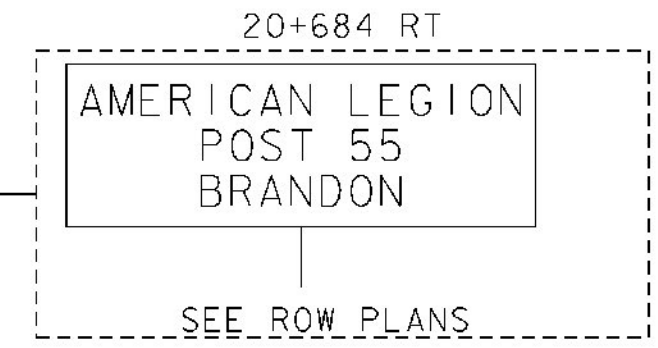
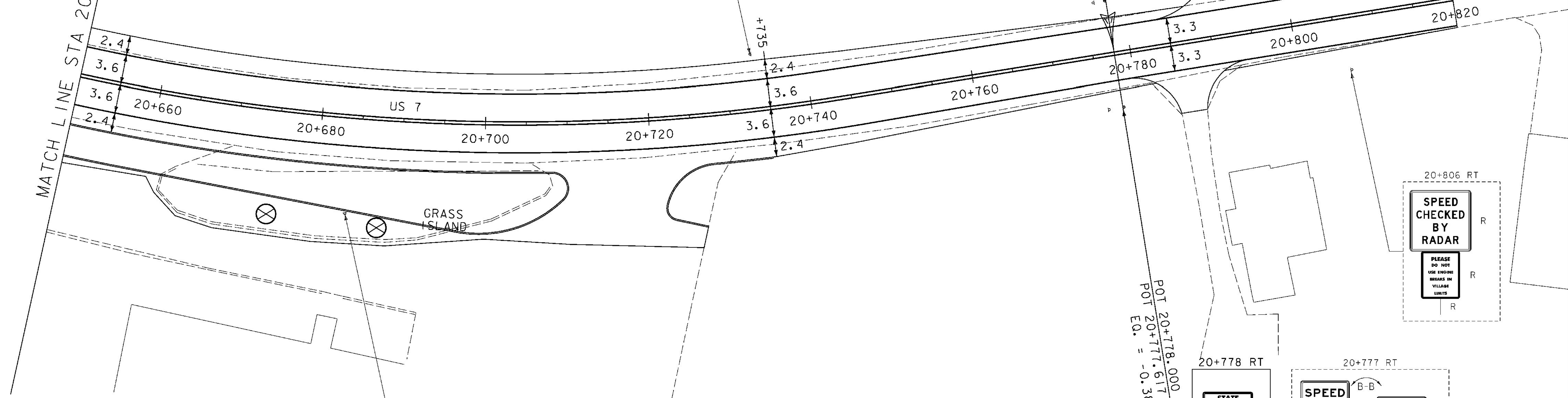

POT 20+778.000 AHD
 POT 20+777.617 BK =
 EQ. = -0.383 m

SIGN LEGEND

- R = REMOVE
- S = SALVAGE
- N = NEW
- RET = RETAIN
- T&T = THINNING & TRIMMING
- B-B = BACK TO BACK
- EXISTING =
- NEW =



SIGNING & PAVEMENT MARKING 28

PROJECT NAME: BRANDON	PLOT DATE: 9/3/2009
PROJECT NUMBER: NH 019-3(495)	DRAWN BY: HJC
FILE NAME: zb008s5-+s28.dgn	CHECKED BY: PTS
PROJECT LEADER: CRB	SHEET 269 OF 546
DESIGNED BY: NLL	
CLD 02-0149	