

STONE FILL, TYPE II (IN DITCHES)
 GEOTEXTILE UNDER STONE FILL
 STA 20+190 - 20+260 RT
 STA 20+315 - 20+340 RT

STONE FILL, TYPE I (IN DITCHES)
 GEOTEXTILE UNDER STONE FILL
 STA 20+340 - 20+350 RT

TEMPORARY STONE CHECK DAM, TYPE I
 STA 20+190 - 20+260 LT

INLET PROTECTION DEVICE, TYPE I
 STA 20+280 LT
 STA 20+347 LT

TEMPORARY EROSION MATTING (IN DITCHES)
 STA 20+190 - 20+260 LT
 STA 20+260 - 20+315 RT

TEMPORARY EROSION MATTING (ON SLOPES)
 STA 20+260 - 20+330 RT (BACK SLOPE)

PROJECT DEMARCATIION FENCE
 STA 20+190 - 20+240 LT
 STA 20+190 - 20+350 RT

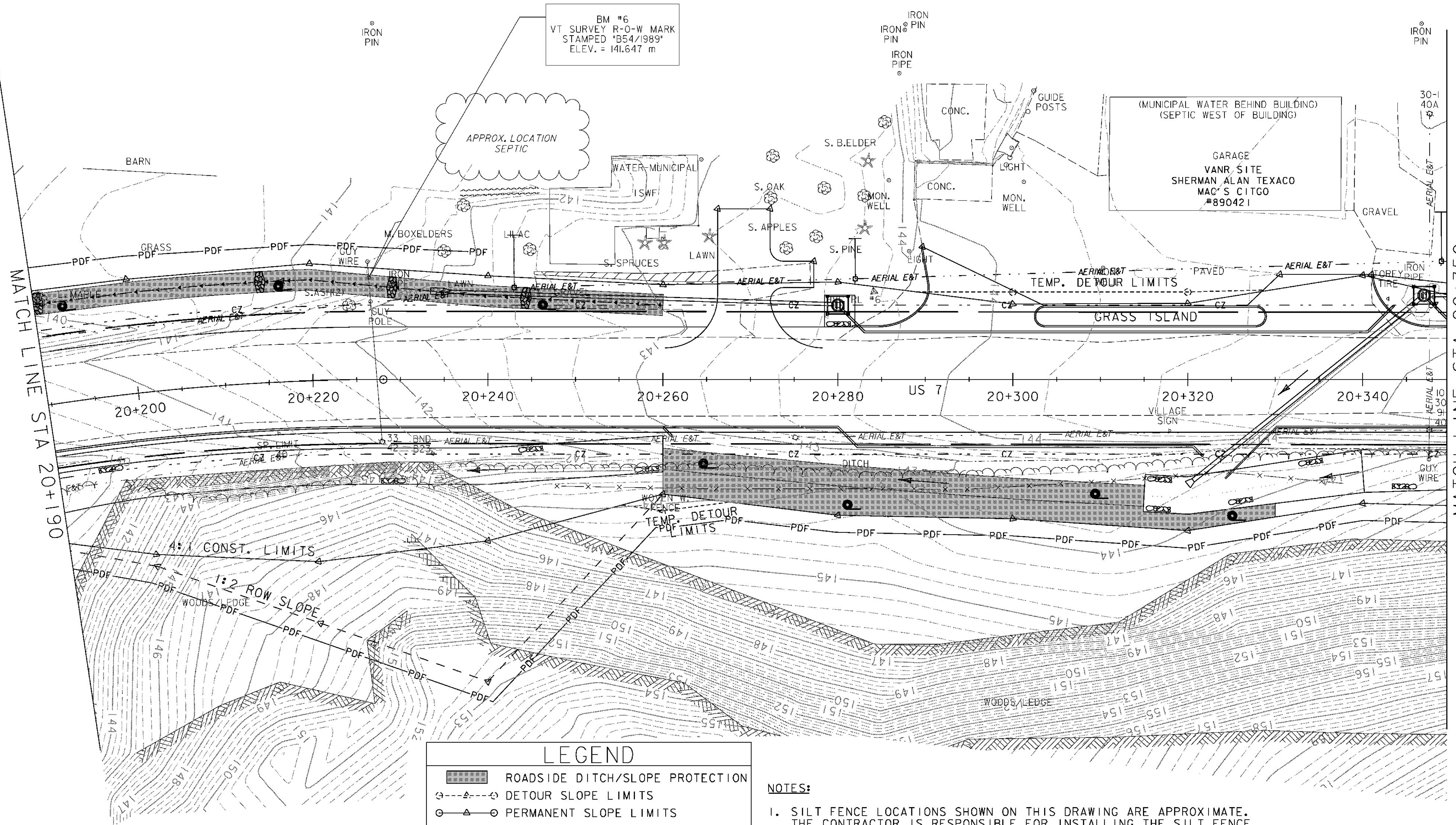
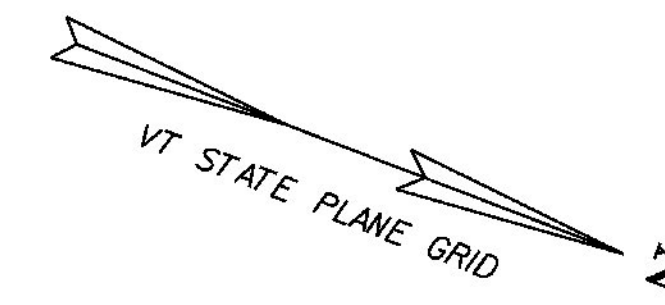

LEGEND

- ROADSIDE DITCH/SLOPE PROTECTION
- DETOUR SLOPE LIMITS
- PERMANENT SLOPE LIMITS
- SILT FENCE
- INLET PROTECTION DEVICE, TYPE I
- PIPE INLET PROTECTION
- EROSION MATTING
- CHECK DAM - TEMPORARY
- BARRIER FENCE
- PROJECT DEMARCATIION FENCE
- FILTER CURTAIN

NOTES:

1. SILT FENCE LOCATIONS SHOWN ON THIS DRAWING ARE APPROXIMATE. THE CONTRACTOR IS RESPONSIBLE FOR INSTALLING THE SILT FENCE IN ACCORDANCE WITH THE GUIDELINES SET FORTH IN THE VERMONT GENERAL PERMIT FOR STORMWATER RUNOFF FROM CONSTRUCTION SITES. THE RESIDENT ENGINEER AND ON SITE COORDINATOR SHALL APPROVE ALL SILT FENCE LOCATIONS PRIOR TO PLACEMENT.
2. FOR EROSION PREVENTION AND SEDIMENT CONTROL PLAN GENERAL NOTES, SEE SHEETS 147 - 148, AND DETAILS, SEE SHEETS 177

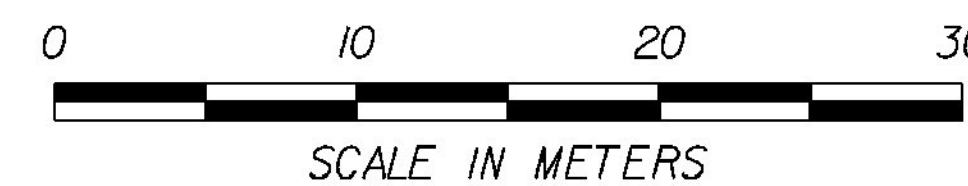

EROSION CONTROL PLAN 25

PROJECT NAME:	BRANDON	PLOT DATE:	9/3/2009
PROJECT NUMBER:	NH 019-3(495)	DRAWN BY:	NLL
FILE NAME:	zb008s5-ec25.dgn	CHECKED BY:	PTS
PROJECT LEADER:	CRB	SHEET	173 OF 546
DESIGNED BY:	NLL		
CLD 02-0149			