

INLET PROTECTION DEVICE, TYPE I
 STA 17+520 RT
 STA 17+520 LT
 STA 1+015 LT
 STA 1+015 RT

TEMPORARY EROSION MATTING (IN DITCHES)
 STA 17+490 - 17+515 LT
GEOTEXTILE FOR SILT FENCE
 STA 17+632 - 17+650 RT
 STA 1+044 - 1+067 RT

PROJECT DEMARCATION FENCE
 STA 17+490 - 17+498 LT
 STA 17+490 - 17+540 RT
 STA 17+590 - 17+650 LT
 STA 17+638 - 17+650 RT
 STA 1+014 - 1+035 RT
 STA 1+044 - 1+068 RT

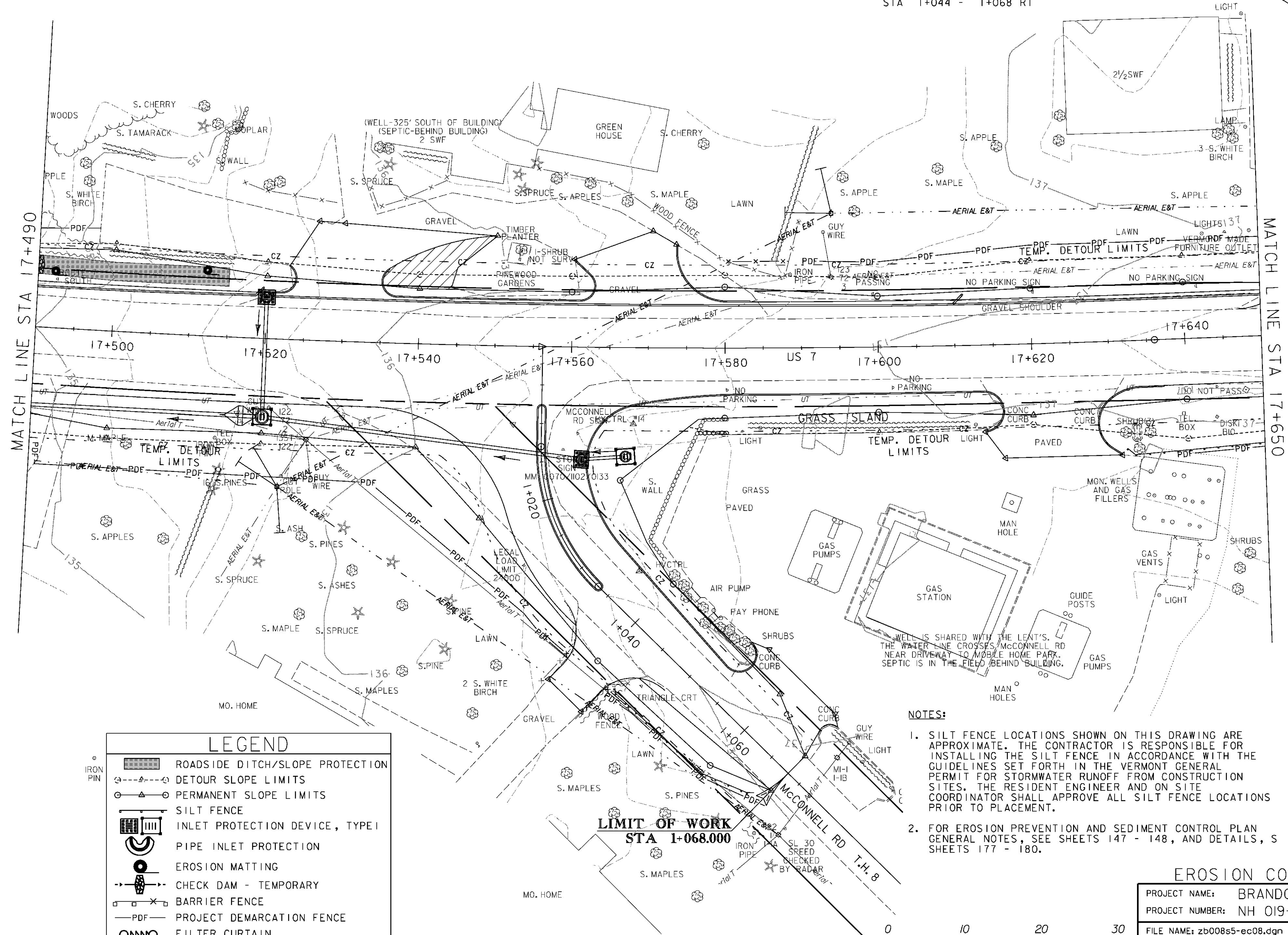
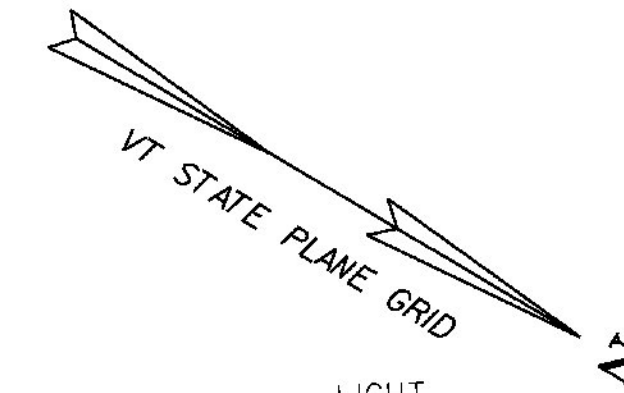

LEGEND	
	ROADSIDE DITCH/SLOPE PROTECTION
	DETOUR SLOPE LIMITS
	PERMANENT SLOPE LIMITS
	SILT FENCE
	INLET PROTECTION DEVICE, TYPE I
	PIPE INLET PROTECTION
	EROSION MATTING
	CHECK DAM - TEMPORARY
	BARRIER FENCE
	PROJECT DEMARCATION FENCE
	FILTER CURTAIN

- NOTES:**
1. SILT FENCE LOCATIONS SHOWN ON THIS DRAWING ARE APPROXIMATE. THE CONTRACTOR IS RESPONSIBLE FOR INSTALLING THE SILT FENCE IN ACCORDANCE WITH THE GUIDELINES SET FORTH IN THE VERMONT GENERAL PERMIT FOR STORMWATER RUNOFF FROM CONSTRUCTION SITES. THE RESIDENT ENGINEER AND ON SITE COORDINATOR SHALL APPROVE ALL SILT FENCE LOCATIONS PRIOR TO PLACEMENT.
 2. FOR EROSION PREVENTION AND SEDIMENT CONTROL PLAN GENERAL NOTES, SEE SHEETS 147 - 148, AND DETAILS, S SHEETS 177 - 180.

LIMIT OF WORK
 STA 1+068.000



EROSION CONTROL PLAN 8	
PROJECT NAME:	BRANDON
PROJECT NUMBER:	NH 019-3(495)
FILE NAME:	zb008s5-ec08.dgn
PROJECT LEADER:	CRB
DESIGNED BY:	NLL
CLD 02-0149	
PLOT DATE:	9/3/2009
DRAWN BY:	NLL
CHECKED BY:	PTS
	SHEET 156 OF 546