

US 7 CURVE #8
 $\Delta = 2^\circ 30' 24.5''$ LT
 $R = 2500.000$
 $T = 54.699$
 $L = 109.380$
 $E = 0.598$
 BANK = NC

CONSTRUCT DRIVES
 STA 19+809.0 LT - 9.6 m WIDE, GRAVEL-COM.
 STA 19+826.9 RT - 3.3 m WIDE, GRAVEL-RES.

REMOVAL OF EXISTING FENCE
 STA 19+788.5 - 19+789.1 LT
 STA 19+802.0 - 19+804.0 LT (NOT SURV.)

REMOVAL AND DISPOSAL OF GUARDRAIL
 STA 19+700.0 - 19+769.6 LT
 STA 19+700.0 - 19+790.4 RT

STEEL BEAM GUARDRAIL, GALVANIZED
 STA 19+700.0 - 19+797.8 RT
 STA 19+730.0 - 19+760.0 LT
 STA 19+760.0 - 19+798.0 LT
 (11:1 TAPER) (BURY IN BACKSLOPE)

STEEL BEAM GUARDRAIL, GALVANIZED W/2.4m POSTS
 STA 19+700.0 - 19+730.0 RT

ANCHOR FOR STEEL BEAM RAIL
 STA 19+798.0 LT

MANUFACTURED TERMINAL SECTION, FLARED
 STA 19+797.8 RT

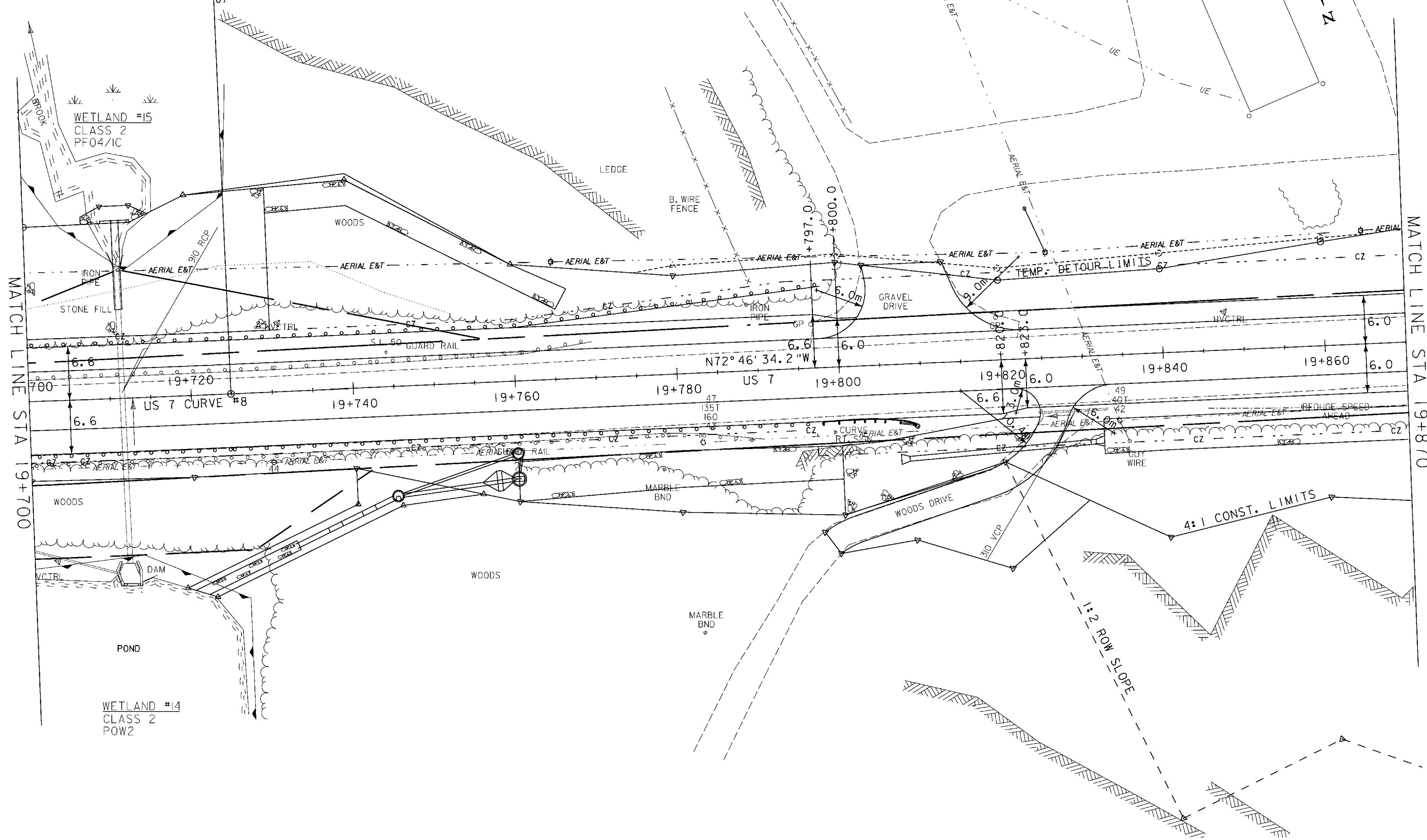

MATCH LINE STA 19+700

MATCH LINE STA 19+870

⊗ DENOTES TREE OR STUMP REMOVAL



ROADWAY LAYOUT 22

PROJECT NAME:	BRANDON	PLOT DATE:	9/3/2009
PROJECT NUMBER:	NH 019-3(495)	DRAWN BY:	NLL
FILE NAME:	zb008s5-gen22.dgn	CHECKED BY:	PTS
PROJECT LEADER:	CRB	CLD 02-0149	SHEET 110 OF 546
DESIGNED BY:	DAM		