

CONSTRUCT DRIVES

STA 18+778.6 LT - 7.2 m WIDE, GRAVEL-RES.
 STA 18+848.6 LT - 7.2 m WIDE, GRAVEL-RES.
 STA 18+895.5 LT - 3.6 m WIDE, GRAVEL-RES.

**COLD PLANING, BITUMINOUS CONCRETE PAVEMENT
 (TYPE 111S) (1-45 mm LIFT)**

STA 18+856.0 - 18+910.0

**SPECIAL PROVISION (PRECAST
 CONCRETE GEOGRID RETAINING WALL)**

STA 18+750.0 - 18+770.0 RT

RELOCATE MAILBOX, SINGLE SUPPORT

STA 18+785.5 LT
 STA 18+896.9 RT

REMOVING AND RESETTNG FENCE

STA 18+768.6 - 18+774.5 LT
 STA 18+782.5 - 18+802.9 LT

BITUMINOUS CONCRETE CURB, TYPE A

STA 18+750.0 - 18+775.0 RT

REMOVAL AND DISPOSAL OF GUARDRAIL

STA 18+862.6 - 18+910.0 RT
 STA 18+899.5 - 18+910.0 LT

STEEL BEAM GUARDRAIL, GALVANIZED

STA 18+780.0 - 18+910.0 RT

MANUFACTURED TERMINAL SECTION, TANGENT

STA 18+910.0 LT (CONNECT
 TO EXISTING AT STA 18+910 LT)

STEEL BEAM GUARDRAIL, GALVANIZED/NESTED W/2.4m POSTS

STA 18+750.0 - 18+780.0 RT (SEE PRECAST CONCRETE
 GEOGRID RETAINING WALL DETAIL SHEET 4)

IRON
 PIPE

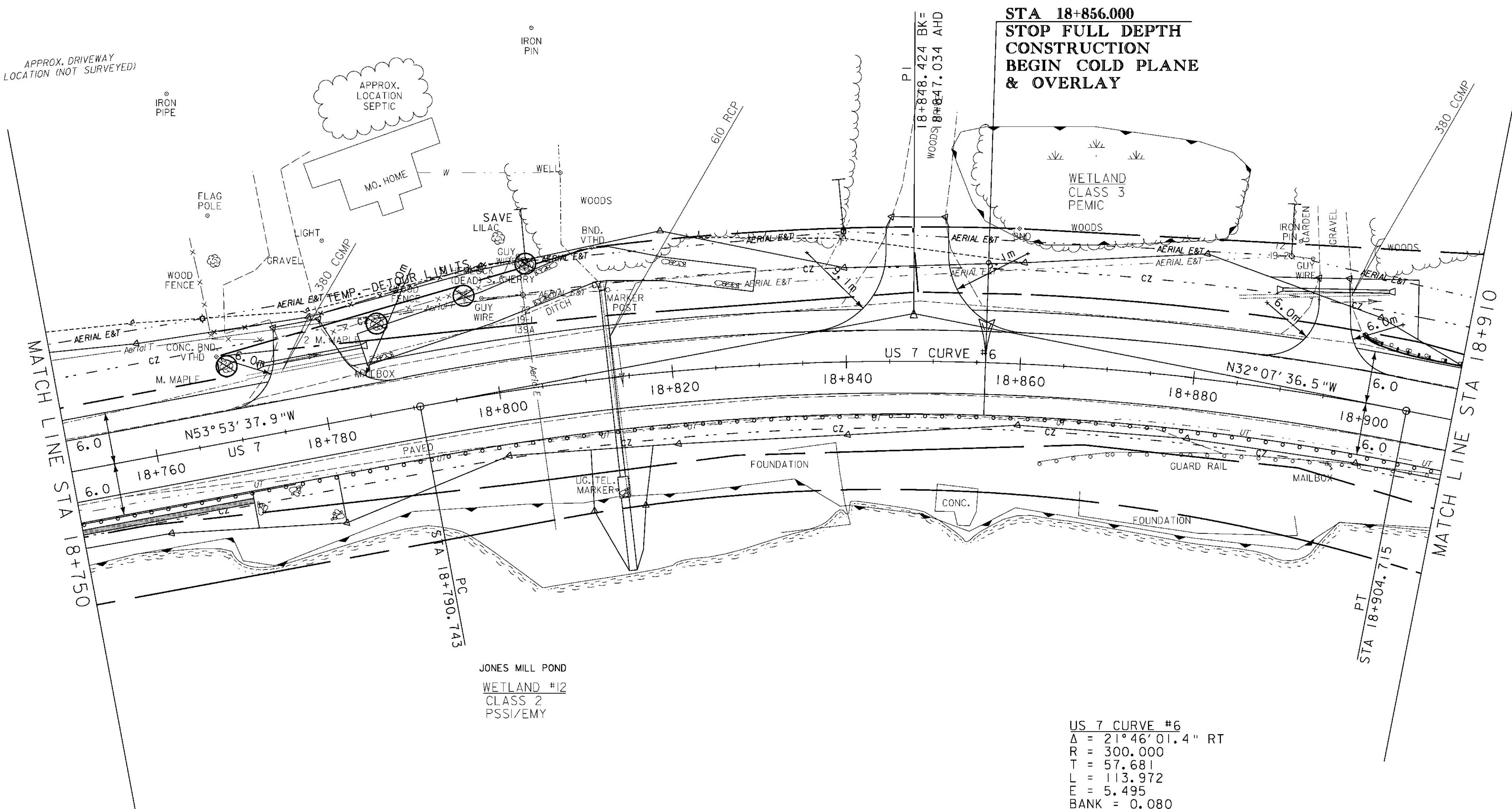
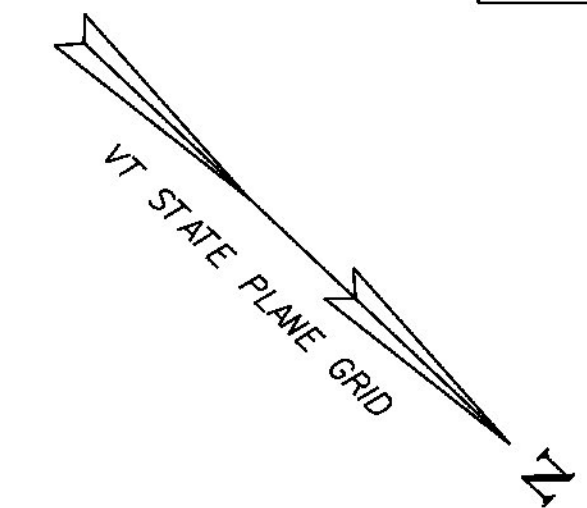

**STA 18+856.000
 STOP FULL DEPTH
 CONSTRUCTION
 BEGIN COLD PLANE
 & OVERLAY**

US 7 CURVE #6
 $\Delta = 21^\circ 46' 01.4''$ RT
 R = 300.000
 T = 57.681
 L = 113.972
 E = 5.495
 BANK = 0.080

JONES MILL POND
 WETLAND #12
 CLASS 2
 PSSI/EMY

⊗ DENOTES TREE OR STUMP REMOVAL



ROADWAY LAYOUT 16

PROJECT NAME:	BRANDON	PLOT DATE:	9/3/2009
PROJECT NUMBER:	NH 019-3(495)	DRAWN BY:	NLL
FILE NAME:	zb008s5-genl6.dgn	CHECKED BY:	PTS
PROJECT LEADER:	CRB	CLD 02-0149	SHEET 98 OF 546
DESIGNED BY:	DAM		