

**CONSTRUCT DRIVES**

STA 17+868.0 RT - 3.9 m WIDE, PAVED-RES.  
 STA 17+905.0 RT - 4.9 m WIDE, PAVED-RES.  
 STA 17+943.0 RT - 3.6 m WIDE, PAVED-RES.  
 SPECIAL PROVISION (REMOVING AND RESETTING  
 GROUND /ORNAMENTAL LIGHT)  
 STA 17+866.5 LT  
 STA 17+869.5 LT

**RELOCATE MAILBOX, SINGLE SUPPORT**

STA 17+873.0 RT  
 STA 17+911.3 RT  
 STA 17+946.1 RT  
 SPECIAL PROVISION (REMOVE  
 AND RESET COMMERCIAL SIGN)  
 STA 17+868.0 LT

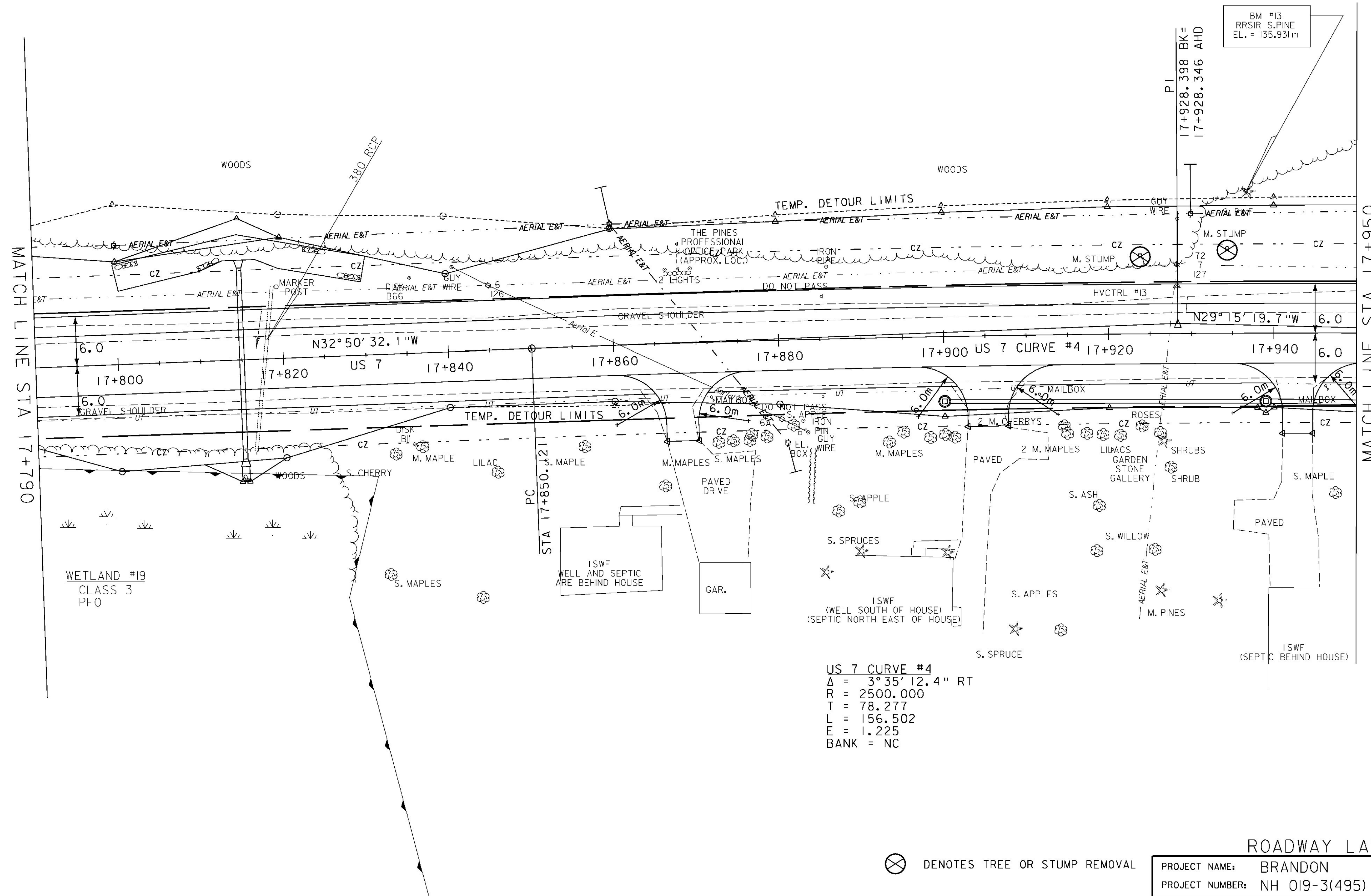
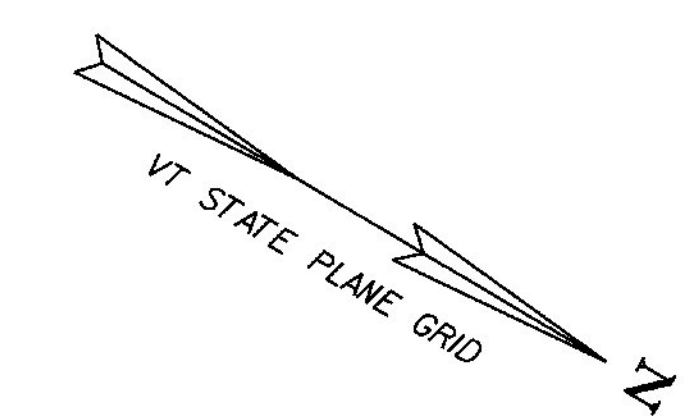

MATCH LINE STA 17+790

MATCH LINE STA 17+950

⊗ DENOTES TREE OR STUMP REMOVAL



**ROADWAY LAYOUT 10**

PROJECT NAME:	BRANDON	PLOT DATE:	9/3/2009
PROJECT NUMBER:	NH 019-3(495)	DRAWN BY:	NLL
FILE NAME:	zb008s5-genl0.dgn	CHECKED BY:	PTS
PROJECT LEADER:	CRB	CLD 02-0149	SHEET 86 OF 546