

CONSTRUCT DRIVES

STA 16+430.0 RT - 5.5 m WIDE, PAVED-RES.
 STA 16+475.0 LT - 5.4 m WIDE, PAVED-COMM.
 STA 16+502.8 RT - 3.6 m WIDE, PAVED-RES.

REMOVING AND RESETTING LIGHT POLE

~~STA 16+482.5 LT (WORK DONE BY SCHOOL)~~
~~STA 16+513.7 LT~~

SPECIAL PROVISION (REMOVING AND RESETTING GROUND/ORNAMENTAL LIGHT ASSEMBLY)

~~STA 16+440.2 RT (LIGHTS NOT THERE)~~
~~STA 16+445.6 RT~~

RELOCATE MAILBOX, SINGLE SUPPORT

STA 16+499.1 RT

RELOCATE MAILBOX, MULTIPLE SUPPORT

STA 16+421.0 RT

REMOVAL AND DISPOSAL OF GUARDRAIL

STA 16+482.9 - 16+530.0 LT

STEEL BEAM GUARDRAIL, GALVANIZED

STA 16+495.0 - 16+520.0 LT

CHAIN-LINK FENCE, 1.8M BRACING ASSEMBLY FOR CHAIN-LINK FENCE
 GEOTEXTILE FOR SILT FENCE
 STA 16+506 - 16+530 RT

TEMPORARY TRAFFIC BARRIER (CMB)

STA 16+506 - 16+530 RT (PER NECESSITY STIPULATION)

STEEL BEAM GUARDRAIL, GALVANIZED W/2.4m POSTS

STA 16+520.0 - 16+530.0 LT

MANUFACTURED TERMINAL SECTION, TANGENT

STA 16+495.0 LT

STA 16+460.000 AHD
END APPROACH
BEGIN PROJECT
NH 019-3(495)

STA 16+418.474 BK
BEGIN APPROACH

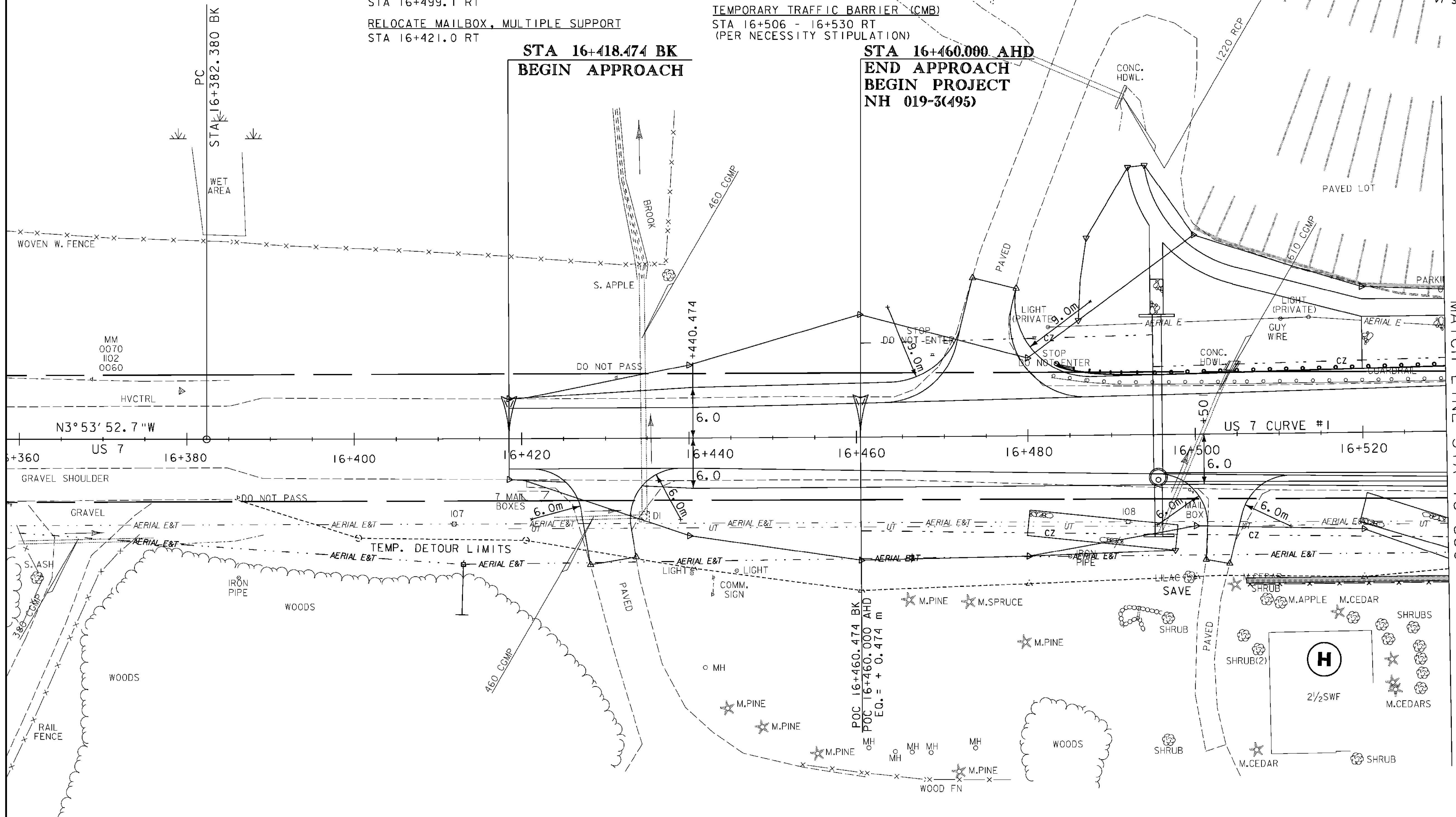

ROADWAY LAYOUT I

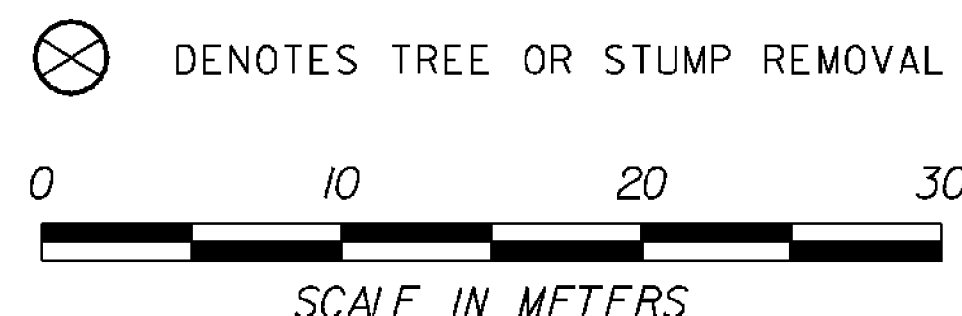

PROJECT NAME:	BRANDON	FILE NAME:	zb008s5-gen01.dgn	PLOT DATE:	9/3/2009
PROJECT NUMBER:	NH 019-3(495)	PROJECT LEADER:	CRB	DRAWN BY:	NLL
		DESIGNED BY:	DAM	CHECKED BY:	PTS
		CLD 02-0149		SHEET	68 OF 546