

CONSTRUCT DRIVES
 STA 16+730.0 RT - 6.8 m WIDE, PAVED-COMM.
 STA 16+775.0 LT - 7.2 m WIDE, PAVED-COMM.

REMOVAL AND DISPOSAL OF GUARDRAIL
 STA 16+749.4 - 16+764.7 LT
 STA 16+783.6 - 16+807.0 LT

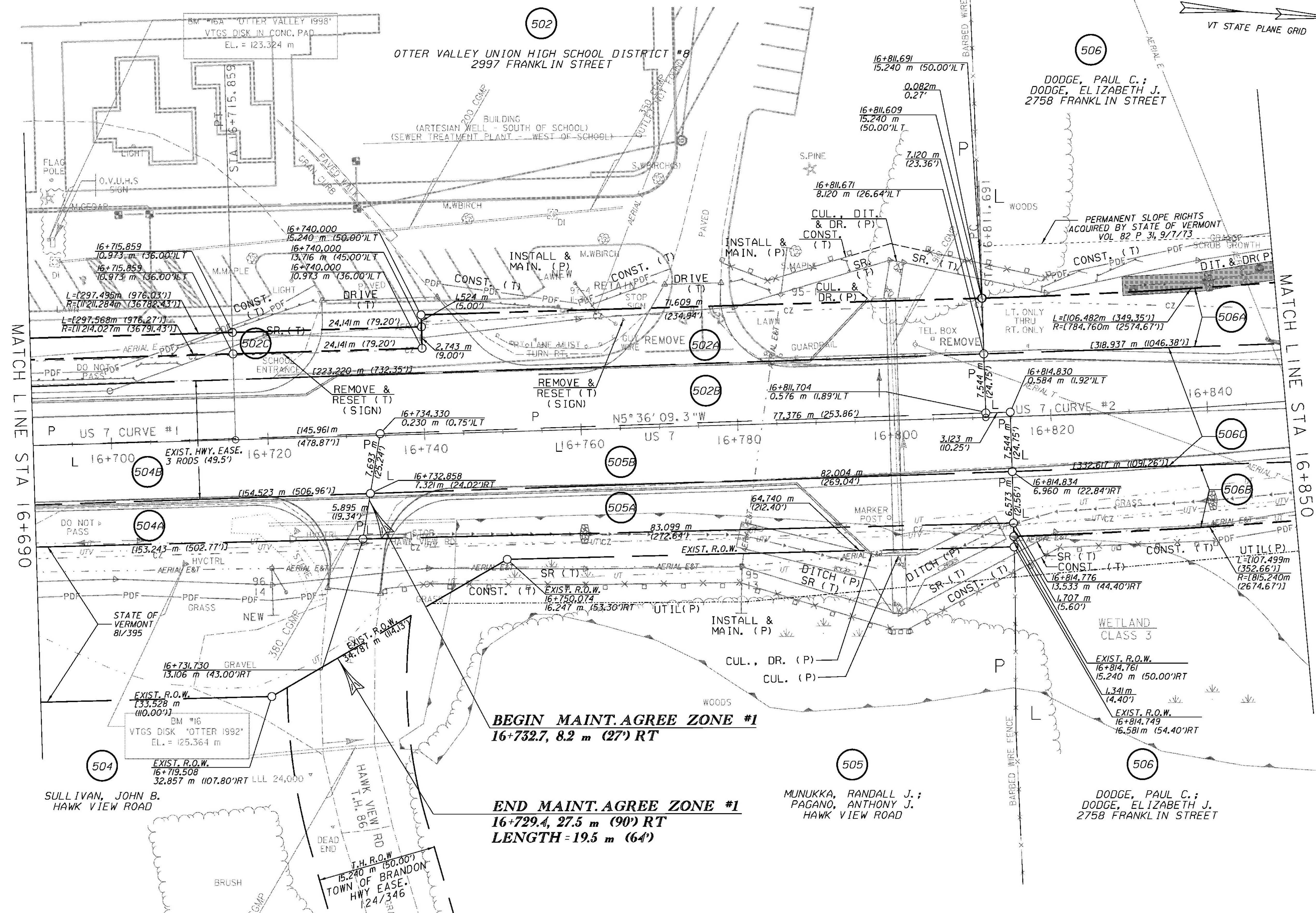

LINES SHOWN ON THIS PLAN AS EXISTING PROPERTY LINES (P/L) ARE BELIEVED TO BE ACCURATE BUT SHOULD NOT BE RELIED UPON FOR PURPOSES UNRELATED TO THE STATE OF VERMONT ACQUISITION OF LAND AND RIGHTS FOR THIS PROJECT

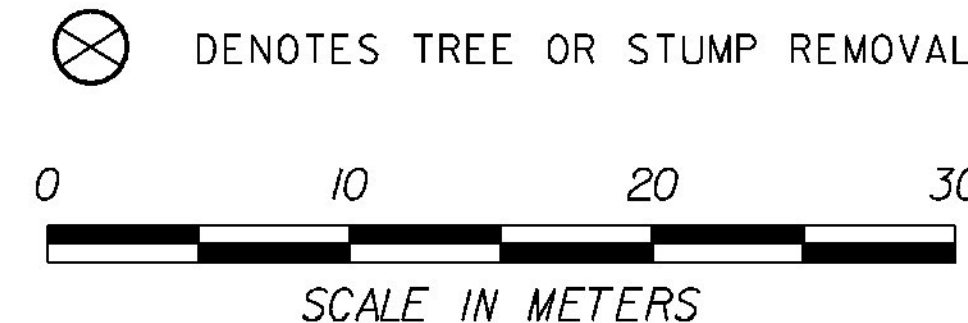

RIGHT-OF-WAY LAYOUT 3	
PROJECT NAME:	BRANDON
PROJECT NUMBER:	NH 019-3(495)
FILE NAME:	z000855-ROW03.dgn
PROJECT LEADER:	CRB
DESIGNED BY:	PTS
ROW SHEET 23 OF 164	PLOT DATE: 9/3/2009
	DRAWN BY: JCS
	CHECKED BY: PTS
	SHEET 38 OF 546