

**STA 20+820.000 AHD
END APPROACH**

**STA 20+777.617 BK
END PROJECT
NH 019-3(495)
BEGIN APPROACH**

STA 20+822 LT
END TEMPORARY
WIDENING FOR
PHASE II TRAFFIC

STA 20+778 - 20+820
ALTERNATING ONE-WAY
TRAFFIC REQUIRED TO
CONSTRUCT APPROACH

STA 20+777.6 - LT
END PHASE I CONSTRUCTION

BEGIN CLASS I TOWN HIGHWAY
END STATE HIGHWAY

STA 20+780.0 LT
TEMPORARILY COVER NEW CB

STA 20+730 LT
TEMPORARILY COVER NEW CB

1:1 CONST. LIMITS

TEMP. DETOUR LIMITS

MATCH LINE STA 20+650

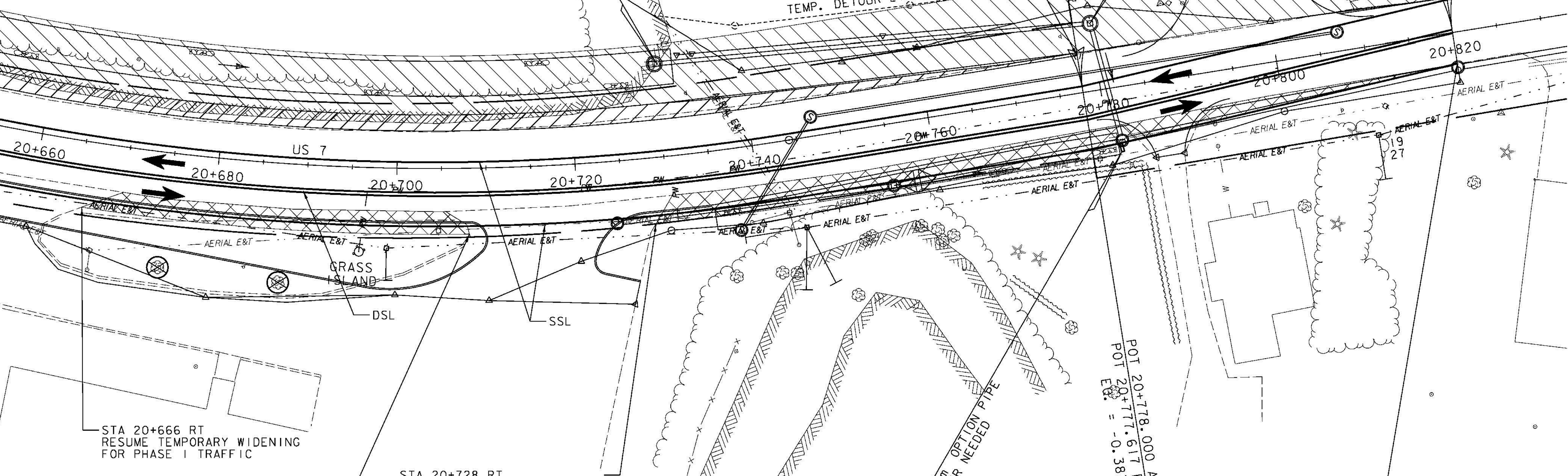

STA 20+666 RT
RESUME TEMPORARY WIDENING
FOR PHASE I TRAFFIC

STA 20+708 RT
STOP TEMPORARY WIDENING
FOR PHASE I TRAFFIC

STA 20+728 RT
RESUME TEMPORARY WIDENING
FOR PHASE I TRAFFIC

POT 20+778.000 AHD
POT 20+777.617 BK =
-0.383 m

STA 20+820 RT
END TEMPORARY WIDENING
FOR PHASE I TRAFFIC

LEGEND	
	PHASE I CONSTRUCTION
	TEMPORARY WIDENING FOR PHASE I TRAFFIC
	TEMPORARY WIDENING FOR PHASE II TRAFFIC
	PHASE I TRAFFIC
	SSL SINGLE SOLID WHITE LINE 100mm WIDE (PAINT)
	DSL DOUBLE SOLID YELLOW LINE 100mm WIDE (PAINT)

STA 20+781.0 RT
TEMP. 37.5 mm X 1.5 m OPTION NEEDED
REMOVE WHEN NO LONGER NEEDED



**PHASE I
TRAFFIC CONTROL PLAN 28**

PROJECT NAME: BRANDON	PLOT DATE: 9/3/2009
PROJECT NUMBER: NH 019-3(495)	DRAWN BY: NLL
FILE NAME: zb008s5+tcp28.dgn	CHECKED BY: KLS
PROJECT LEADER: CRB	SHEET 309 OF 546
DESIGNED BY: PTS	
CLD 02-0149	