

STA 18+840
STOP PHASED CONSTRUCTION
WITH TWO-WAY TRAFFIC

STA 18+840 - 18+940
ALTERNATING ONE-WAY TRAFFIC

STA 18+856.000
STOP FULL DEPTH
CONSTRUCTION
BEGIN COLD PLANE
& OVERLAY

STA 18+910 LT
STOP TEMPORARY WIDENING
FOR PHASE I TRAFFIC

APPROX.
LOCATION
SEPTIC

STA 18+772.1 LT TO 18+786.6 LLT
TEMP. 375 mm x 15 m OPTION PIPE
REMOVE WHEN NO LONGER NEEDED

STA 18+813.0 LLT TO 18+813.0 LLT
TEMP. 600 mm x 5 m PCCSP (1.65) OR CAMP (1.52)
REMOVE WHEN NO LONGER NEEDED



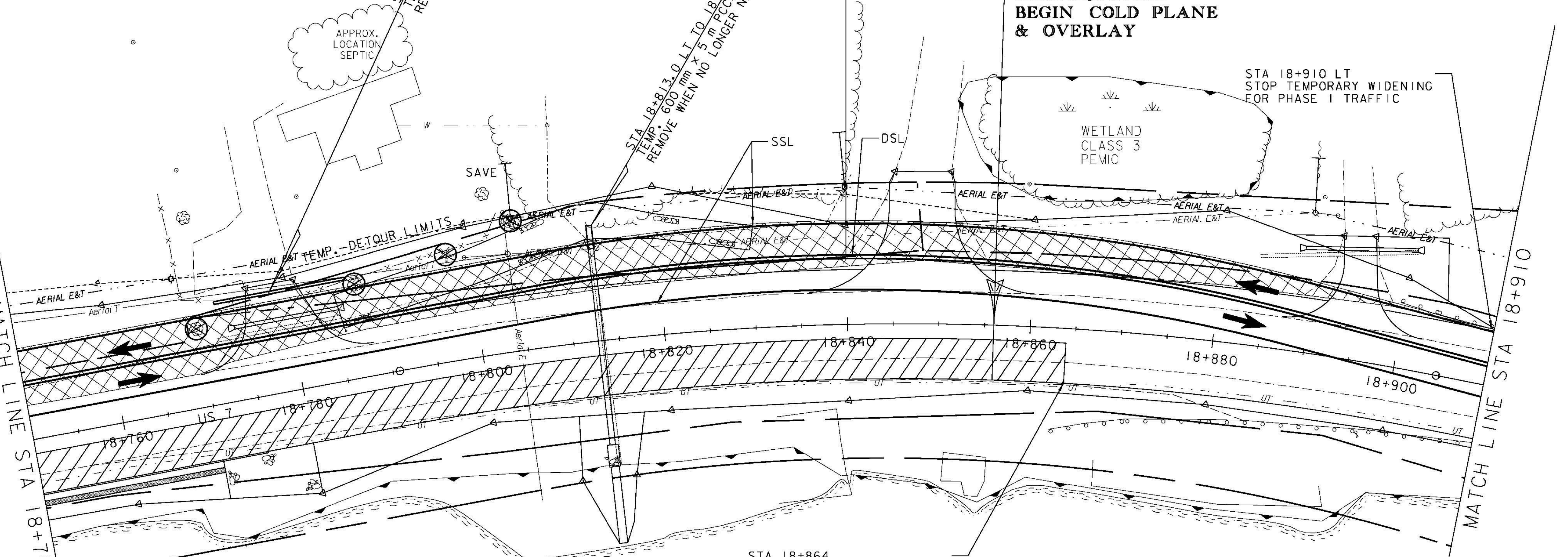

MATCH LINE STA 18+750

MATCH LINE STA 18+910

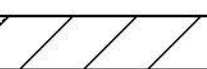

WETLAND #12
CLASS 2
PSSI/EMY

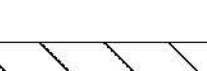
LEGEND

-  PHASE I CONSTRUCTION
-  TEMPORARY WIDENING FOR PHASE I TRAFFIC
-  TEMPORARY WIDENING FOR PHASE II TRAFFIC
-  PHASE I TRAFFIC
- SSL SINGLE SOLID WHITE LINE
100mm WIDE (PAINT)
- DSL DOUBLE SOLID YELLOW LINE
100mm WIDE (PAINT)



**PHASE I
TRAFFIC CONTROL PLAN 16**

PROJECT NAME: BRANDON	PLOT DATE: 9/3/2009
PROJECT NUMBER: NH 019-3(495)	DRAWN BY: NLL
FILE NAME: zb008s5+tcpl6.dgn	CHECKED BY: KLS
PROJECT LEADER: CRB	SHEET 297 OF 546
DESIGNED BY: PTS	
CLD 02-0149	