

TEMPORARY 100mm WHITE LINE, PAINT
 DURABLE 100mm WHITE LINE, THERMOPLASTIC
 STA 19+070 TO 19+230 SOLID LT
 STA 19+070 TO 19+176 SOLID RT
 STA 19+200 TO 19+230 SOLID RT
 STA 3+003 TO 3+014 SOLID LT & RT (COUNTRY CLUB RD)

TEMPORARY 100mm YELLOW LINE, PAINT
 DURABLE 100mm YELLOW LINE, THERMOPLASTIC
 STA 19+070 TO 19+182 SOLID LT & RT
 STA 19+194 TO 19+230 SOLID LT & RT
 STA 3+008 TO 3+014 SOLID LT & RT (COUNTRY CLUB RD)

TEMPORARY 600mm STOP BAR, PAINT
 DURABLE 600mm STOP BAR, THERMOPLASTIC
 STA 3+008 LT (COUNTRY CLUB RD)

TEMPORARY LETTER OR SYMBOL, PAINT
 DURABLE LETTER OR SYMBOL, THERMOPLASTIC
 STA 3+010 LT - "STOP" (COUNTRY CLUB RD)

REMOVING SIGNS
 AS SHOWN - 5
 ERECTING SALVAGED SIGNS
 AS SHOWN - 1

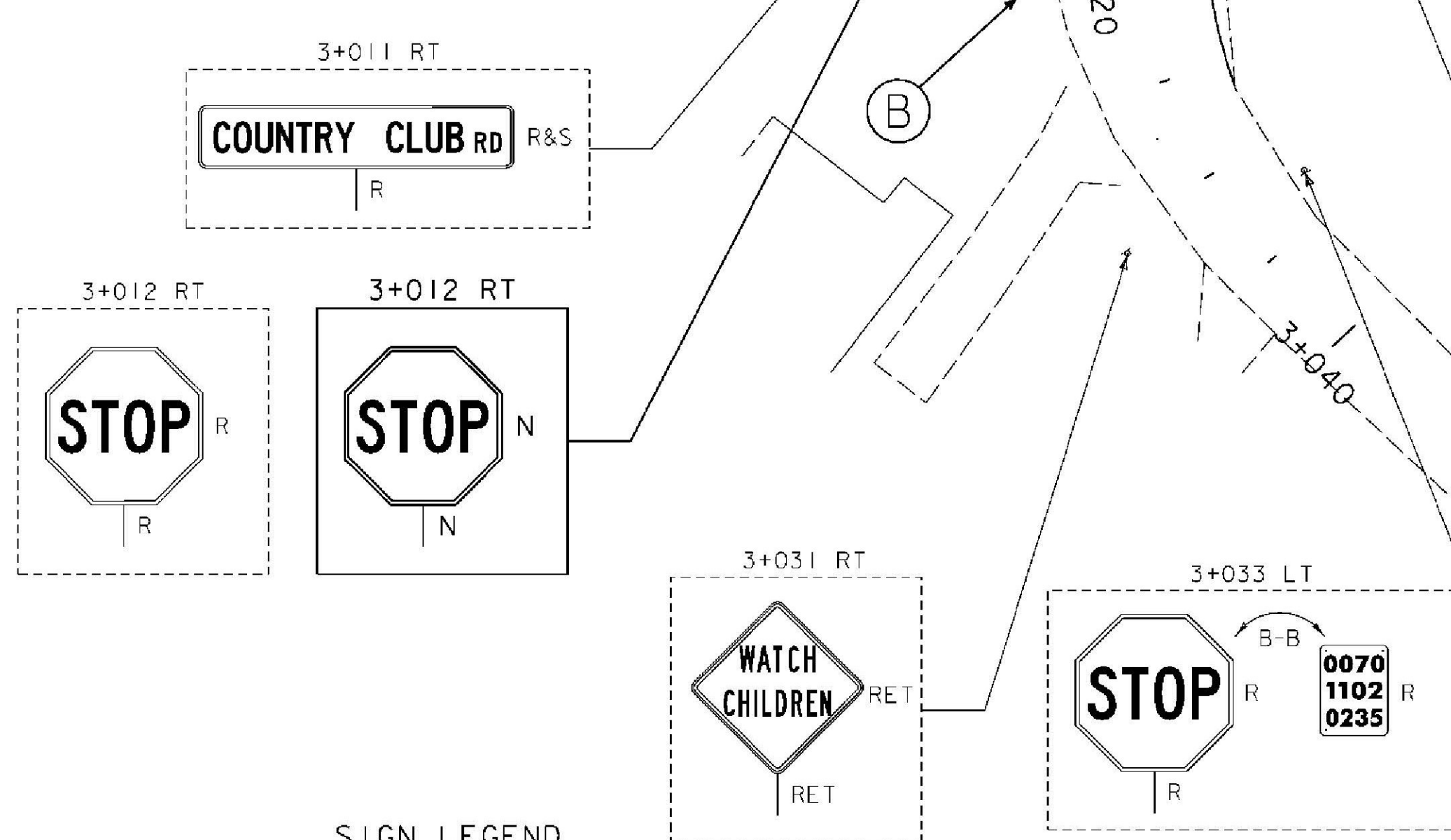
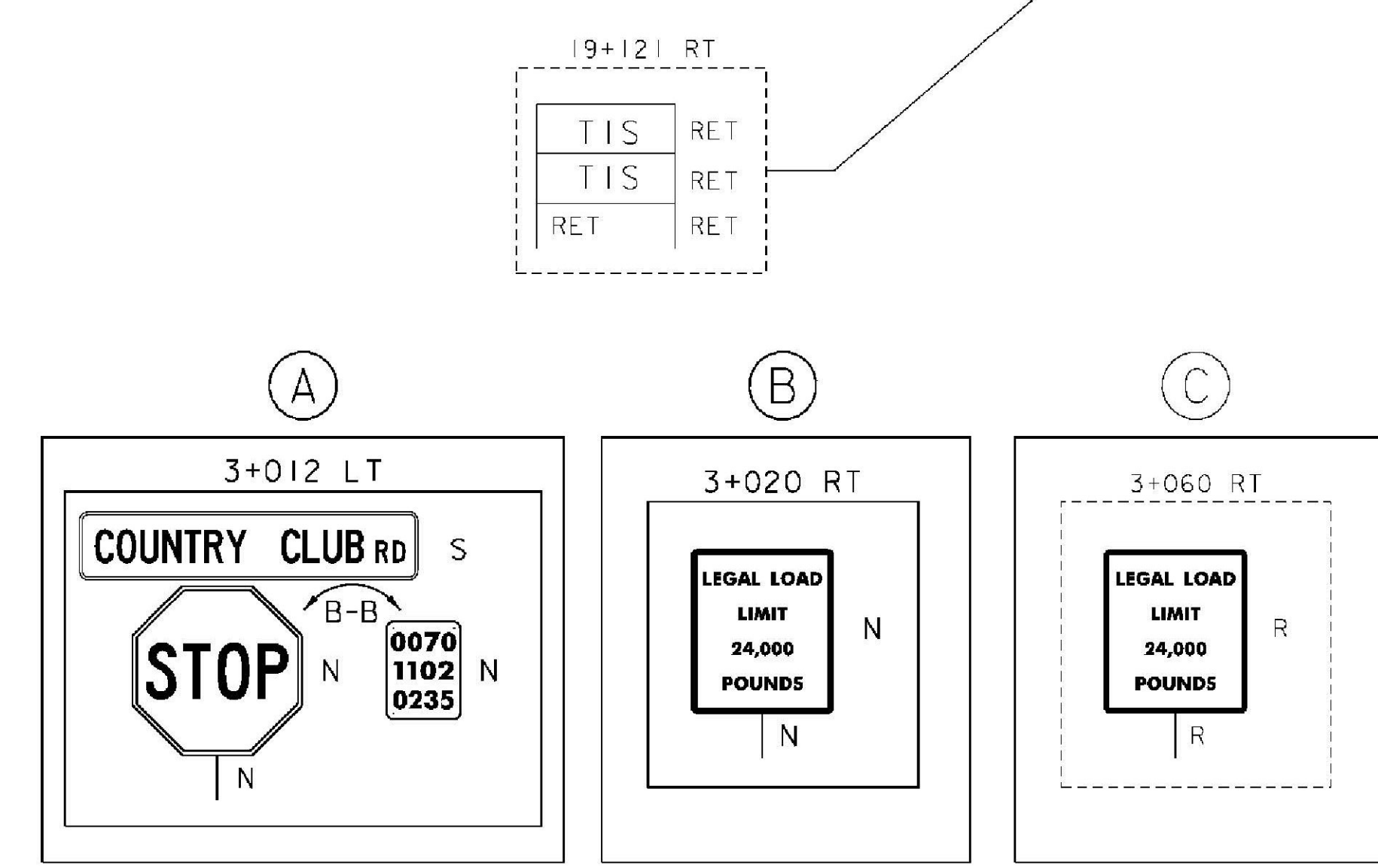
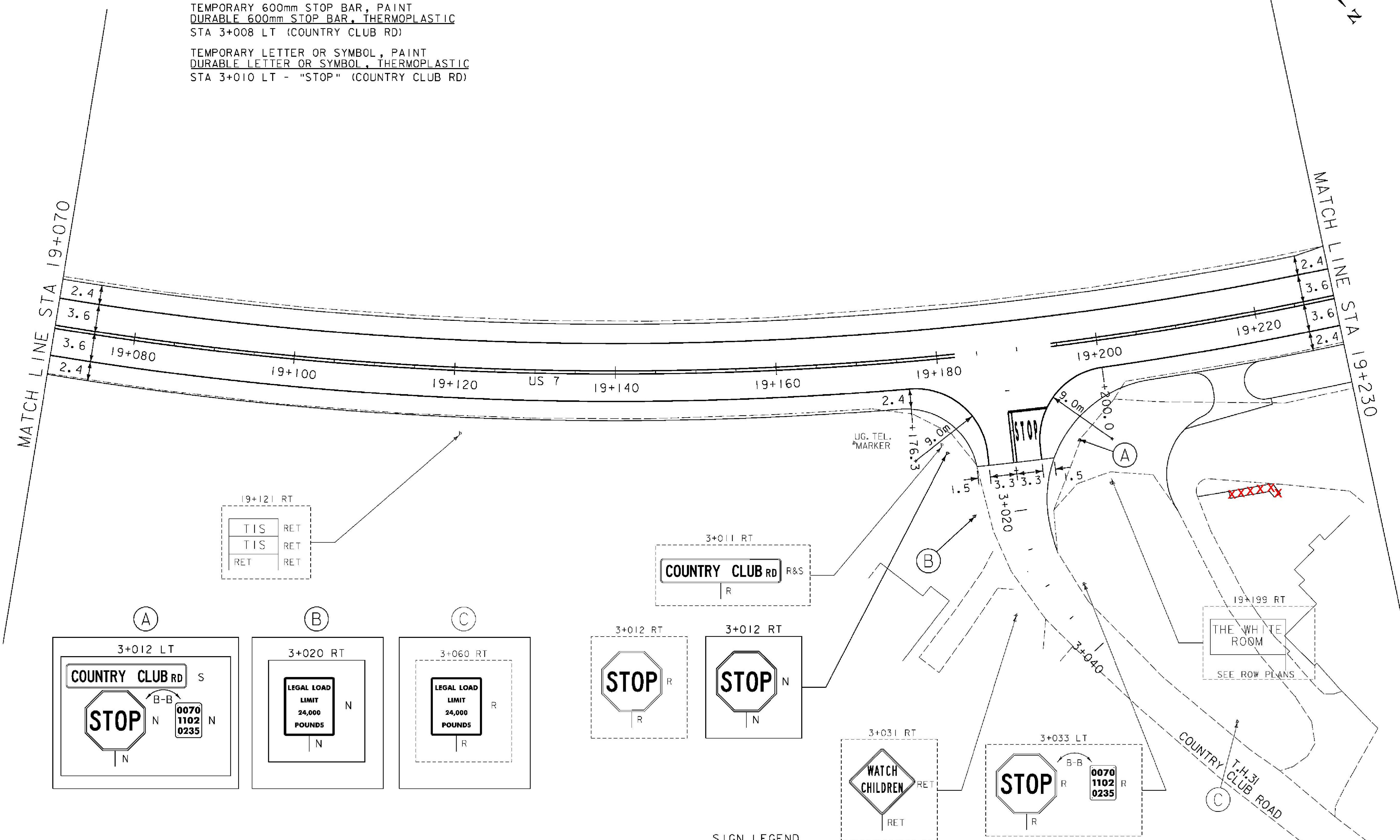
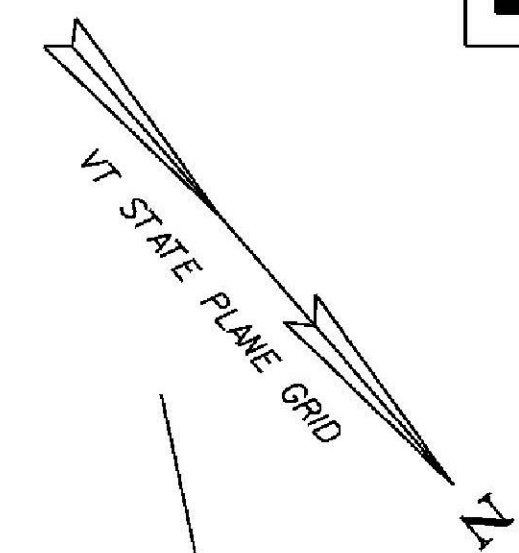

SIGN LEGEND
 R = REMOVE
 S = SALVAGE
 N = NEW
 RET = RETAIN
 T&T = THINNING & TRIMMING
 B-B = BACK TO BACK
 EXISTING
 NEW



SIGNING & PAVEMENT MARKING 18

PROJECT NAME: BRANDON	PLOT DATE: 9/3/2009
PROJECT NUMBER: NH 019-3(495)	DRAWN BY: HJC
FILE NAME: zb008s5-tsl8.dgn	CHECKED BY: PTS
PROJECT LEADER: CRB	SHEET 259 OF 546
DESIGNED BY: NLL	
CLD 02-0149	