

STONE FILL, TYPE II (IN DITCHES)  
 GEOTEXTILE UNDER STONE FILL  
 STA 18+760 - 18+770 RT  
 STA 18+785 - 18+830 LT

TEMPORARY STONE CHECK DAM, TYPE I  
 STA 18+830 LT  
 INLET PROTECTION DEVICE, TYPE I  
 STA 18+772 LT  
 STA 18+886 LT

TEMPORARY EROSION MATTING (IN DITCHES)  
 STA 18+750 - 18+773 LT  
 STA 18+830 - 18+840 LT  
 TEMPORARY EROSION MATTING (ON SLOPES)  
 STA 18+750 - 18+775 LT  
 STA 18+785 - 18+830 LT

PROJECT DEMARCATION FENCE  
 STA 18+750 - 18+770 LT  
 STA 18+781 - 18+845 LT  
 BARRIER FENCE  
 STA 18+750 - 18+808 RT  
 STA 18+820 - 18+906 RT  
 STA 18+852 - 18+892 LT  
 GEOTEXTILE FOR SILT FENCE  
 STA 18+750 - 18+903 RT  
 STA 18+811 - 18+815 RT  
 STA 18+899 - 18+904 LT (2)

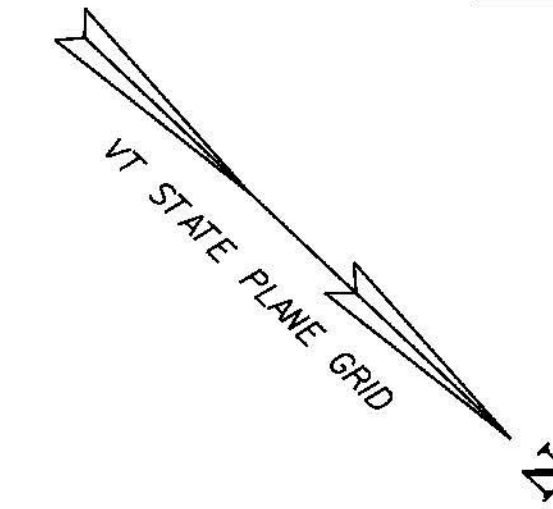

APPROX. DRIVEWAY  
 LOCATION (NOT SURVEYED)

IRON PIPE

APPROX.  
 LOCATION  
 SEPTIC

IRON  
 PIN

**STA 18+856.000**  
**STOP FULL DEPTH**  
**CONSTRUCTION**  
**BEGIN COLD PLANE**  
**& OVERLAY**

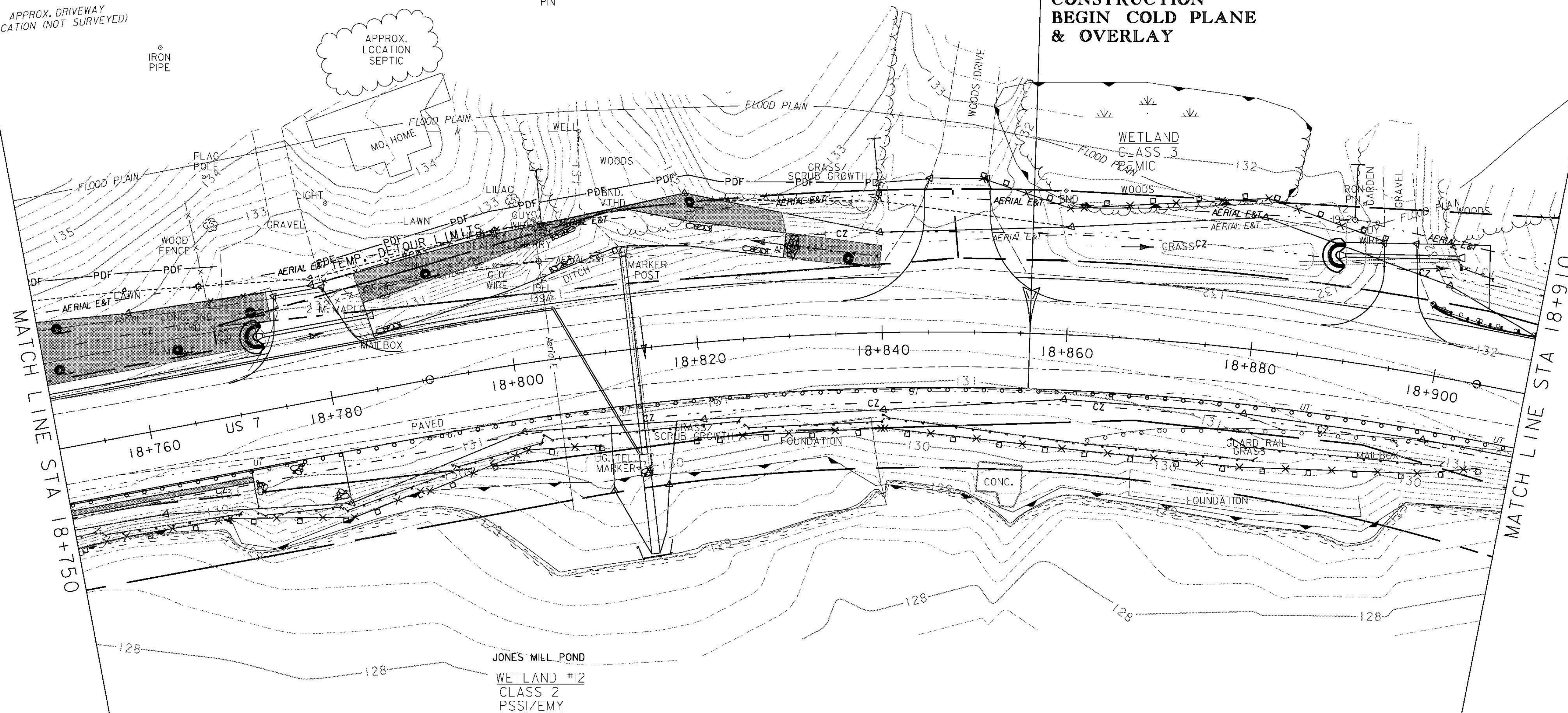

LEGEND	
	ROADSIDE DITCH/SLOPE PROTECTION
	DETOUR SLOPE LIMITS
	PERMANENT SLOPE LIMITS
	SILT FENCE
	INLET PROTECTION DEVICE, TYPE I
	PIPE INLET PROTECTION
	EROSION MATTING
	CHECK DAM - TEMPORARY
	BARRIER FENCE
	PROJECT DEMARCATION FENCE
	FILTER CURTAIN

**NOTES:**

- SILT FENCE LOCATIONS SHOWN ON THIS DRAWING ARE APPROXIMATE. THE CONTRACTOR IS RESPONSIBLE FOR INSTALLING THE SILT FENCE IN ACCORDANCE WITH THE GUIDELINES SET FORTH IN THE VERMONT GENERAL PERMIT FOR STORMWATER RUNOFF FROM CONSTRUCTION SITES. THE RESIDENT ENGINEER AND ON SITE COORDINATOR SHALL APPROVE ALL SILT FENCE LOCATIONS PRIOR TO PLACEMENT.
- FOR EROSION PREVENTION AND SEDIMENT CONTROL PLAN GENERAL NOTES, SEE SHEETS 147 - 148, AND DETAILS, SEE SHEETS 177 - 180.

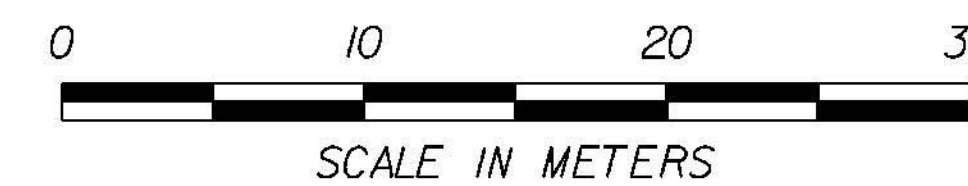

**EROSION CONTROL PLAN 16**

PROJECT NAME: BRANDON	PLOT DATE: 9/3/2009
PROJECT NUMBER: NH 019-3(495)	DRAWN BY: NLL
FILE NAME: zb008s5-ec16.dgn	CHECKED BY: PTS
PROJECT LEADER: CRB	SHEET 164 OF 546
DESIGNED BY: NLL	
CLD 02-0149	