

STONE FILL, TYPE I (IN DITCHES)
 GEOTEXTILE UNDER STONE FILL
 STA 17+800 - 17+830 LT

TEMPORARY STONE CHECK DAM, TYPE I
 STA 17+870 - 17+950 LT

INLET PROTECTION DEVICE, TYPE I
 STA 17+815 LT
 STA 17+900 RT
 STA 17+939 RT

TEMPORARY EROSION MATTING (IN DITCHES)
 STA 17+870 - 17+950 LT
 STA 17+910 - 17+938 RT

GEOTEXTILE FOR SILT FENCE
 STA 17+797 - 17+814 RT
 STA 17+825 - 17+830 RT
 STA 17+836 - 17+861 RT
 STA 17+927 - 17+928 RT

PROJECT DEMARCATION FENCE
 STA 17+790 - 17+950 LT
 STA 17+840 - 17+865 RT
 STA 17+872 - 17+902 RT
 STA 17+909 - 17+940 RT
 STA 17+946 - 17+950 RT

BARRIER FENCE
 STA 17+790 - 17+805 RT
 STA 17+820 - 17+840 RT

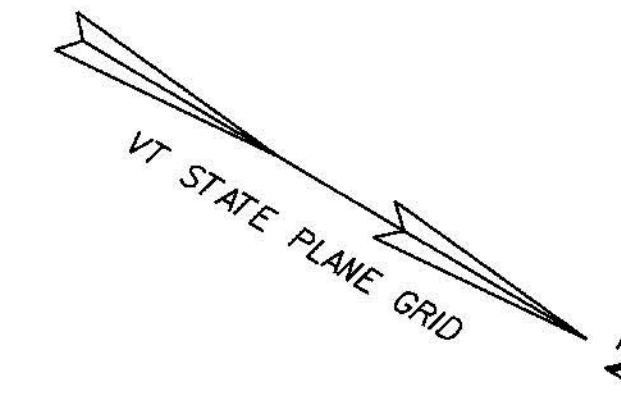

BM #13
 RRSIR S.PINE
 EL. = 135.931m

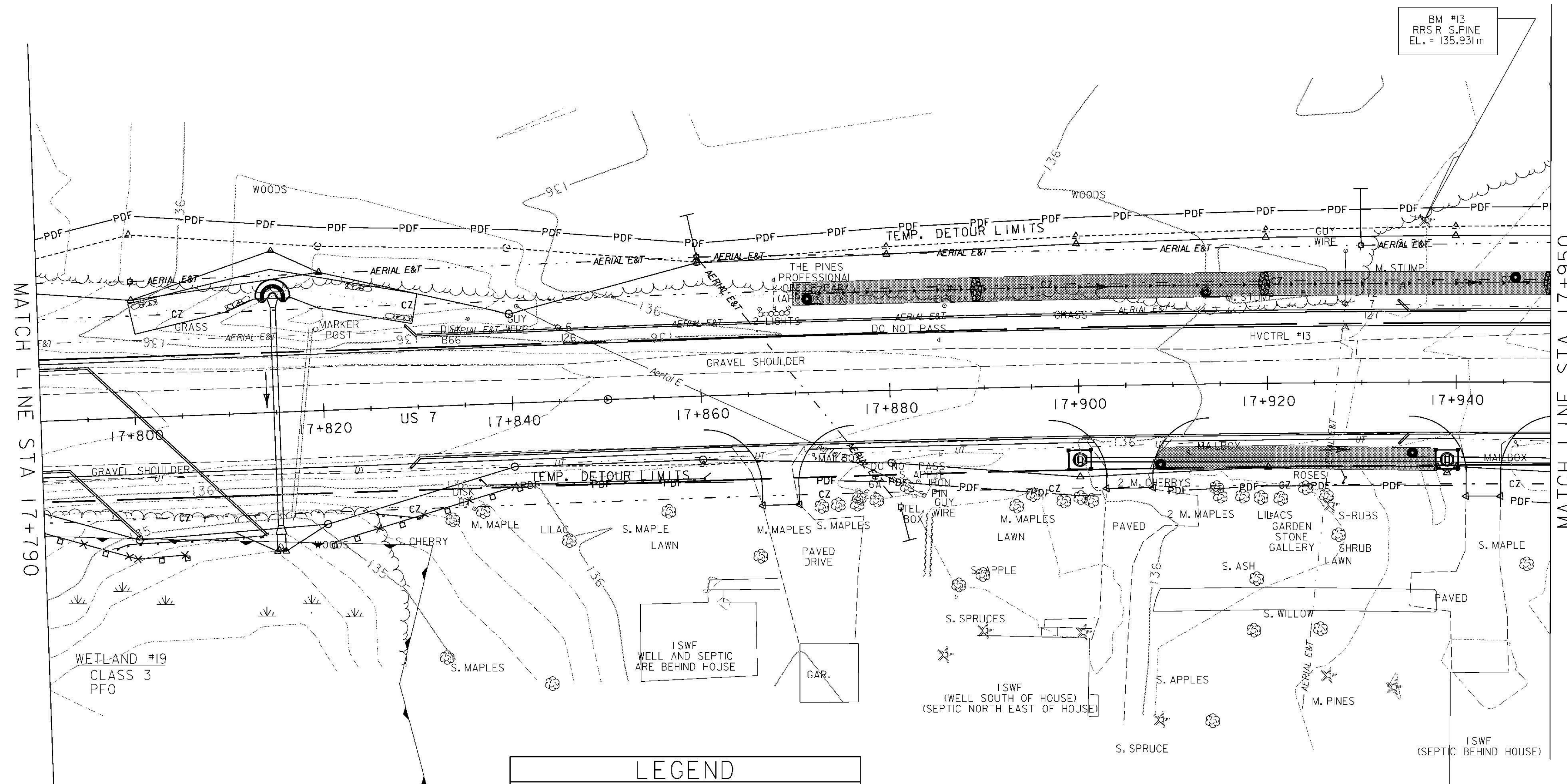

LEGEND	
	ROADSIDE DITCH/SLOPE PROTECTION
	DETOUR SLOPE LIMITS
	PERMANENT SLOPE LIMITS
	SILT FENCE
	INLET PROTECTION DEVICE, TYPE I
	PIPE INLET PROTECTION
	EROSION MATTING
	CHECK DAM - TEMPORARY
	BARRIER FENCE
	PROJECT DEMARCATION FENCE
	FILTER CURTAIN

NOTES:

- SILT FENCE LOCATIONS SHOWN ON THIS DRAWING ARE APPROXIMATE. THE CONTRACTOR IS RESPONSIBLE FOR INSTALLING THE SILT FENCE IN ACCORDANCE WITH THE GUIDELINES SET FORTH IN THE VERMONT GENERAL PERMIT FOR STORMWATER RUNOFF FROM CONSTRUCTION SITES. THE RESIDENT ENGINEER AND ON SITE COORDINATOR SHALL APPROVE ALL SILT FENCE LOCATIONS PRIOR TO PLACEMENT.
- FOR EROSION PREVENTION AND SEDIMENT CONTROL PLAN GENERAL NOTES, SEE SHEETS 147 - 148, AND DETAILS, SEE SHEETS 177 - 180.



EROSION CONTROL PLAN 10

PROJECT NAME:	BRANDON	PLOT DATE:	9/3/2009
PROJECT NUMBER:	NH 019-3(495)	DRAWN BY:	NLL
FILE NAME:	zb008s5-ec10.dgn	CHECKED BY:	PTS
PROJECT LEADER:	CRB	SHEET	158 OF 546
DESIGNED BY:	NLL		
CLD 02-0149			