

US 7

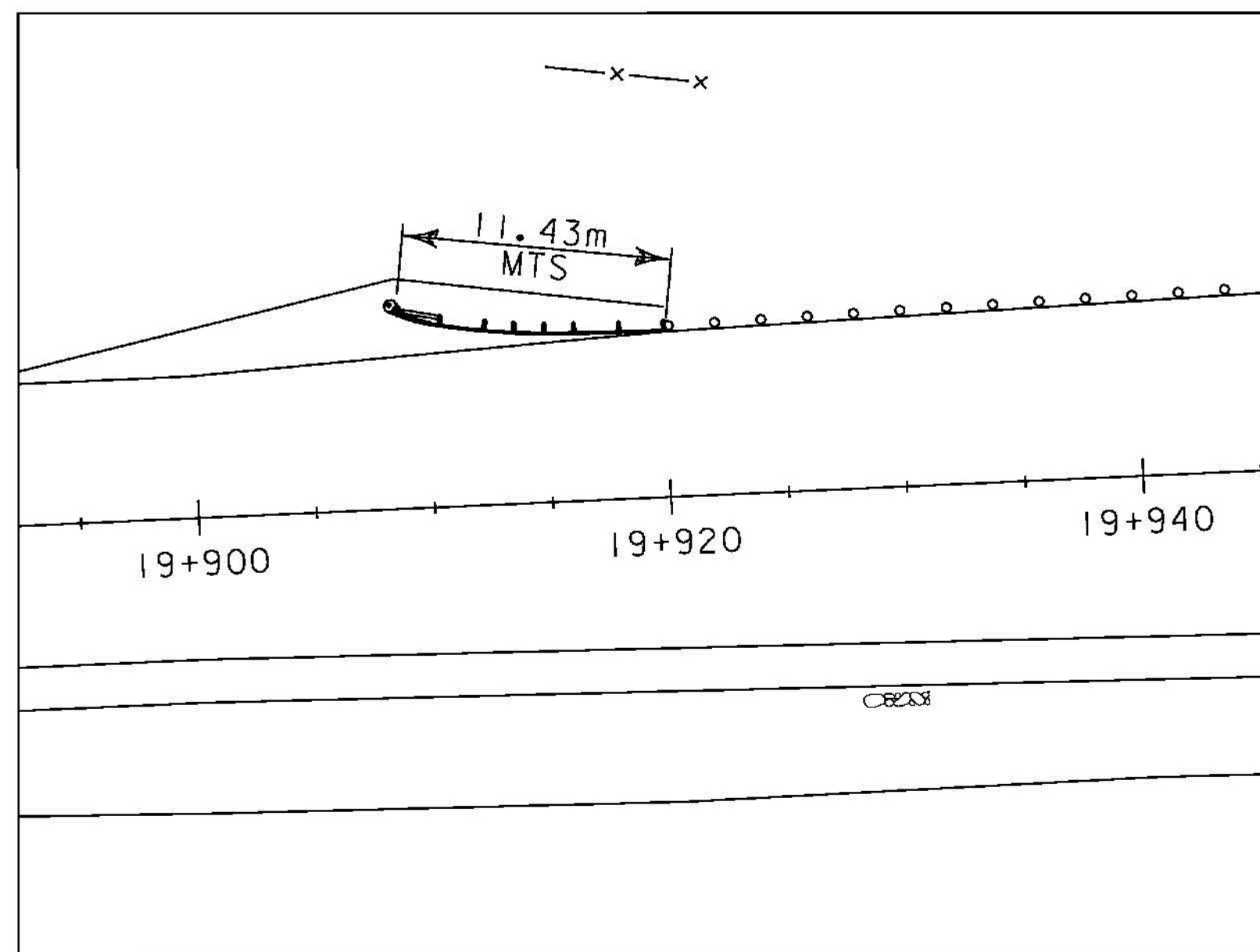

US 7

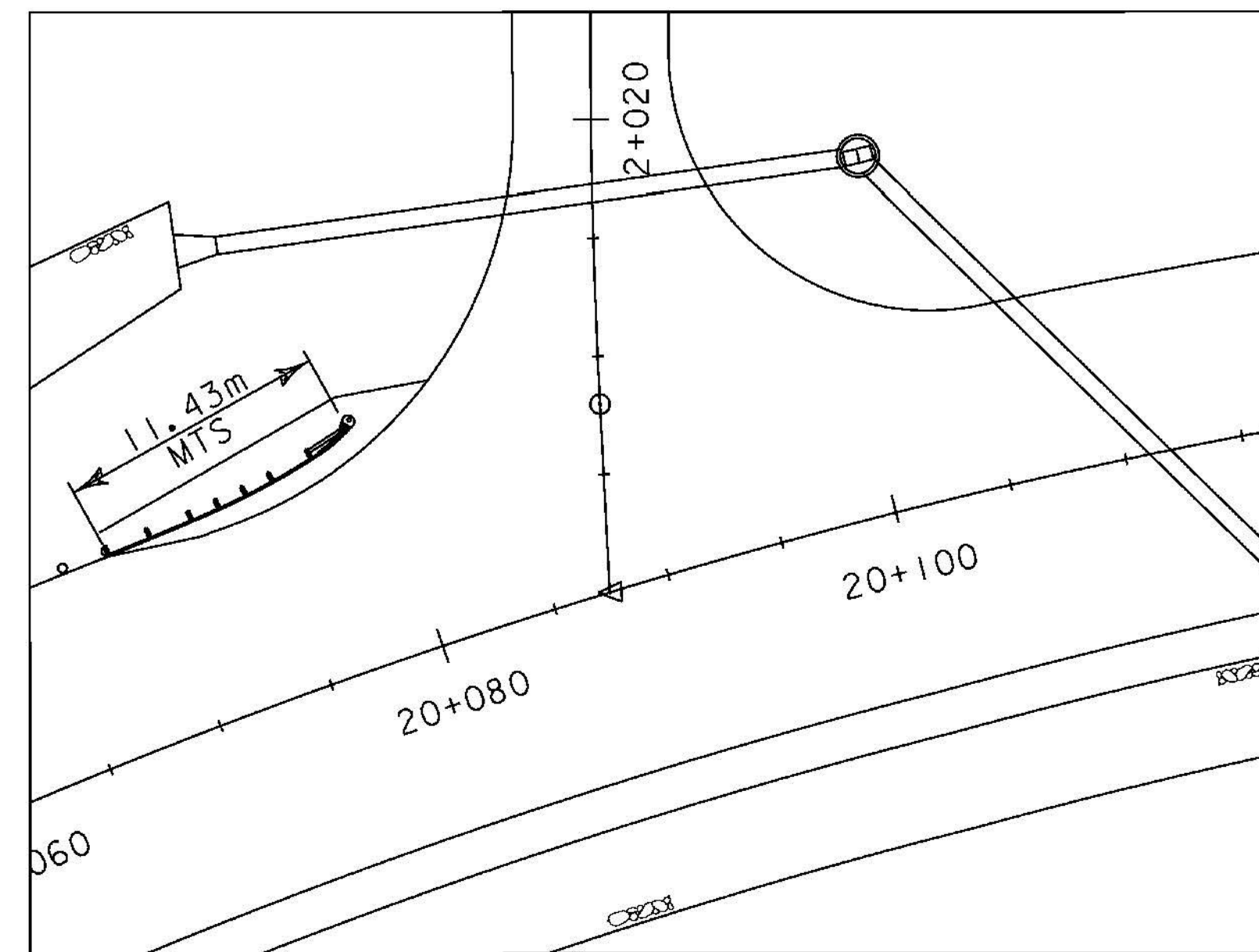

US 7

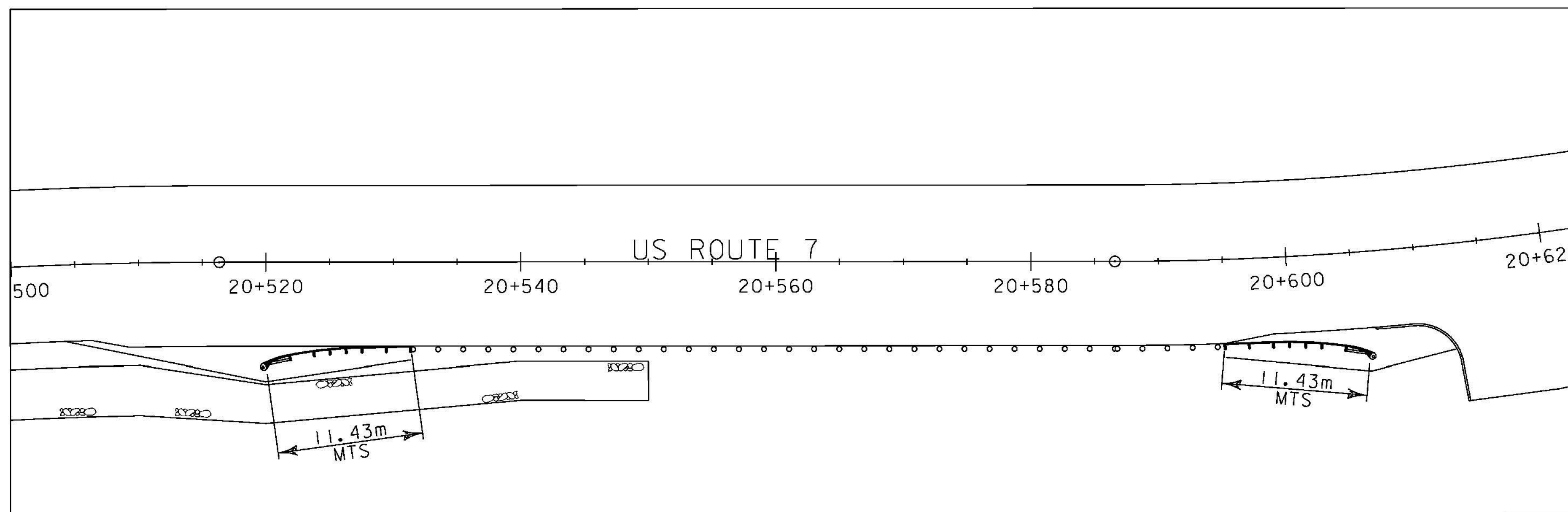

US 7

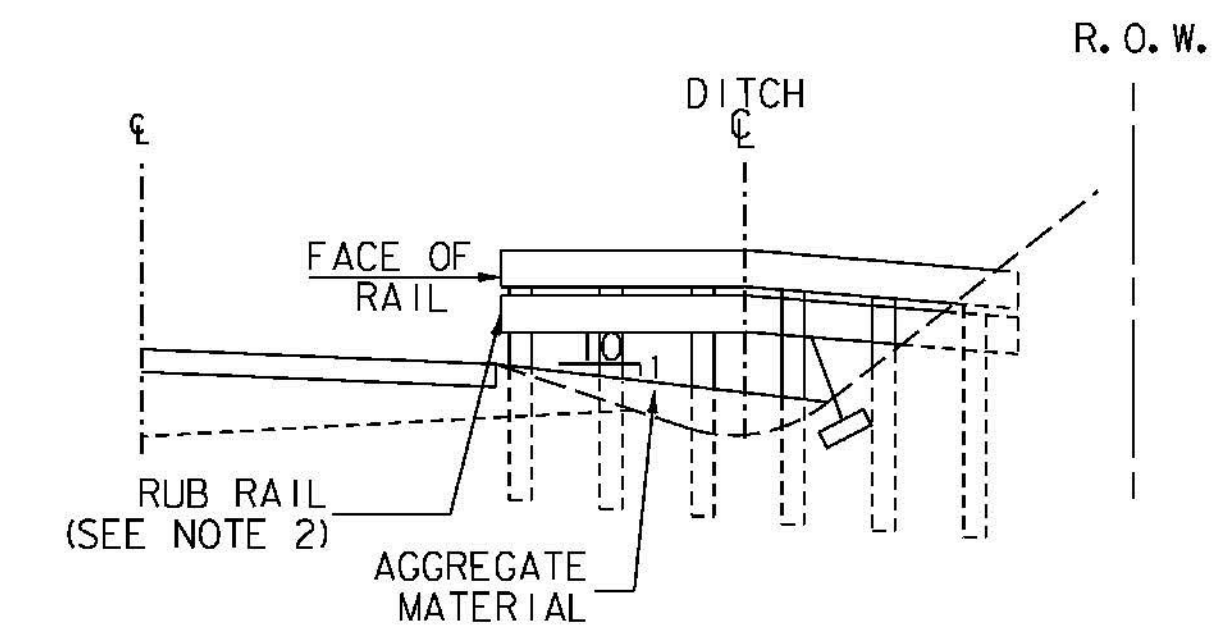
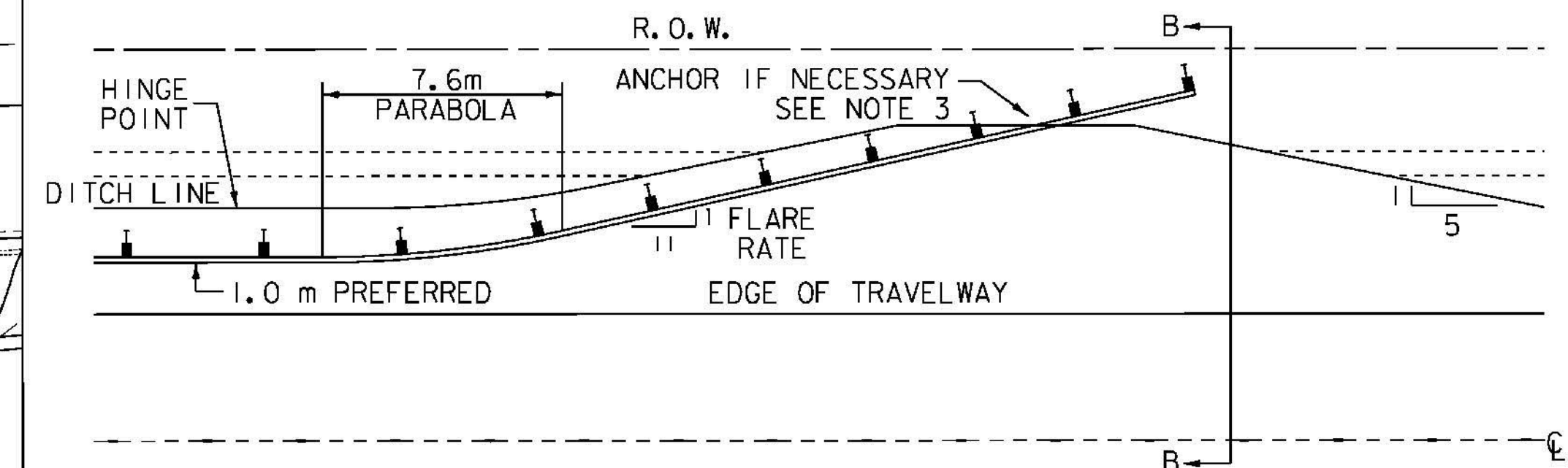

SECTION B-B

(NOT TO SCALE)

DETAIL FOR BURIED GUARDRAIL ENDS INTO BACK SLOPE WITH RUB RAIL

1. HEIGHT OF PRIMARY RAIL SHALL REMAIN AT A CONSTANT HEIGHT RELATIVE TO ROADWAY GRADE TO POINT OF DITCH BOTTOM.
2. ADDITION OF RUB RAIL IS REQUIRED WHEN OPENING BENEATH PRIMARY RAIL EXCEEDS 450 mm. RUB RAIL EXTENDS FROM THE EDGE OF SHOULDER TO THE BACK SLOPE. PAYMENT FOR RUB RAIL WILL BE AT THE CONTRACT UNIT PRICE FOR STEEL BEAM GUARDRAIL.
3. RAIL TO BE BURIED A DISTANCE OF 3.8M INTO BACKSLOPE. IF THIS CANNOT BE OBTAINED, AN ANCHOR SHALL BE INSTALLED, ITEM 621.60, ANCHOR FOR STEEL BEAM RAIL.

GUARDRAIL DETAIL 3

PROJECT NAME:	BRANDON	PLOT DATE:	9/3/2009
PROJECT NUMBER:	NH 019-3(495)	DRAWN BY:	HJC
FILE NAME:	zb008s5-gendet.dgn	CHECKED BY:	DAM
PROJECT LEADER:	CRB	DESIGNED BY:	PTS
CLD 02-0149			SHEET 134 OF 546