

REMOVAL AND DISPOSAL OF GUARDRAIL
STA 18+910.0 - 18+922.0 RT

STEEL BEAM GUARDRAIL, GALVANIZED
STA 18+910.0 - 18+922.0 RT (CONNECT
TO EXISTING AT STA 18+922.0 RT)

COLD PLANING, BITUMINOUS CONCRETE PAVEMENT
(TYPE 111S) (1-45 mm LIFT)
STA 18+910.0 - 19+070.0

COE
PLOT E-2

COE
PLOT E-1

WETLAND
CLASS 2
PSSI/EMY

BM #10 VT. SURVEY DISK
"JONES POND US7 1998"
EL. = 130.106 m

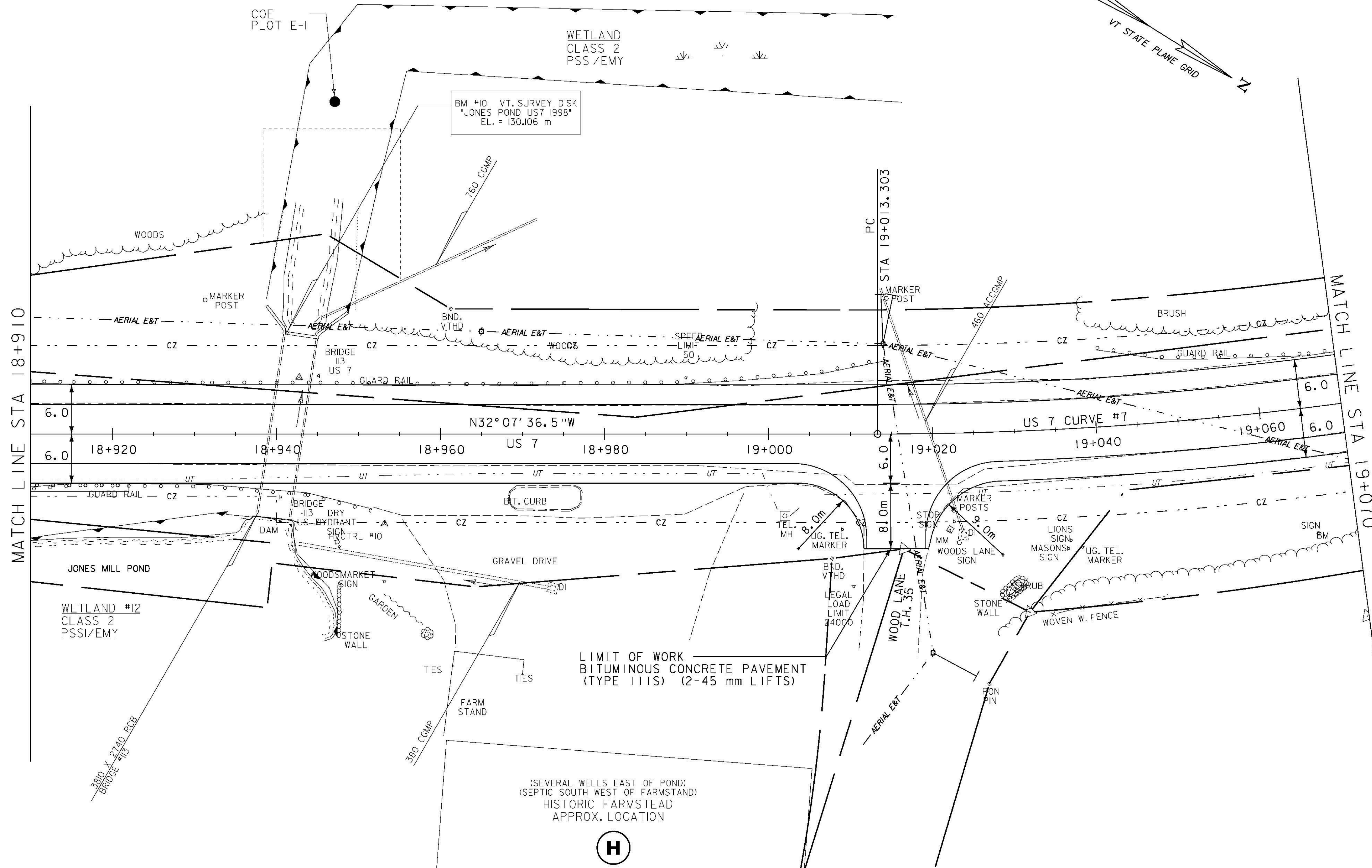
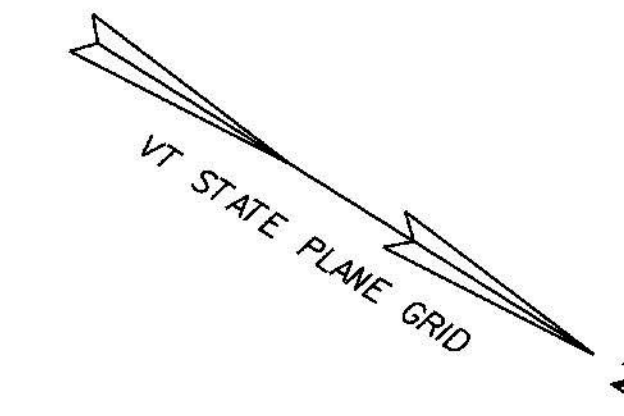

⊗ DENOTES TREE OR STUMP REMOVAL



ROADWAY LAYOUT 17

PROJECT NAME:	BRANDON	PLOT DATE:	9/3/2009
PROJECT NUMBER:	NH 019-3(495)	DRAWN BY:	NLL
FILE NAME:	zb008s5-gen17.dgn	CHECKED BY:	PTS
PROJECT LEADER:	CRB	SHEET	100 OF 546
DESIGNED BY:	DAM		
CLD 02-0149			