

CONSTRUCT DRIVES

STA 17+868.0 RT - 3.9 m WIDE, PAVED-RES.
 STA 17+905.0 RT - 4.9 m WIDE, PAVED-RES.
 STA 17+943.0 RT - 3.6 m WIDE, PAVED-RES.
 SPECIAL PROVISION (REMOVING AND RESETTING
 GROUND /ORNAMENTAL LIGHT)
 STA 17+866.5 LT
 STA 17+869.5 LT

RELOCATE MAILBOX, SINGLE SUPPORT

STA 17+873.0 RT
 STA 17+911.3 RT
 STA 17+946.1 RT
 SPECIAL PROVISION (REMOVE
 AND RESET COMMERCIAL SIGN)
 STA 17+868.0 LT

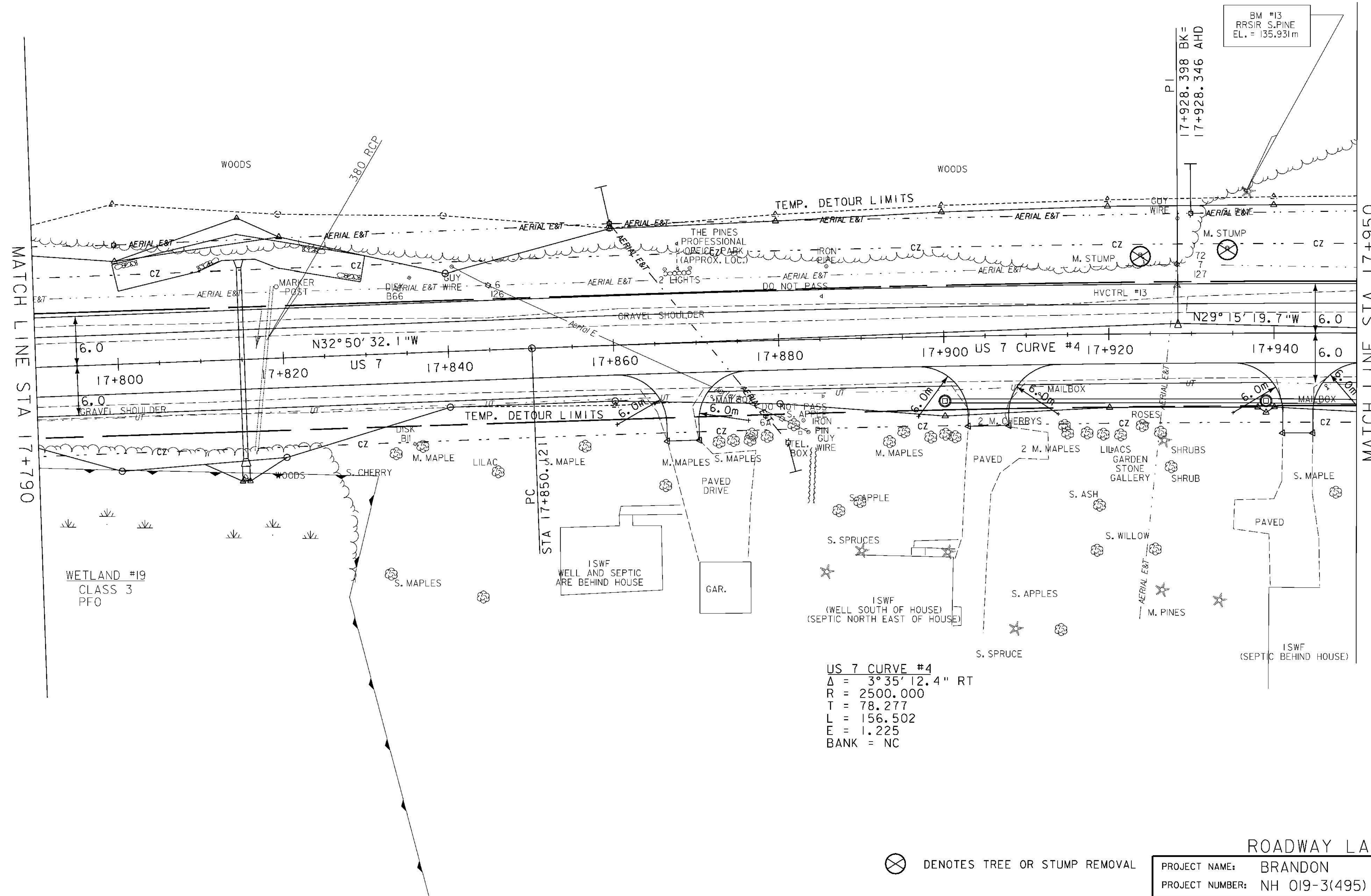
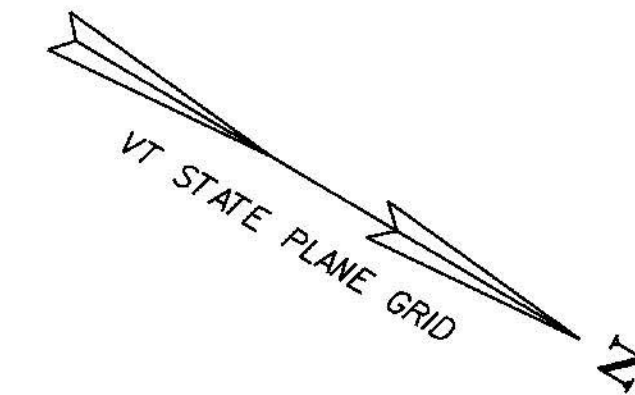

MATCH LINE STA 17+790

MATCH LINE STA 17+950

⊗ DENOTES TREE OR STUMP REMOVAL



ROADWAY LAYOUT 10

PROJECT NAME:	BRANDON	PLOT DATE:	9/3/2009
PROJECT NUMBER:	NH 019-3(495)	DRAWN BY:	NLL
FILE NAME:	zb008s5-genl0.dgn	CHECKED BY:	PTS
PROJECT LEADER:	CRB	CLD 02-0149	SHEET 86 OF 546