

CONSTRUCT DRIVES
 STA 18+017.0 RT - 5.6 m WIDE, PAVED-RES.

RELOCATE MAILBOX, SINGLE SUPPORT
 STA 17+978.8 LT
 STA 18+023.7 RT
 SPECIAL PROVISION (REMOVE AND RESET COMMERCIAL SIGN)
 STA 18+009.6 LT

SPECIAL PROVISION (REMOVING AND RESETTING GROUND/ORNAMENTAL LIGHT)
 STA 18+008.1 LT
 STA 18+011.2 LT

| REMOVE & REPLACE PROPERTY MARKERS | |
|---------------------------------------|---------------------------------------|
| EXISTING | PROPOSED |
| IP 18+044.356 13.878 m (45.53') RT | NONE |
| IP 18+048.499 13.271 m (43.54') RT | IP 18+049.648 10.973 m (36.00') RT |

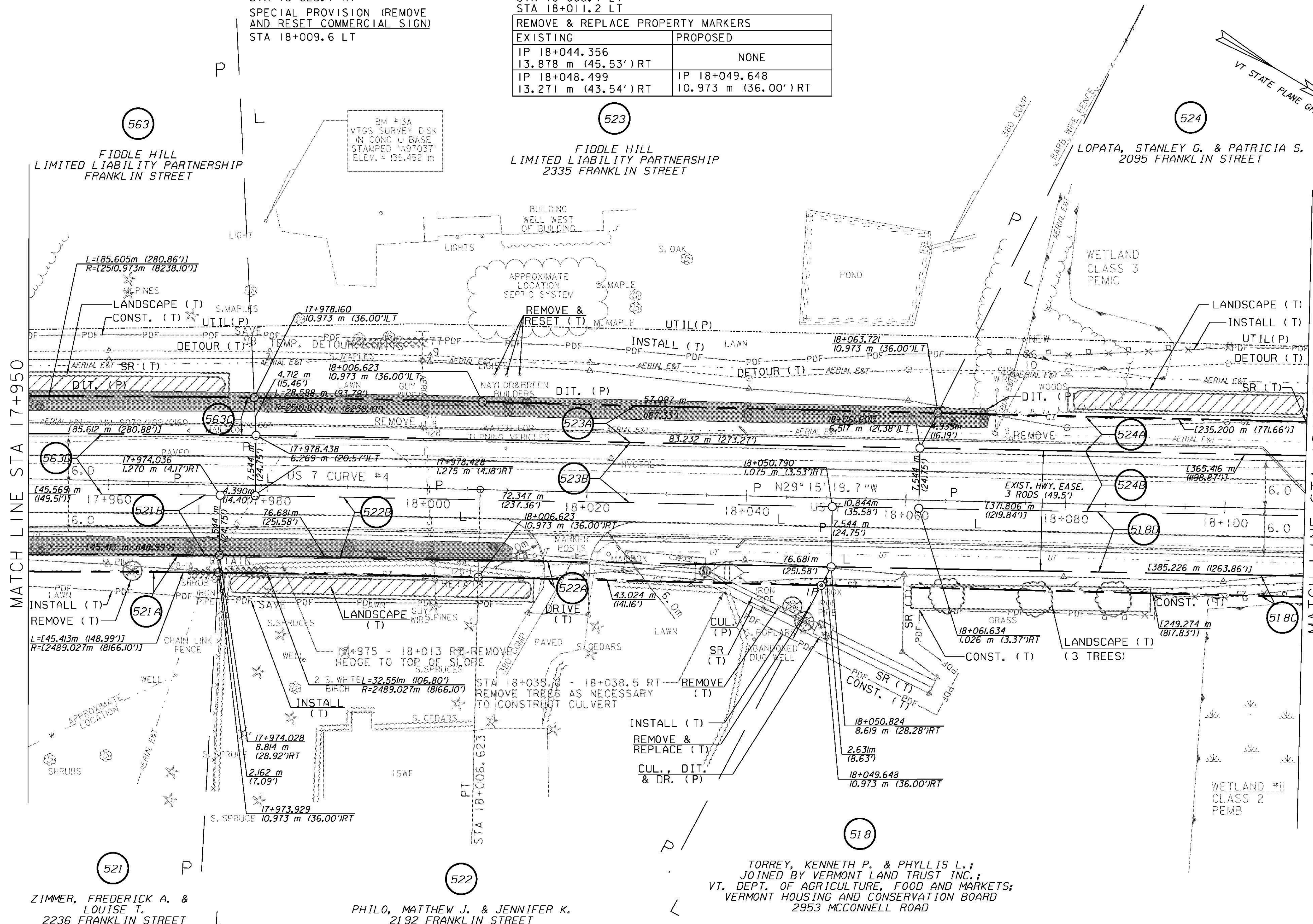
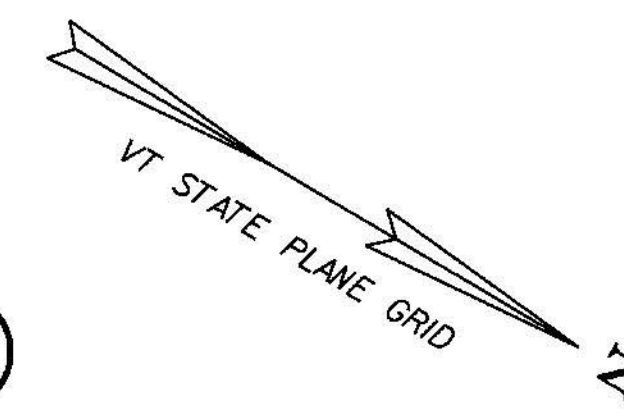

MATCH LINE STA 17+950

MATCH LINE STA 18+110

LINES SHOWN ON THIS PLAN AS EXISTING PROPERTY LINES (P/L) ARE BELIEVED TO BE ACCURATE BUT SHOULD NOT BE RELIED UPON FOR PURPOSES UNRELATED TO THE STATE OF VERMONT ACQUISITION OF LAND AND RIGHTS FOR THIS PROJECT

⊗ DENOTES TREE OR STUMP REMOVAL



RIGHT-OF-WAY LAYOUT II

| | | | |
|-----------------|-------------------|-------------|-----------|
| PROJECT NAME: | BRANDON | PLOT DATE: | 9/3/2009 |
| PROJECT NUMBER: | NH 019-3(495) | DRAWN BY: | JCS |
| FILE NAME: | zb008s5-ROWII.dgn | CHECKED BY: | PTS |
| PROJECT LEADER: | CRB | ROW SHEET | 31 OF 164 |
| DESIGNED BY: | PTS | SHEET | 46 OF 546 |

ZIMMER, FREDERICK A. & LOUISE T.
 2236 FRANKLIN STREET

PHILO, MATTHEW J. & JENNIFER K.
 2192 FRANKLIN STREET

TORREY, KENNETH P. & PHYLLIS L.;
 JOINED BY VERMONT LAND TRUST INC.;
 VT. DEPT. OF AGRICULTURE, FOOD AND MARKETS;
 VERMONT HOUSING AND CONSERVATION BOARD
 2953 MCCONNELL ROAD