

TEMPORARY AND DURABLE 100mm WHITE LINE

STA 9+000 TO 9+180 SOLID LT
 STA 9+000 TO 9+050 SOLID RT
 STA 9+050 TO 9+064 SOLID RT (TH 374)
 STA 9+068 TO 9+070 SOLID LT (TH 374)
 STA 9+070 TO 9+080 SOLID RT
 STA 9+082 TO 9+083 SOLID RT (TH 374)
 STA 9+090 TO 9+100 SOLID RT (TH 374)
 STA 9+100 TO 9+180 SOLID RT

TEMPORARY AND DURABLE 100mm YELLOW LINE

STA 9+000 TO 9+057 SOLID LT & RT
 STA 9+063 DOUBLE SOLID RT (TH 374)
 STA 9+069 TO 9+090 SOLID LT & RT
 STA 9+088 DOUBLE SOLID RT (TH 374)
 STA 9+102 TO 9+180 SOLID LT & RT

DURABLE 600mm STOP BAR (TYPE +TAPE)

STA 9+065 RT (TH 374)
 STA 9+090 RT (TH 374)

TEMPORARY 600mm STOP BAR

STA 9+065 RT (TH 374)
 STA 9+090 RT (TH 374)

DURABLE LETTER OR SYMBOL (TYPE +TAPE)

STA 9+066 RT - "STOP" (TH 374)
 STA 9+097 RT - "STOP" (TH 374)

TEMPORARY LETTERS OR SYMBOLS

STA 9+066 RT - "STOP" (TH 374)
 STA 9+097 RT - "STOP" (TH 374)

DURABLE CROSSWALK MARKINGS W/DIAGONAL LINES (MOD)

STA 9+083 TO 9+098 RT
 STA 9+084 TO 9+086 RT TO LT

TEMPORARY CROSSWALK MARKINGS W/DIAGONAL LINES

STA 9+083 TO 9+098 RT
 STA 9+084 TO 9+086 RT TO LT

ADJUST ELEVATION OF VALVE BOX

STA 9+080 RT
 STA 9+082 LT
 STA 9+082 RT
 STA 9+085 LT
 STA 9+091 RT

SHOULDER BERM REMOVAL

STA 9+043 TO 9+072 RT

CHANGING ELEV. OF DI, CB, OR MH

STA 9+037 LT (CB)
 STA 9+084 RT (CB) - TH 374

CHANGING ELEVATION OF SEWER MANHOLE

STA 9+032 RT

REMOVING SIGNS

AS SHOWN - 8/4

ERECTING SALVAGED SIGNS

AS SHOWN - 1

RETAIN
 9+178 LT

STA 9+000.00
 (MM 5.592)

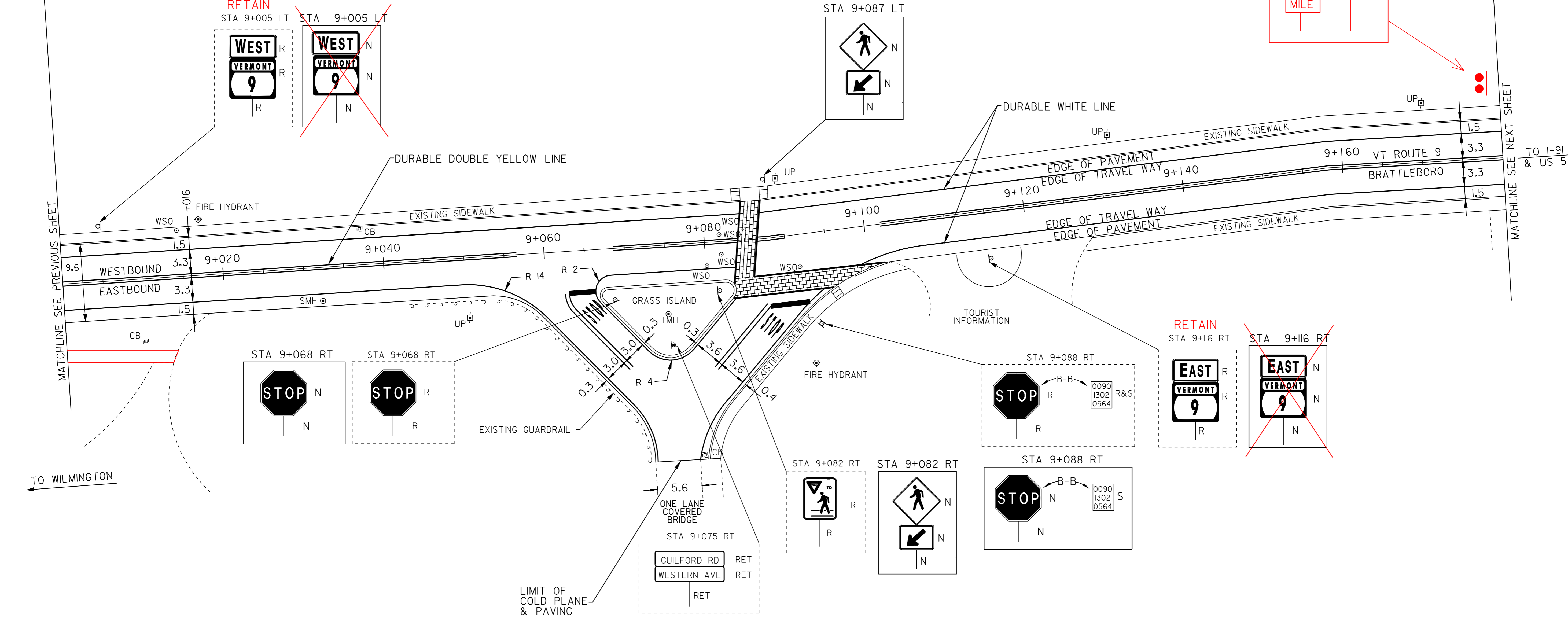

TO WILMINGTON

TO I-91 & US 5

GUILFORD RD.
 TH 374
 STA 9+075.16
 (MM 5.639)
 PAVED

- LEGEND**
- R = REMOVE EXISTING
 - S = SALVAGE
 - R&S = REMOVE AND SALVAGE
 - N = NEW
 - RET = RETAIN
 - B-B = BACK TO BACK

NOTE: ALL DIMENSIONS IN METERS EXCEPT AS INDICATED

NOT TO SCALE

PAVING PROJECT LAYOUT #13	PROJECT NAME: BRATTLEBORO	FILE NAME: \PAVE\01D026\PD026.dgn	PLOT DATE: \$DATE\$
	PROJECT NUMBER: SI-STP_2303(I)S	PROJECT LEADER: WRH	DRAWN BY: JAC
	DESIGNED BY:	CHECKED BY: NLL	SHEET 20 OF 55
	CLD REF. NO.: p026113.1		