

Existing

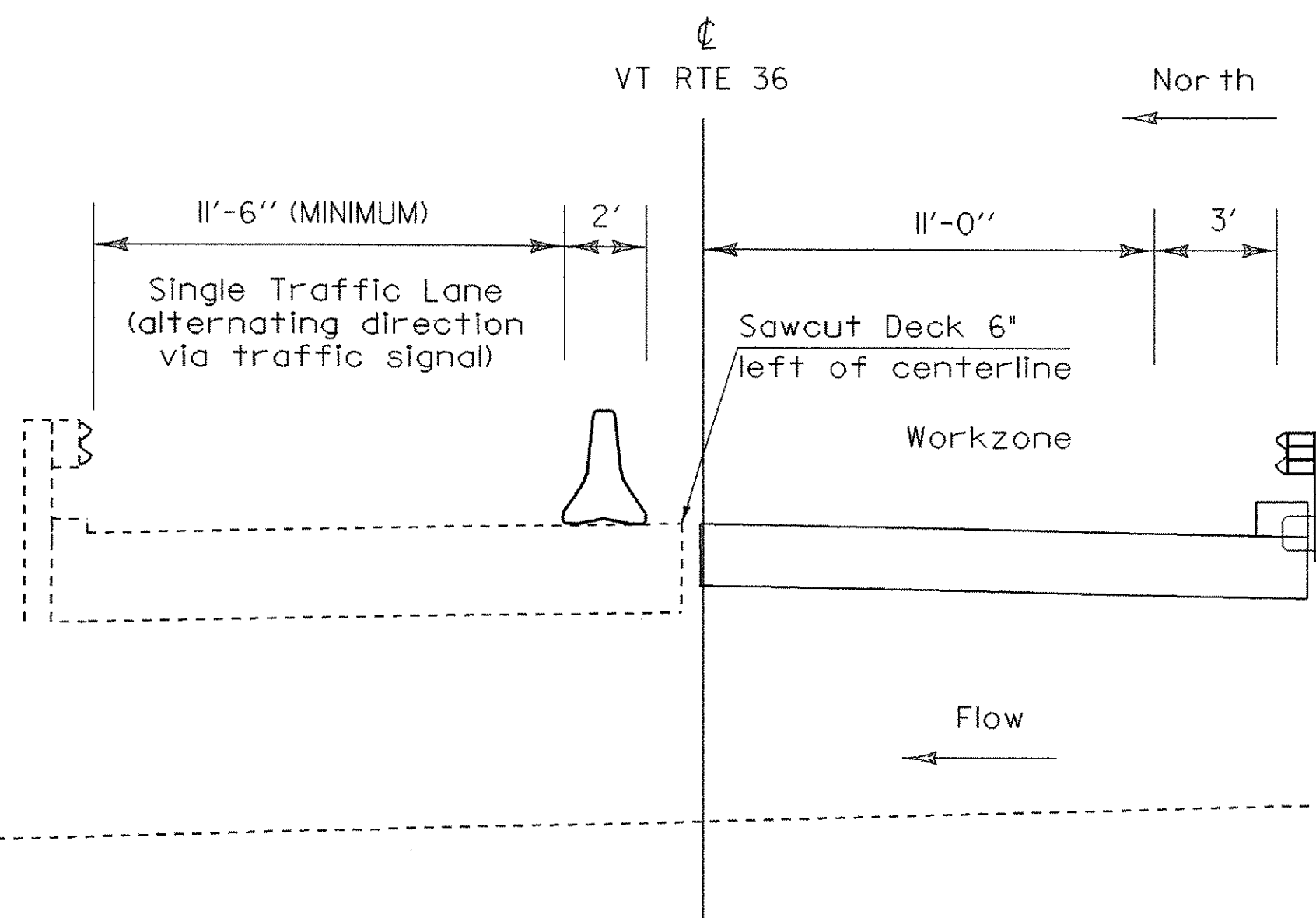

Phase One

Remove eastbound lane of existing concrete deck, existing temporary concrete barrier, and existing steelbeam. Construct upstream half of new bridge including wingwalls, stone fill, and new guardrail.

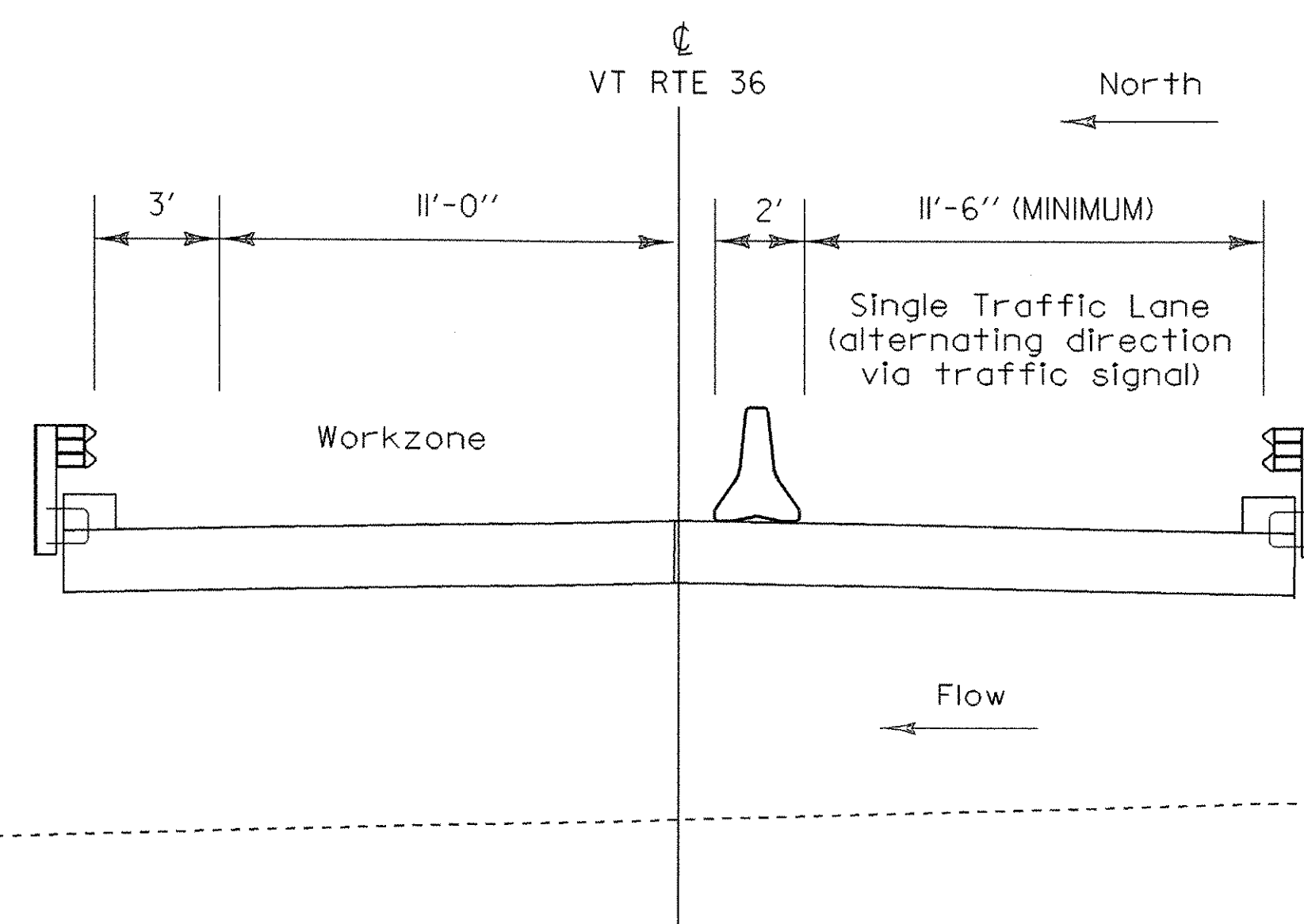

Phase Two

Traffic is transferred over to eastbound lane. Remove remaining portion of existing concrete deck. Construct second half of new bridge.

Approx. streambed

Approx. streambed

Approx. streambed

Not to Scale

PHASING SEQUENCE

PROJECT NAME:	Fairfield	PLOT DATE:	28-APR-2005
PROJECT NUMBER:	AC STP ST 0298(6)	DRAWN BY:	G. Shangraw
FILE NAME:	str5/01cl82/scl82bdr.dgn	DESIGNED BY:	J. Reed
PROJECT LEADER:	C. Keller	CHECKED BY:	W.B. Symonds
sci82stage.i			SHEET 10 OF 41