

DURABLE 4 INCH WHITE LINE
 (ALL LINES WILL INCLUDE EDGE LINE BREAKS AND
 RADII FOR SIDE ROADS)
 STA. 57+50 TO 63+50, SOLID LT & RT

DURABLE 4 INCH YELLOW LINE
 (ALL LINES WILL INCLUDE C BREAKS FOR SIDE ROADS)
 STA. 57+50 TO 63+50, SOLID LT & RT

TEMPORARY 4 INCH WHITE LINE, PAINT
 (ALL LINES WILL INCLUDE EDGE LINE BREAKS AND
 RADII FOR SIDE ROADS)
 STA. 57+50 TO 63+50, SOLID LT & RT

TEMPORARY 4 INCH YELLOW LINE, PAINT
 (ALL LINES WILL INCLUDE C BREAKS FOR SIDE ROADS)
 STA. 57+50 TO 63+50, SOLID LT & RT

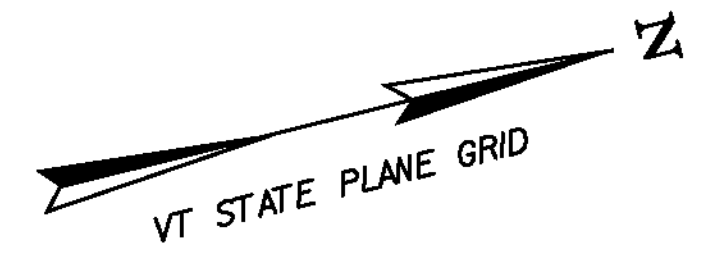

CURVE #4
 PC = 46+65.30
 PT = 58+37.53
 R = 14000'
 $\Delta = 4^{\circ}47'51''$, LT
 $D = 0^{\circ}24'33''$
 $e = \text{NONE}$
 $L = 1172.24'$

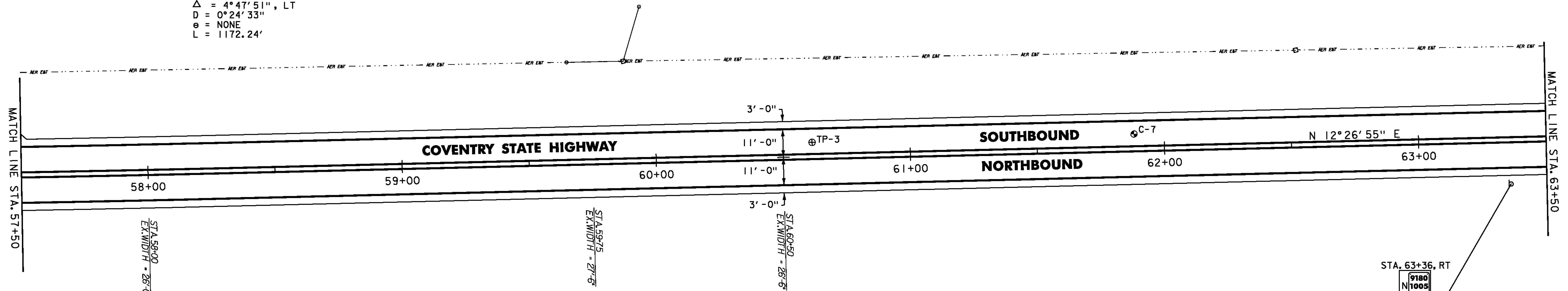

PAVEMENT CORE DATA			
CORE#	DEPTH (FT.)	PCC	COMMENTS
C-7	4 3/4"	NO	

STEEL BEAM GUARDRAIL, GALVANIZED
 STA. 66+65.5 TO 69+50.0, RT

REMOVAL AND DISPOSAL OF GUARDRAIL
 STA. 68+04 TO 69+50, RT

DURABLE 4 INCH WHITE LINE
 (ALL LINES WILL INCLUDE EDGE LINE BREAKS AND
 RADII FOR SIDE ROADS)
 STA. 63+50 TO 69+50, SOLID LT & RT

DURABLE 4 INCH YELLOW LINE
 (ALL LINES WILL INCLUDE C BREAKS FOR SIDE ROADS)
 STA. 63+50 TO 69+50, SOLID LT & RT

TEMPORARY 4 INCH YELLOW LINE, PAINT
 (ALL LINES WILL INCLUDE C BREAKS FOR SIDE ROADS)
 STA. 63+50 TO 69+50, SOLID LT & RT

ANCHOR FOR STEEL BEAM RAIL
 STA. 66+65.5, RT

TEMPORARY 4 INCH WHITE LINE, PAINT
 (ALL LINES WILL INCLUDE EDGE LINE BREAKS AND
 RADII FOR SIDE ROADS)
 STA. 63+50 TO 69+50, SOLID LT & RT

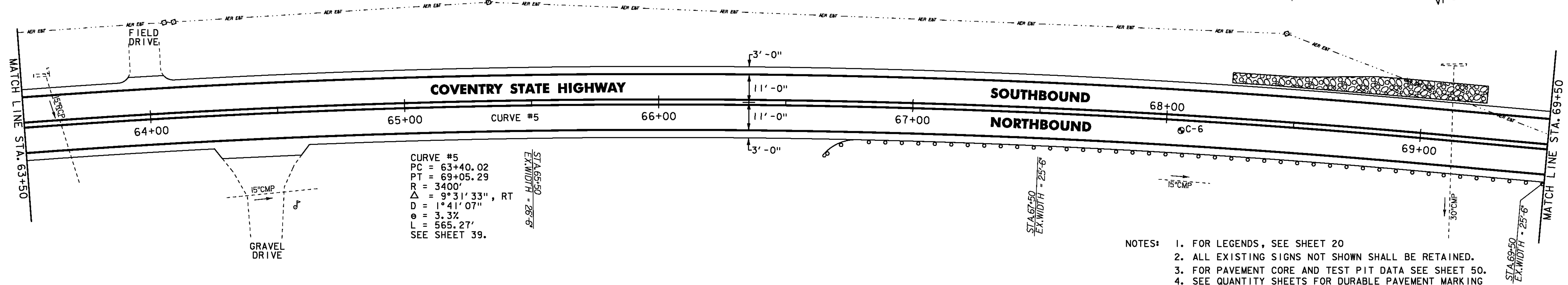
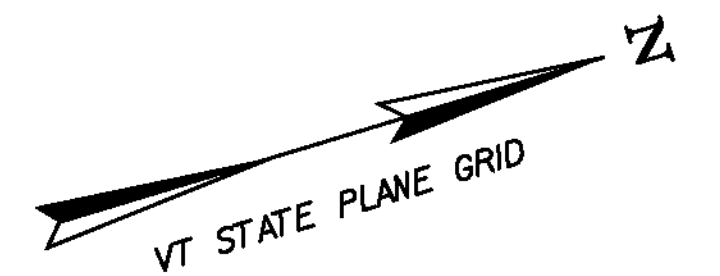

CURVE #5
 PC = 63+40.02
 PT = 69+05.29
 R = 3400'
 $\Delta = 9^{\circ}31'33''$, RT
 $D = 1^{\circ}41'07''$
 $e = 3.3\%$
 $L = 565.27'$
 SEE SHEET 39.

PAVEMENT CORE DATA			
CORE#	DEPTH (FT.)	PCC	COMMENTS
C-6	5"	NO	BOTTOM 1" STRIPPED

- NOTES:
1. FOR LEGENDS, SEE SHEET 20
 2. ALL EXISTING SIGNS NOT SHOWN SHALL BE RETAINED.
 3. FOR PAVEMENT CORE AND TEST PIT DATA SEE SHEET 50.
 4. SEE QUANTITY SHEETS FOR DURABLE PAVEMENT MARKING OPTIONS.

NOT TO SCALE



PROJECT LAYOUT SHEET #6

PROJECT NAME: COVENTRY-NEWPORT CITY
 PROJECT NUMBER: STP 2308(I)

FILE NAME: p01c052.dgn
 PROJECT LEADER: JLL
 DESIGNED BY: STANTEC
 IPARM FILE: p01c052106.i

PLOT DATE: 18-MAY-2012
 DRAWN BY: STANTEC
 CHECKED BY: STANTEC
 SHEET 25 OF 107