

646.406 DURABLE 4 INCH WHITE LINE, RECESSED POLYUREA
 (ALL LINES WILL INCLUDE EDGE LINE BREAKS AND RADIUS FOR TOWN HIGHWAYS)
 ARLINGTON:
 STA 336+50.00 - STA 339+43.00 LT & RT
 STA 344+42.00 - STA 350+27.52 LT & RT

646.416 DURABLE 4 INCH WHITE LINE, RECESSED POLYUREA
 (ALL LINES WILL INCLUDE C/L BREAKS FOR TOWN HIGHWAYS) S=SOLID, D=DASHED
 ARLINGTON:
 STA 336+50.00 - STA 339+43.00 LT S S RT S
 STA 344+42.00 - STA 350+27.52 S - S
 STA 347+58.24 DOUBLE SOLID RT, TH-36

646.446 DURABLE 8 INCH WHITE LINE, RECESSED POLYUREA
 ARLINGTON:
 STA 338+34.0 - STA 338+46.0 FIRE HYDRANT NO PARKING, RT
 646.481 DURABLE 24 INCH STOP BAR, TYPE ITAPE
 ARLINGTON:
 STA 347+58.24 RT, TH-36

646.692 TEMPORARY LETTER OR SYMBOL, PAINT
 ARLINGTON:
 STA 345+45.00 RT, "S,T,O,P" (8 EA)
 STA 345+85.00 RT, "A,H,E,A,D" (10 EA)
 STA 347+58.24 RT, TH-36 "S,T,O,P" (8 EA)

675.150 REMOVING SIGNS AS SHOWN - 23 28

646.602 TEMPORARY 4 INCH WHITE LINE, PAINT
 (ALL LINES WILL INCLUDE EDGE LINE BREAKS AND RADIUS FOR TOWN HIGHWAYS)
 ARLINGTON:
 STA 336+50.00 - STA 339+43.00 LT & RT
 STA 344+42.00 - STA 350+27.52 LT & RT

646.612 TEMPORARY 4 INCH YELLOW LINE, PAINT
 (ALL LINES WILL INCLUDE C/L BREAKS FOR TOWN HIGHWAYS) S=SOLID, D=DASHED
 ARLINGTON:
 STA 336+50.00 - STA 339+43.00 LT S S RT S
 STA 344+42.00 - STA 350+27.52 S - S
 STA 347+58.24 DOUBLE SOLID RT, TH-36

646.682 TEMPORARY 24 INCH STOP BAR, PAINT
 ARLINGTON:
 STA 347+58.24 RT, TH-36

646.491 DURABLE LETTER OR SYMBOL, TYPE ITAPE
 ARLINGTON:
 STA 345+45.00 RT, "S,T,O,P" (4 EA)
 STA 345+85.00 RT, "A,H,E,A,D" (5 EA)
 STA 347+58.24 RT, TH-36 "S,T,O,P" (4 EA)

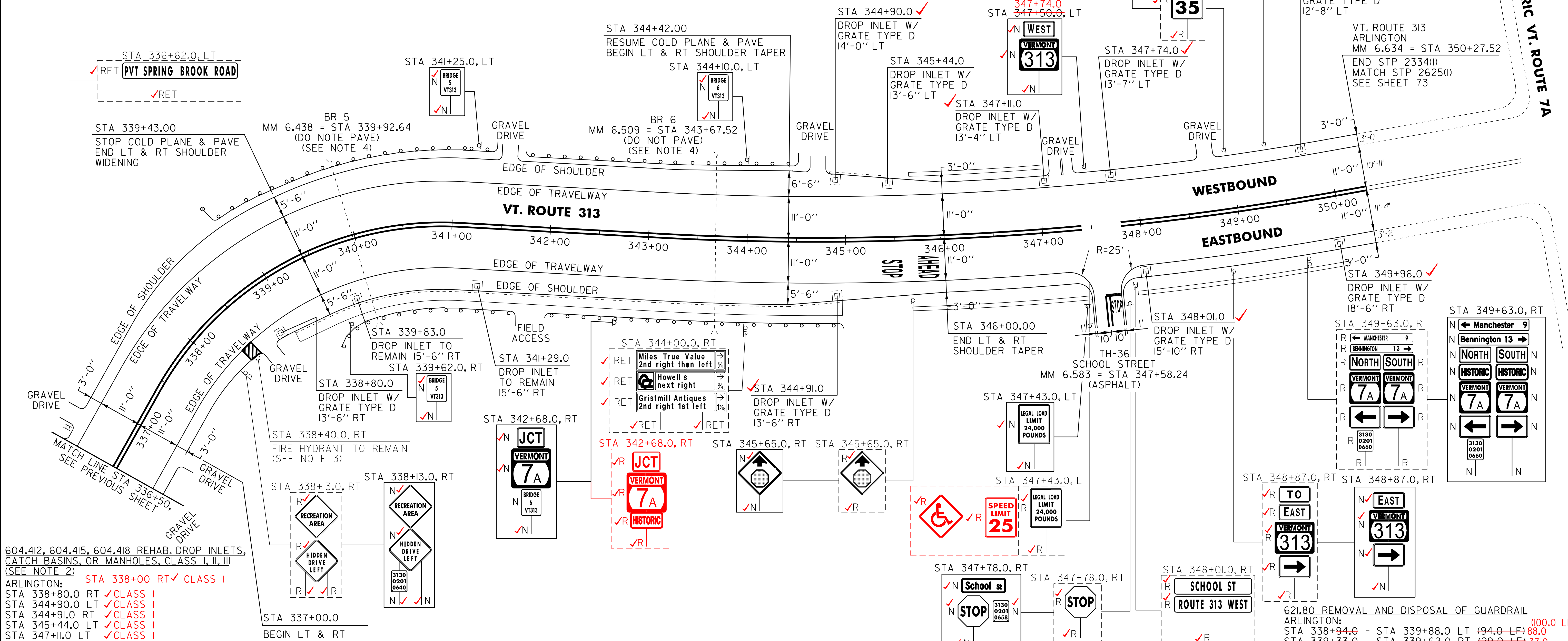

604.412, 604.415, 604.418 REHAB. DROP INLETS, CATCH BASINS, OR MANHOLES, CLASS I, II, III (SEE NOTE 2)
 ARLINGTON:
 STA 338+00.0 RT ✓ CLASS I
 STA 344+90.0 LT ✓ CLASS I
 STA 344+91.0 RT ✓ CLASS I
 STA 345+44.0 LT ✓ CLASS I
 STA 347+11.0 LT ✓ CLASS I
 STA 347+74.0 LT ✓ CLASS I
 STA 348+01.0 RT ✓ CLASS I
 STA 349+72.0 RT ✓ CLASS I
 STA 349+96.0 RT ✓ CLASS II

STA 337+00.0
 BEGIN LT & RT SHOULDER WIDENING

621.60 ANCHOR FOR STEEL BEAM RAIL
 ARLINGTON:
 STA 339+41.5 RT ✓ STA 341+85.0 LT
 STA 339+45.5 LT ✓ STA 342+10.0 RT
 STA 339+49.5 RT ✓
 STA 341+30.5 LT ✓
 STA 341+38.5 LT ✓
 STA 341+55.0 RT ✓
 STA 341+65.5 RT ✓
 STA 341+97.5 LT ✓
 STA 341+59.5 RT ✓
 STA 342+55.5 LT ✓
 STA 342+55.5 RT ✓
 STA 344+50.5 LT ✓
 STA 344+22.5 LT ✓
 STA 344+22.5 RT ✓
 STA 344+83.0 RT ✓

621.20 STEEL BEAM GUARDRAIL, GALVANIZED
 ARLINGTON:
 STA 339+38.0 ✓ - STA 339+88.0 LT ✓ (50.0 LF)
 STA 339+35.0 ✓ - STA 339+62.0 RT ✓ (27.0 LF)
 STA 341+25.0 ✓ - STA 341+45.0 LT (27.0 LF) ✓ 52.0
 STA 341+53.0 ✓ - STA 341+61.5 RT (44.5 LF) ✓ 74.0 (27.0 LF)
 STA 341+91.0 ✓ - STA 342+68.0 LT ✓ (77.0 LF) ✓ 66.0 (89.5 LF)
 STA 341+99.0 ✓ - STA 342+68.0 RT ✓ (77.0 LF) ✓ 342+01.0
 STA 344+10.0 ✓ - STA 344+57.0 LT ✓ (52.0 LF) ✓ 62.0
 STA 344+10.0 ✓ - STA 344+99.5 RT ✓ (89.5 LF)

621.50 MANUFACTURED TERMINAL SECTION, FLARED
 ARLINGTON:
 STA 339+00.5 ✓ - STA 339+38.0 LT ✓

- NOTES:
- PAVING LIMIT ON ALL TOWN HIGHWAYS SHALL BE MEASURED 25 FT BACK FROM VT. ROUTE 313 EDGE OF SHOULDER UNLESS DENOTED OTHERWISE ON THE PLANS OR AS DIRECTED BY THE RESIDENT ENGINEER.
 - THE CONTRACTOR SHALL REHAB. THE EXISTING DROP INLETS, CATCH BASINS OR MANHOLES TO A DEPTH AS DIRECTED BY THE RESIDENT ENGINEER. ALL REHAB. WORK WILL BE PAID FOR UNDER THE APPLICABLE REHAB. ITEM AS DIRECTED BY THE RESIDENT ENGINEER. ALL EXISTING UTILITIES MARKED "TO REMAIN" SHALL NOT BE ALTERED OR REHABILITATED UNLESS DIRECTED OTHERWISE BY THE RESIDENT ENGINEER.
 - SEE SHEET 6 FOR FIRE HYDRANT PAVEMENT MARKING DETAILS.
 - SEE SHEETS 54 & 55 FOR BRIDGE 5 & BRIDGE 6 DETAILS.

SIGN LEGEND
 R = REMOVE
 S = SALVAGE
 N = NEW
 RET = RETAIN
 B-B = BACK TO BACK
 EXISTING BY: - - - - -
 NEW = _____

PROJECT LAYOUT SHEET #16	PROJECT NAME: ARLINGTON	PLOT DATE: 20-FEB-2013 16:40
	PROJECT NUMBER: STP 2334(I)	DRAWN BY: C.A.K.
	FILE NAME: OIC042.dgn	CHECKED BY: D.W.E.
	PROJECT LEADER: D.E.G.	SHEET 32 OF 143

NOT TO SCALE

621.80 REMOVAL AND DISPOSAL OF GUARDRAIL
 ARLINGTON:
 STA 338+94.0 - STA 339+88.0 LT (94.0 LF) (100.0 LF)
 STA 339+33.0 - STA 339+62.0 RT (29.0 LF) 37.0
 65.0 (12.5 LF) STA 341+25.0 - STA 341+45.0 LT (20.0 LF) (25.0 LF)
 72.5 (87.5 LF) STA 341+53.0 - STA 341+61.5 RT (8.0 LF)
 74.0 (75.0 LF) STA 341+99.0 - STA 342+68.0 RT (69.0 LF)
 60.0 (50.0 LF) STA 344+10.0 - STA 344+57.0 LT (47.0 LF)
 97.5 (87.5 LF) STA 344+10.0 - STA 344+94.0 RT (84.0 LF)

676.10 DELINEATOR WITH STEEL POST
 ARLINGTON:
 STA 339+00.5 LT