

646.406 DURABLE 4 INCH WHITE LINE, RECESSED POLYUREA
 (ALL LINES WILL INCLUDE EDGE LINE BREAKS AND RADIUS FOR TOWN HIGHWAYS)
 ARLINGTON:
 STA 26+00.00 - STA 54+50.00 LT & RT

646.602 TEMPORARY 4 INCH WHITE LINE, PAINT
 (ALL LINES WILL INCLUDE EDGE LINE BREAKS AND RADIUS FOR TOWN HIGHWAYS)
 ARLINGTON:
 STA 26+00.00 - STA 54+50.00 LT & RT

646.416 DURABLE 4 INCH YELLOW LINE, RECESSED POLYUREA
 (ALL LINES WILL INCLUDE C/L BREAKS FOR TOWN HIGHWAYS) S=SOLID, D=DASHED
 ARLINGTON:
 STA 26+00.00 - STA 35+40.00
 STA 35+40.00 - STA 41+00.00
 STA 41+00.00 - STA 45+30.00
 STA 45+30.00 - STA 51+75.00
 STA 51+75.00 - STA 54+50.00

LT	CL	RT
S	-	S
S	-	D
-	D	-
D	-	S
S	-	S

646.612 TEMPORARY 4 INCH YELLOW LINE, PAINT
 (ALL LINES WILL INCLUDE C/L BREAKS FOR TOWN HIGHWAYS) S=SOLID, D=DASHED
 ARLINGTON:
 STA 26+00.00 - STA 35+40.00
 STA 35+40.00 - STA 41+00.00
 STA 41+00.00 - STA 45+30.00
 STA 45+30.00 - STA 51+75.00
 STA 51+75.00 - STA 54+50.00

LT	CL	RT
S	-	S
S	-	D
-	D	-
D	-	S
S	-	S

675.50 REMOVING SIGNS AS SHOWN - 8
 9✓

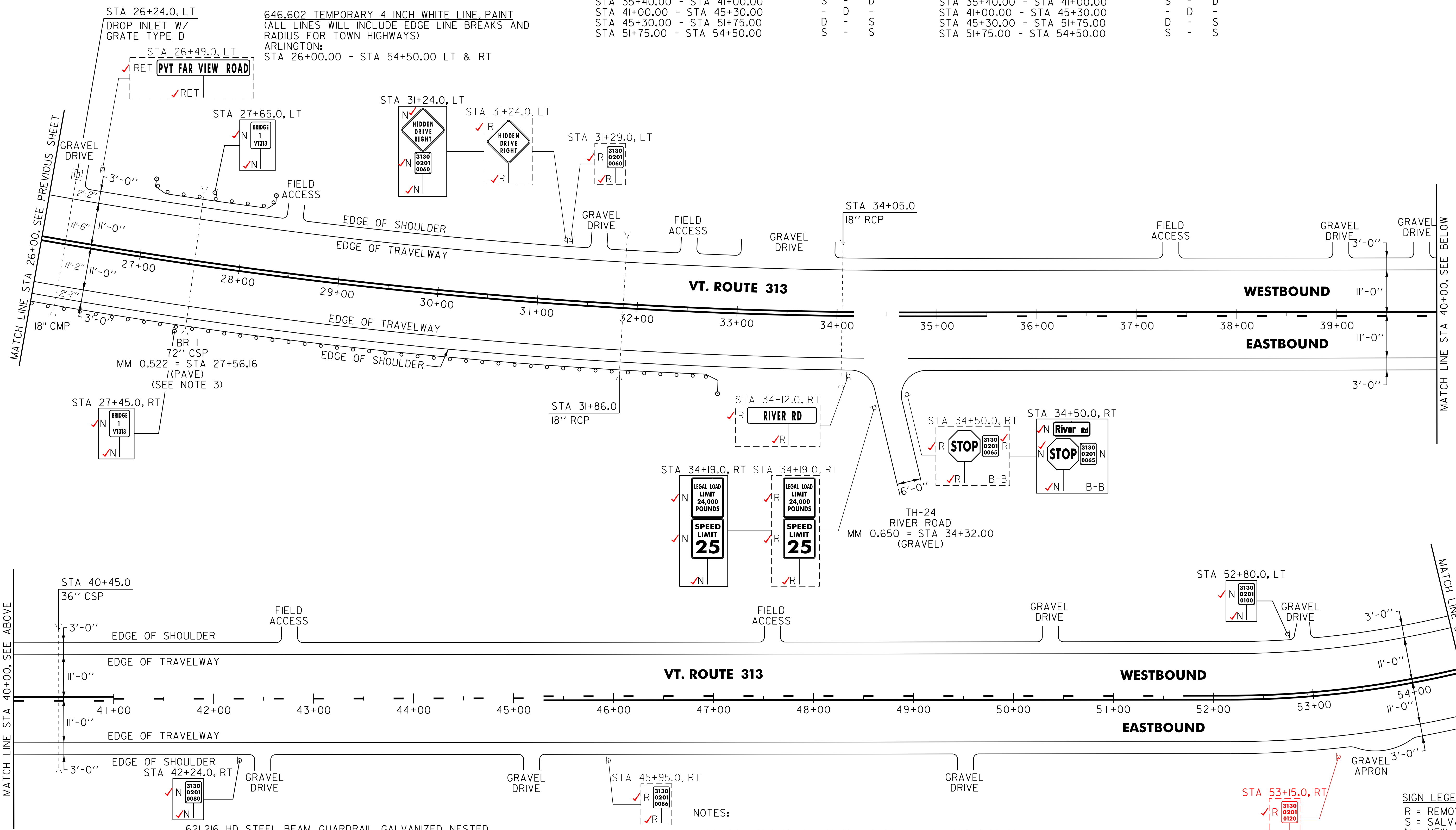

604.412, 604.415, 604.418 REHAB. DROP INLETS, CATCH BASINS, OR MANHOLES, CLASS I, II, III (SEE NOTE 2)
 ARLINGTON:
 STA 26+24.0 LT

621.20 STEEL BEAM GUARDRAIL, GALVANIZED
 ARLINGTON:
 STA 26+00.0 ✓ - STA 27+42.5 RT (42.5 LF)
 STA 27+67.5 ✓ - STA 27+92.5 LT (25.0 LF)
 STA 27+67.5 - STA 32+42.5 RT (475.0 LF)

621.216 HD STEEL BEAM GUARDRAIL, GALVANIZED, NESTED
 ARLINGTON:
 STA 27+42.5 ✓ - STA 27+67.5 LT (25.0 LF) ✓
 STA 27+42.5 - STA 27+67.5 RT (25.0 LF)

621.50 MANUFACTURED TERMINAL SECTION, FLARED
 ARLINGTON:
 STA 27+05.0 ✓ - STA 27+42.5 LT ✓
 STA 27+92.5 ✓ - STA 28+30.0 LT ✓
 STA 32+42.5 ✓ - STA 32+80.0 RT ✓

621.80 REMOVAL AND DISPOSAL OF GUARDRAIL
 ARLINGTON:
 STA 26+00.0 - STA 32+80.0 RT (680.0 LF)
 STA 27+43.0 - STA 28+28.0 LT (85.0 LF) 30.5 (87.5 LF)

676.10 DELINEATOR WITH STEEL POST
 ARLINGTON:
 STA 27+05.0 LT
 STA 28+30.0 LT
 STA 32+80.0 RT

- NOTES:
- PAVING LIMIT ON ALL TOWN HIGHWAYS SHALL BE MEASURED 25 FT BACK FROM VT. ROUTE 313 EDGE OF SHOULDER UNLESS DENOTED OTHERWISE ON THE PLANS OR AS DIRECTED BY THE RESIDENT ENGINEER.
 - THE CONTRACTOR SHALL REHAB. THE EXISTING DROP INLETS, CATCH BASINS OR MANHOLES TO A DEPTH AS DIRECTED BY THE RESIDENT ENGINEER. ALL REHAB. WORK WILL BE PAID FOR UNDER THE APPLICABLE REHAB. ITEM AS DIRECTED BY THE RESIDENT ENGINEER. ALL EXISTING UTILITIES MARKED "TO REMAIN" SHALL NOT BE ALTERED OR REHABILITATED UNLESS DIRECTED OTHERWISE BY THE RESIDENT ENGINEER.
 - SEE SHEET 6 FOR STEEL BEAM GUARDRAIL AT SMALL CULVERT DETAIL.

NOT TO SCALE

PROJECT LAYOUT SHEET #2

PROJECT NAME:	ARLINGTON	FILE NAME:	OIC042.dgn	PLOT DATE:	20-FEB-2013 16:40
PROJECT NUMBER:	STP 2334(1)	PROJECT LEADER:	D.E.G.	DRAWN BY:	C.A.K.
		DESIGNED BY:	M.J.M.	CHECKED BY:	D.W.E.
		IPARM FILE:	p01c042102.i	SHEET	18 OF 143

SIGN LEGEND
 R = REMOVE
 S = SALVAGE
 N = NEW
 RET = RETAIN
 B-B = BACK TO BACK
 EXISTING = - - - - -
 NEW = _____