

TEMPORARY 4" WHITE LINE, PAINT  
 DURABLE 6" WHITE LINE, RECESSED POLYUREA  
 B 5+50 TO B 5+77 SOLID LT (LANE LINE)

TEMPORARY 4" WHITE LINE, PAINT  
 DURABLE 4" WHITE LINE, THERMOPLASTIC  
 B 5+50 TO B 6+30 SOLID LT & RT  
 B 5+50 TO B 6+30 DASHED RT  
 B 5+77 TO B 6+30 DASHED LT

TEMPORARY 4" YELLOW LINE, PAINT  
 DURABLE 6" YELLOW LINE, THERMOPLASTIC  
 B 5+50 TO B 6+30 SOLID LT & RT

RECESSED POLYUREA

TEMPORARY LETTER OR SYMBOL, PAINT  
 DURABLE LETTER OR SYMBOL, THERMOPLASTIC  
 5+68 LT - ROUNDABOUT ARROW  
 5+73 LT - RIGHT/THRU ARROW

THINNING AND TRIMMING FOR SIGNS  
 (SEE DETAIL ON SHEET 6)  
 B 5+72 LT

REMOVING SIGNS  
 AS SHOWN - 12

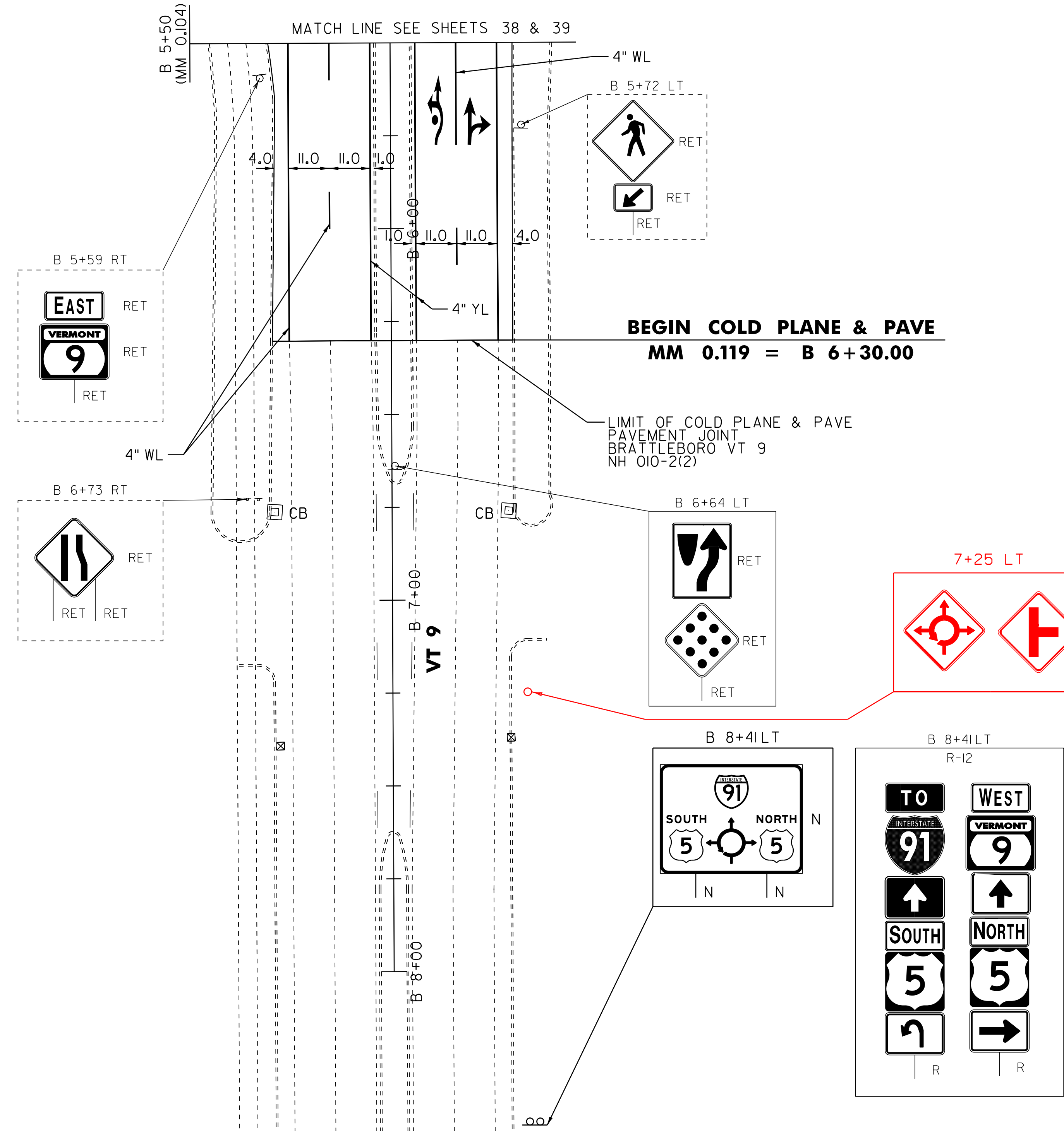

LEGEND

- R = REMOVE EXISTING
- S = SALVAGE
- R&S = REMOVE AND SALVAGE
- N = NEW
- RET = RETAIN
- B-B = BACK TO BACK
- = EXISTING GUARDRAIL
- = PROPOSED GUARDRAIL
- YL = YELLOW LINE
- WL = WHITE LINE
- o = DELINEATOR

ROADWAY LAYOUT 17C  
 VT ROUTE 9

PROJECT NAME: BRATTLEBORO-PUTNEY  
 PROJECT NUMBER: STP 2310(I)

FILE NAME: /pave/01c032/pc032  
 PROJECT LEADER: PTS  
 DESIGNED BY: NLL  
 IPARM FILE NAME: 01C032.41

PLOT DATE: 02-MAY-2012 17:2  
 DRAWN BY: WWG  
 CHECKED BY: NLL/PTS  
 SHEET 41 OF 118