

**APPROACH AREA DETAIL - TAPER**

NOT TO SCALE

RUTLAND - STA 1+50 TO 2+50 END COLD PLANING  
 RUTLAND - STA 21+30 TO 22+30 RAILROAD TRACKS  
 RUTLAND - STA 22+80 TO 23+80 RAILROAD TRACKS  
 PROCTOR - STA 94+70 TO 95+70 PROJECT END

TOWN HIGHWAY:  
 RUTLAND: TH #59 RT  
 PROCTOR: TH #55 RT  
 TH #55 RT  
 TH #56 RT  
 TH #56 RT

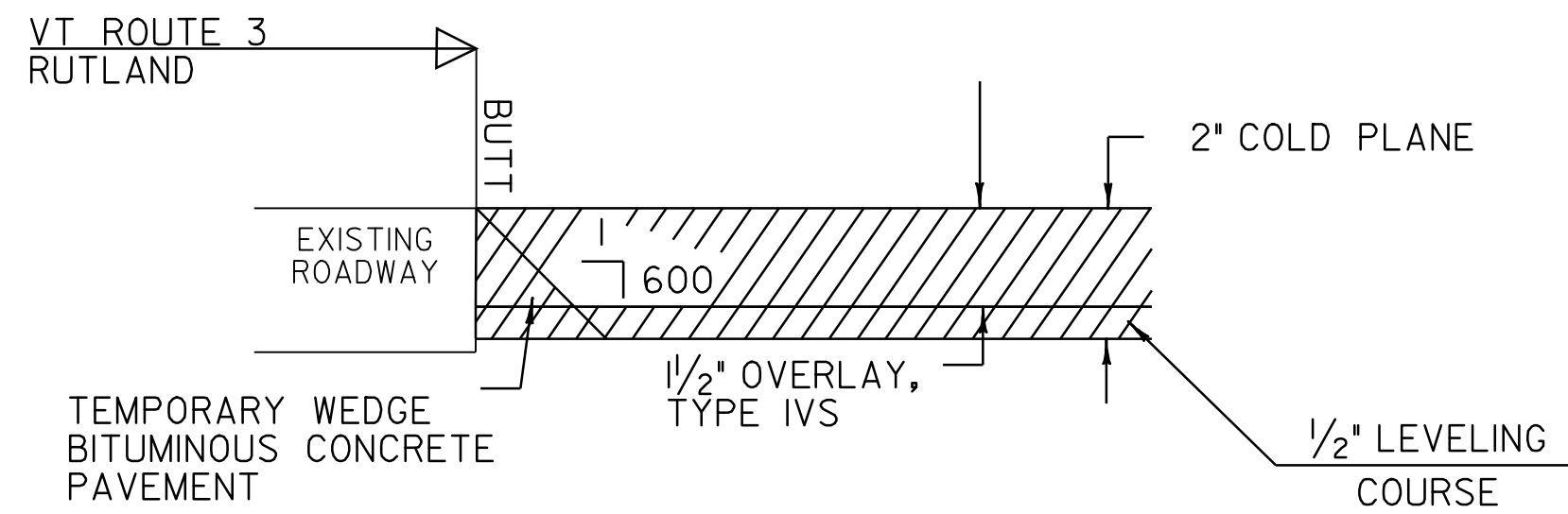

**APPROACH AREA DETAIL - BUTT**

NOT TO SCALE

LOCATION

VT RTE 3  
 STA 0+33, RUTLAND - BEGIN COLD PLANING

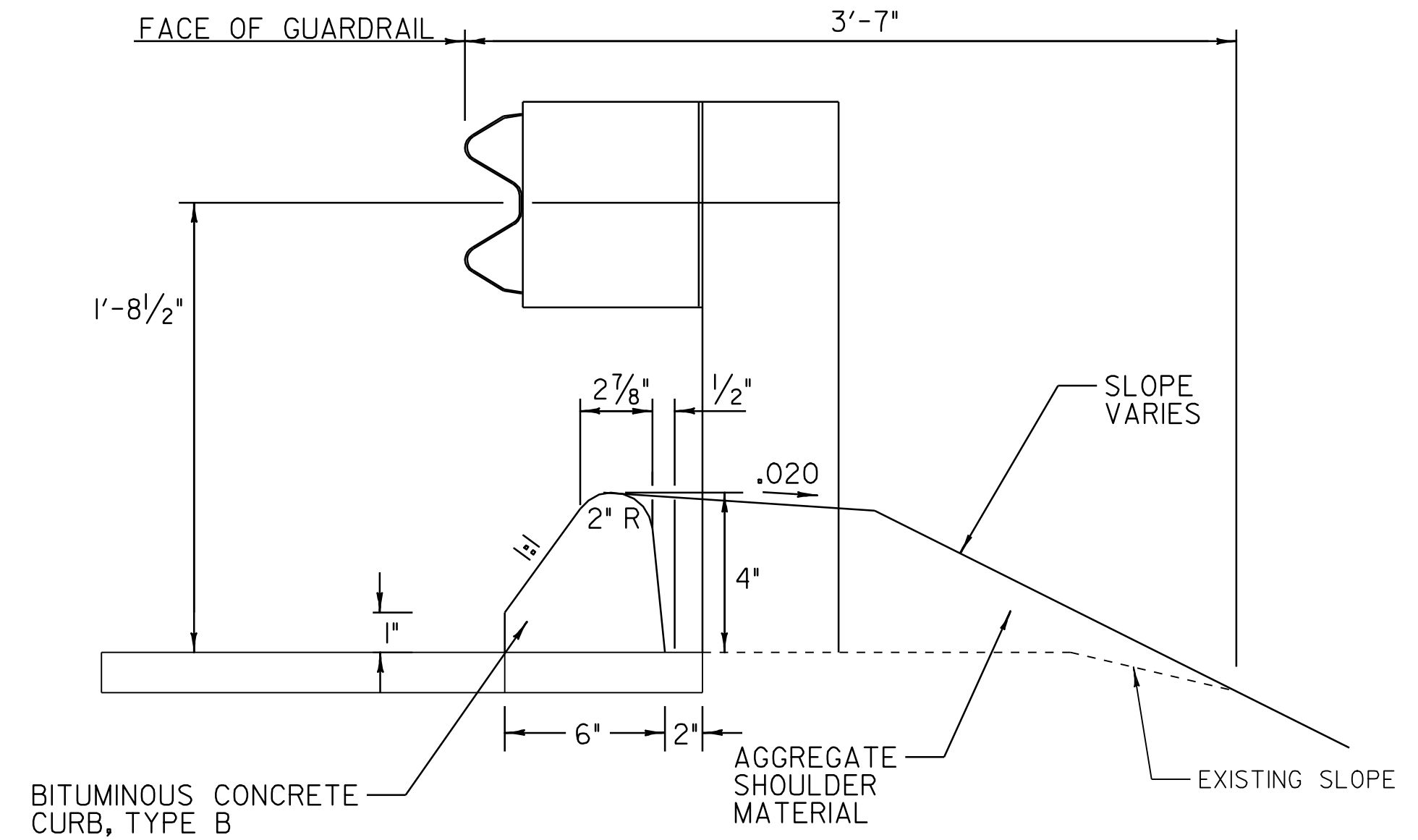

**DETAIL FOR BITUMINOUS CONCRETE CURB, TYPE B**

NOT TO SCALE

NOTE:

1. ONLY TO BE USED WITH REMOVING AND RESETTING GUARDRAIL (STEEL BEAM) OR WITH NEW STEEL BEAM GUARDRAIL
2. THE PREPARATION OF BED, PLACING AND SEALING OF BITUMINOUS CONCRETE CURB SHALL BE IN CONFORMANCE WITH SECTION 616 OF THE STANDARD SPECIFICATIONS FOR CONSTRUCTION.
3. APPROXIMATE WEIGHT OF CURB = 33.2 LBS/LF. (FOR ESTIMATING TONNAGE)

<b>DATUM</b>	
VERTICAL	N/A
HORIZONTAL	N/A

<b>PROJECT TYPICAL SHEET 2</b>	SURVEYED BY	CLD	DATE	12/05
	DRAWN BY	MWS	DATE	11/06
	SQUAD LEADER	PTS		
	DESIGN FILE NO.	pave/01C020/pc020.i		
	IPARM FILE	pc020ty02.i	DATE PLOTTED	0CT-2008 11
	PROJ. NAME	RUTLAND-PROCTOR		
	PROJ. NO.	STP 2312(1)S		
	SHEET	4	OF	33 SHEETS