

TEMPORARY 4" WHITE LINE, PAINT
 DURABLE 4" WHITE LINE, THERMOPLASTIC
 STA 385+50 TO 388+00 SOLID LT
 STA 385+50 TO 386+50 SOLID RT
 STA 386+93 TO 388+00 SOLID RT

TEMPORARY 4" YELLOW LINE, PAINT
 DURABLE 4" YELLOW LINE, THERMOPLASTIC
 STA 385+50 TO 386+55 SOLID LT & RT
 STA 386+75 DOUBLE SOLID RT (TH 93)
 STA 386+95 TO 388+00 SOLID LT & RT

TEMPORARY 24" STOP BAR, PAINT
 DURABLE 24" STOP BAR, THERMOPLASTIC
 STA 386+75 RT (TH 93)
 TEMPORARY LETTER OR SYMBOL, PAINT
 DURABLE LETTER OR SYMBOL, THERMOPLASTIC
 STA 386+84 RT - "STOP" (TH 93)

STEEL BEAM GUARDRAIL, GALVANIZED
 STA 385+50 TO 388+00 LT
 REMOVAL AND DISPOSAL OF GUARDRAIL
 STA 385+50 TO 388+00 LT

REMOVING SIGNS
 AS SHOWN - 5
 ERECTING SALVAGED SIGNS
 AS SHOWN - 1

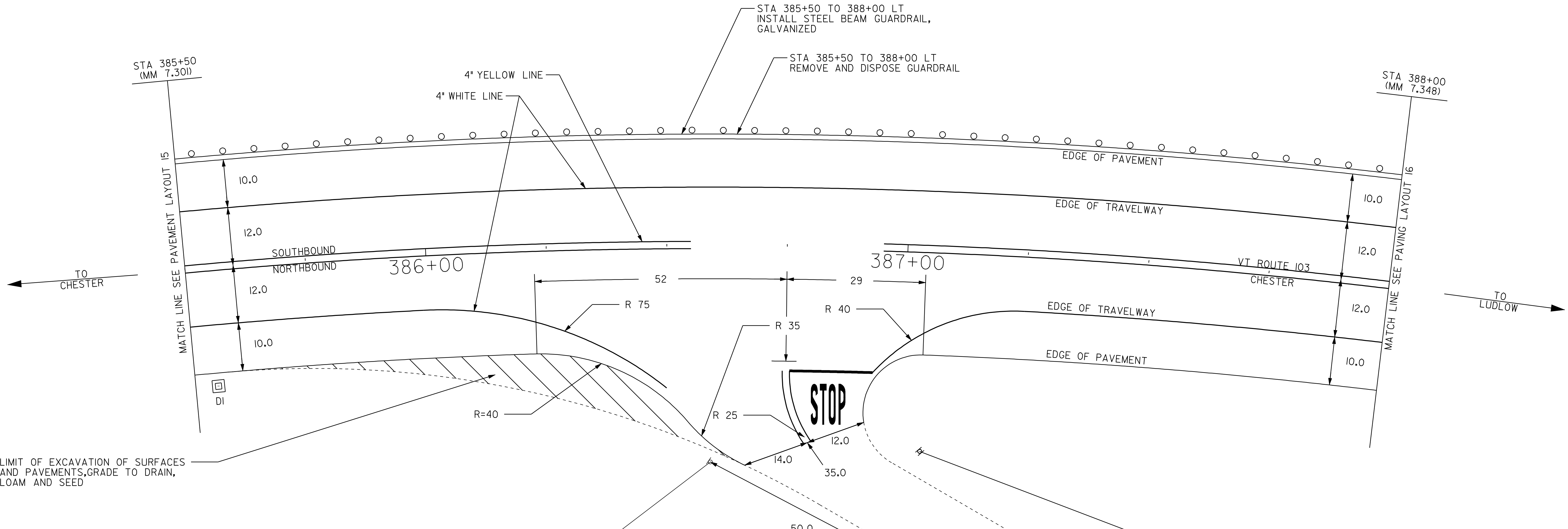

LIMIT OF EXCAVATION OF SURFACES AND PAVEMENTS, GRADE TO DRAIN, LOAM AND SEED

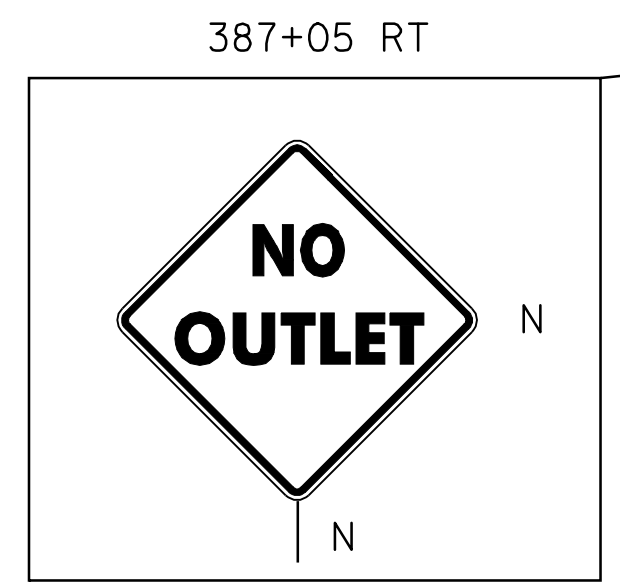
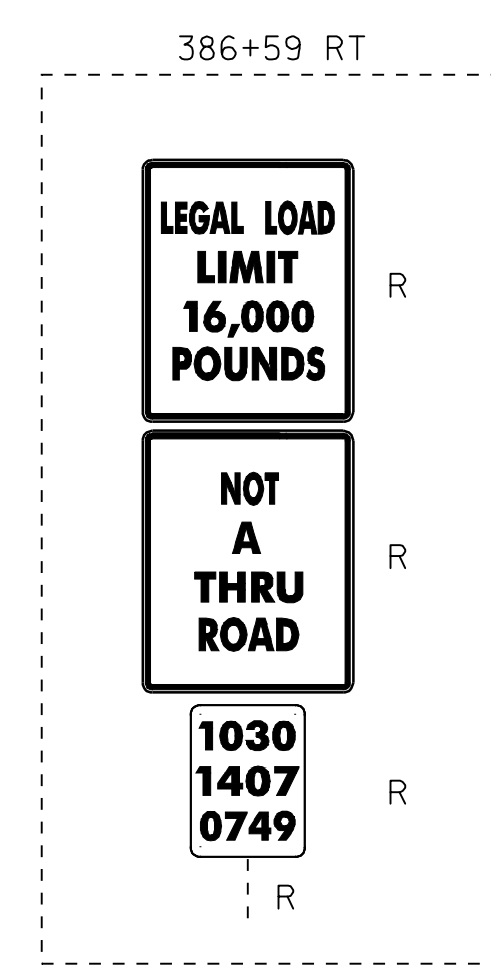
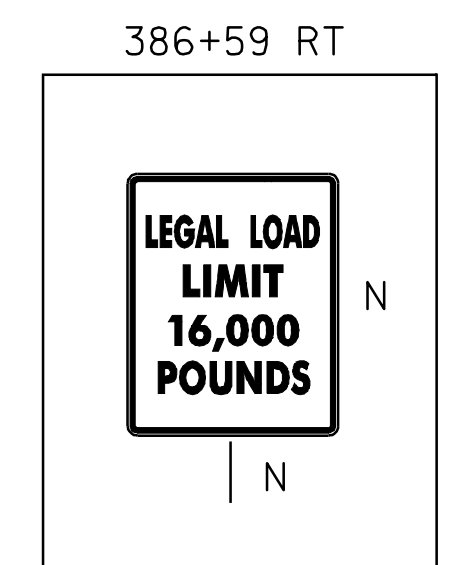

**TH 93
 STA 386+80
 MM 7.326
 PAVED**

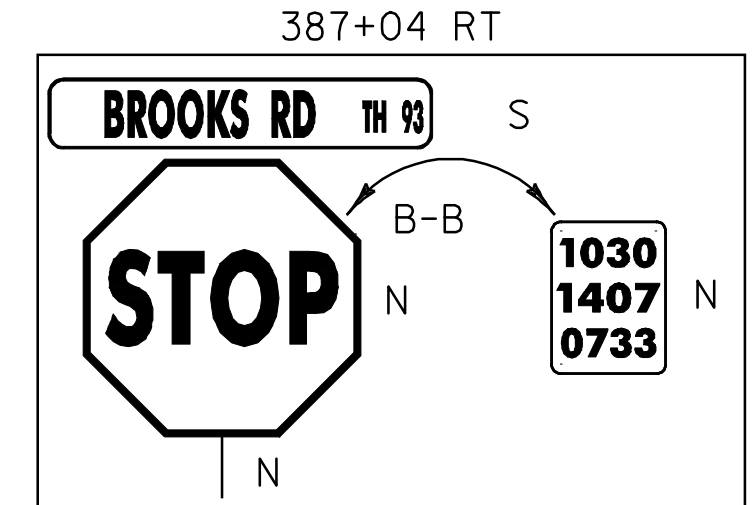
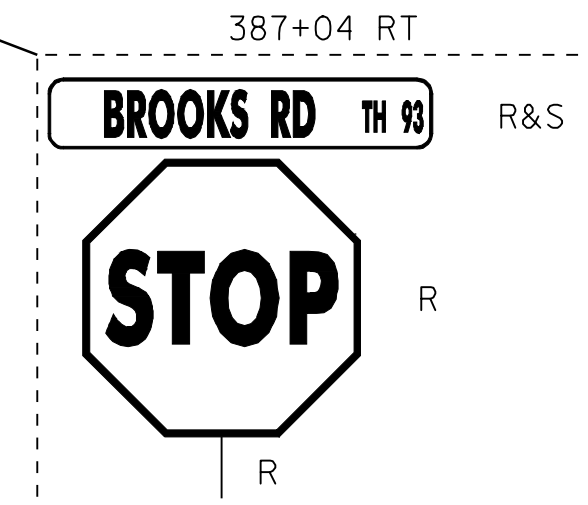

- LEGEND**
- R = REMOVE EXISTING
 - S = SALVAGE
 - R&S = REMOVE AND SALVAGE
 - N = NEW
 - RET = RETAIN
 - B-B = BACK TO BACK
 - = NEW RAIL
 - = EXISTING RAIL

**INTERSECTION
 DETAIL
 SHEET 2**

SURVEYED BY	CLD	DATE	1/05
DRAWN BY	NLL	DATE	5/05
SQUAD LEADER	CRB		
DESIGN FILE NO.	/pave/01b038/pb038.dgn		
IPARM FILE	pb0381a58.i	DATE PLOTTED	10 OCT-2009 17
PROJ. NAME	CHESTER - LUDLOW		
PROJ. NO.	NH 2326(1)S		
SHEET	72	OF	110 SHEETS