

TEMPORARY 4" WHITE LINE, PAINT  
 DURABLE 4" WHITE LINE, THERMOPLASTIC  
 STA L 20+50 TO L 29+86 SOL ID RT  
 STA L 20+50 TO L 31+50 SOL ID LT  
 STA L 30+13 TO L 31+50 SOL ID RT

TEMPORARY 24" STOP BAR, PAINT  
 DURABLE 24" STOP BAR, THERMOPLASTIC  
 STA L 30+01 RT (TH 6)

STEEL BEAM GUARDRAIL, GALVANIZED W/8 FEET POSTS  
 STA L 29+62 TO L 31+50 LT  
 STA L 30+36 TO L 31+50 RT

REMOVING SIGNS  
 AS SHOWN - 5

TEMPORARY 4" YELLOW LINE, PAINT  
 DURABLE 4" YELLOW LINE, THERMOPLASTIC  
 STA L 20+50 TO L 29+83 SOL ID LT & RT  
 STA L 30+01 DOUBLE SOL ID RT (TH 6)  
 STA L 30+23 TO L 31+50 SOL ID LT & RT

TEMPORARY LETTER OR SYMBOL, PAINT  
 DURABLE LETTER OR SYMBOL, THERMOPLASTIC  
 STA L 30+09 RT - "STOP" (TH 6)

ANCHOR FOR STEEL BEAM RAIL  
 STA L 29+62 LT  
 STA L 30+36 RT

REMOVAL AND DISPOSAL OF GUARDRAIL  
 STA L 29+62 TO L 31+50 LT  
 STA L 30+39 TO L 31+50 RT

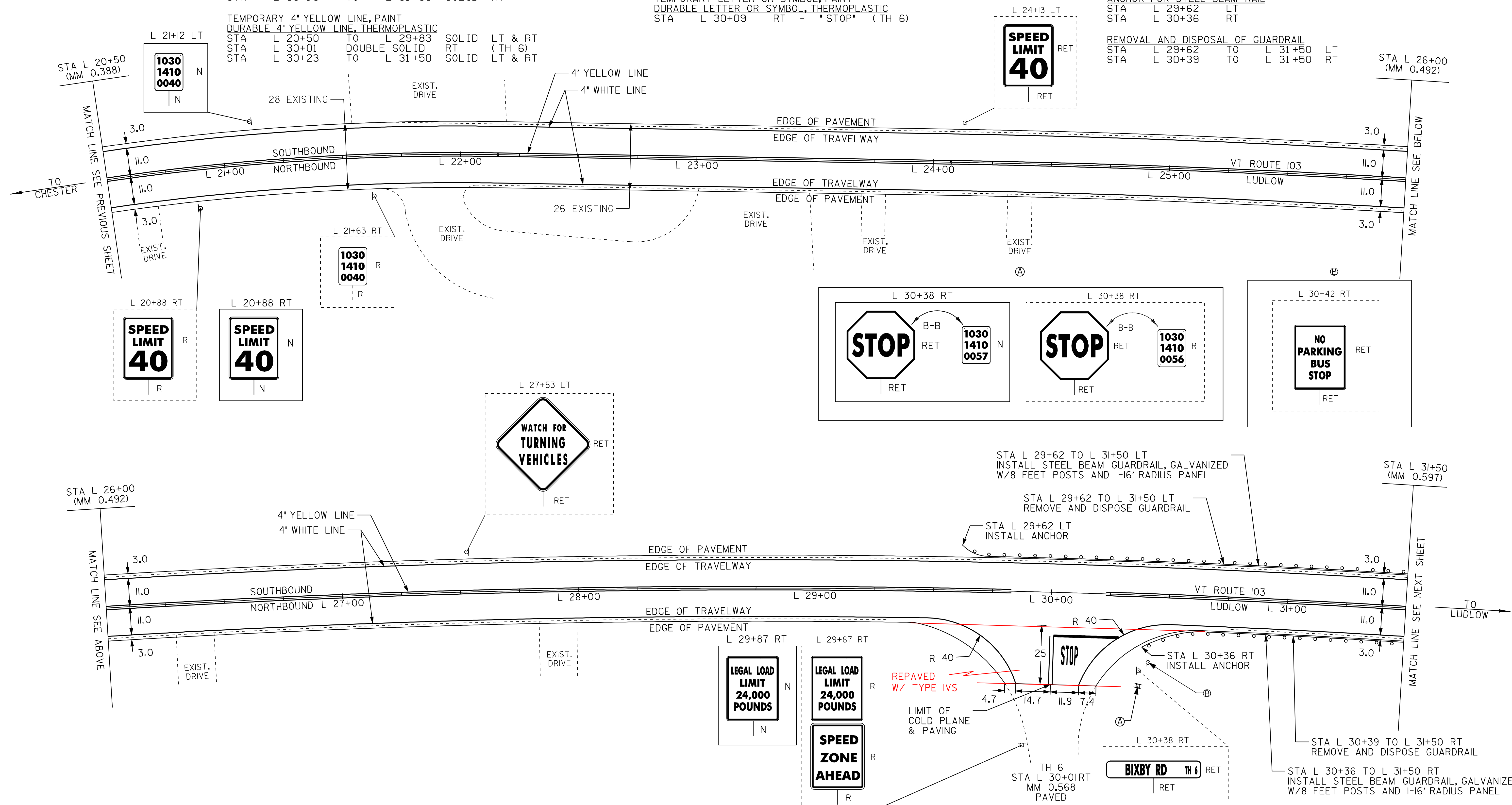

- LEGEND
- R = REMOVE EXISTING
  - S = SALVAGE
  - R&S = REMOVE AND SALVAGE
  - N = NEW
  - RET = RETAIN
  - B-B = BACK TO BACK
  - = NEW RAIL
  - = EXISTING RAIL

**PAVING PROJECT LAYOUT #52**

PROJECT: CHESTER-LUDLOW	PROJECT NO.: NH 2326(I)S
DESIGN FILE NAME: Z:\pave\01b038\pb038.dgn	PLOT DATE: 16-OCT-2009 17:
IPARM FILE NAME: pb0381a52.1	SURVEY DATE: 01/05
SURVEYED BY: CLD_ENGINEERS, INC	DRAWN BY: MRS
SQUAD LEADER: CRB	SHEET: 66 OF 110
CLD 04-0396	