

TEMPORARY 4" WHITE LINE, PAINT  
 DURABLE 4" WHITE LINE, THERMOPLASTIC  
 STA C 37+00 TO C 47+50 SOLID LT  
 STA C 37+00 TO C 47+50 SOLID RT  
 STA C 37+00 TO C 47+50 DASHED RT (LANE)

TEMPORARY 4" YELLOW LINE, PAINT  
 DURABLE 4" YELLOW LINE, THERMOPLASTIC  
 STA C 37+00 TO C 47+50 SOLID LT & RT

STEEL BEAM GUARDRAIL, GALVANIZED  
 STA C 37+00 TO C 40+88 RT  
 STA C 40+25 TO C 47+25 LT

MANUFACTURED TERMINAL SECTION, FLARED  
 STA C 40+25 LT  
 STA C 40+88 90.5 RT  
 STA C 47+25 50 LT

REMOVAL AND DISPOSAL OF GUARDRAIL  
 STA C 37+00 TO C 41+20 RT  
 STA C 39+87 TO C 47+50 LT

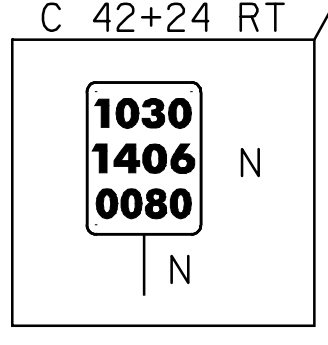
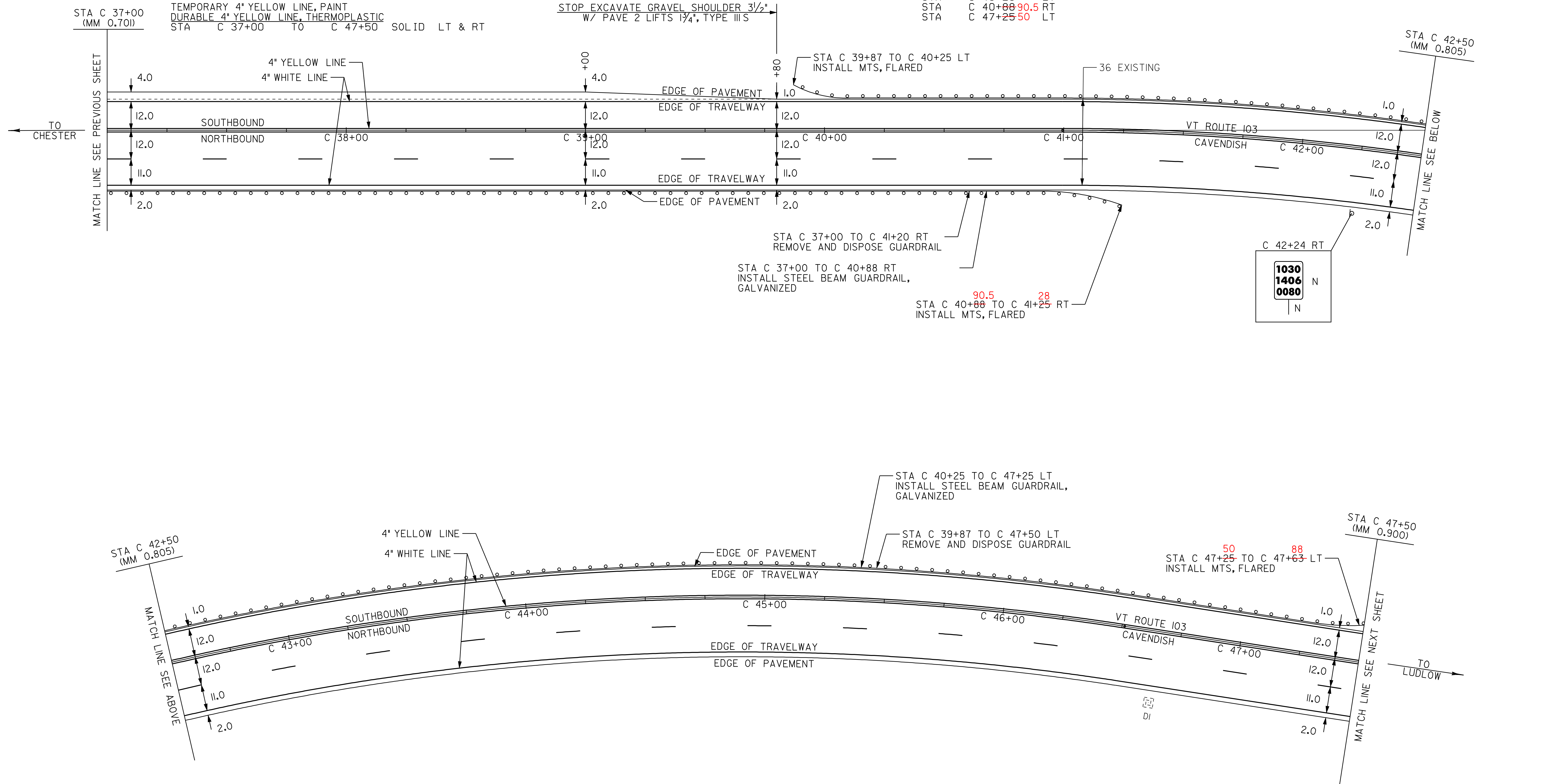

- LEGEND**
- R = REMOVE EXISTING
  - S = SALVAGE
  - R&S = REMOVE AND SALVAGE
  - N = NEW
  - RET = RETAIN
  - B-B = BACK TO BACK
  - = NEW RAIL
  - — — = EXISTING RAIL

**PAVING PROJECT LAYOUT #33**

PROJECT:	<b>CHESTER-LUDLOW</b>	PROJECT NO.:	<b>NH_2326(I)S</b>
DESIGN FILE NAME:	Z:\pave\01b\038\pb038.dgn		
IPARM FILE NAME:	pb0381a33.1	PLOT DATE:	16-OCT-2009 17:
SURVEYED BY:	CLD_ENGINEERS, INC	SURVEY DATE:	01/05
SQUAD LEADER:	CRB	DRAWN BY:	MRS
CLD_04-0396		SHEET:	47 OF 110