

TEMPORARY 4" WHITE LINE, PAINT
 DURABLE 4" WHITE LINE, THERMOPLASTIC
 STA 440+50 TO 451+50 SOLID LT
 STA 440+50 TO 451+50 SOLID RT

TEMPORARY 4" YELLOW LINE, PAINT
 DURABLE 4" YELLOW LINE, THERMOPLASTIC
 STA 440+50 TO 451+50 SOLID LT & RT

GUARDRAIL APPROACH SECTION, GALVANIZED TYPE I
 STA 443+27 TO 443+77 RT
 STA 447+11 TO 447+61 LT

REMOVAL AND DISPOSAL OF GUARDRAIL
 STA 440+50 TO 443+19 LT
 STA 441+85 TO 443+77 RT
 STA 447+11 TO 448+32 LT
 STA 447+69 TO 451+50 RT

REMOVING SIGNS
 AS SHOWN - 7

STEEL BEAM GUARDRAIL, GALVANIZED
 STA 440+50 TO 443+06 LT
 STA 442+27 TO 443+27 RT
 STA 447+61 TO 447+99 LT
 STA 447+82 TO 451+50 RT

GUARDRAIL APPROACH SECTION, GALVANIZED TYPE II
 STA 443+06 TO 443+19 LT
 STA 447+69 TO 447+82 RT

BITUMINOUS CONCRETE CURB, TYPE B
 STA 440+60 TO 443+20 LT

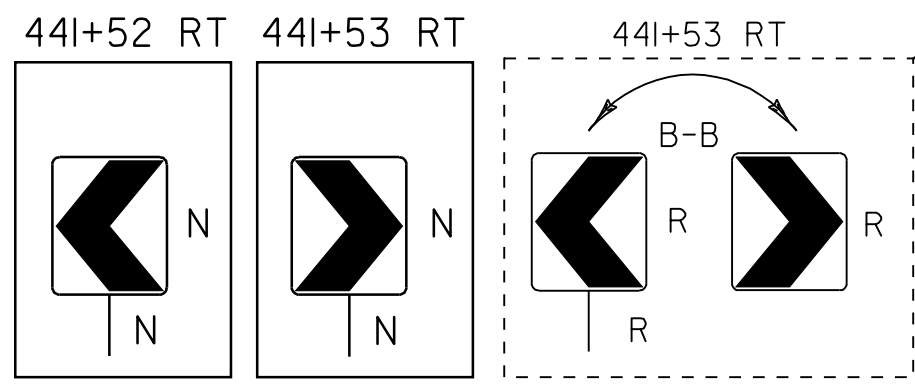
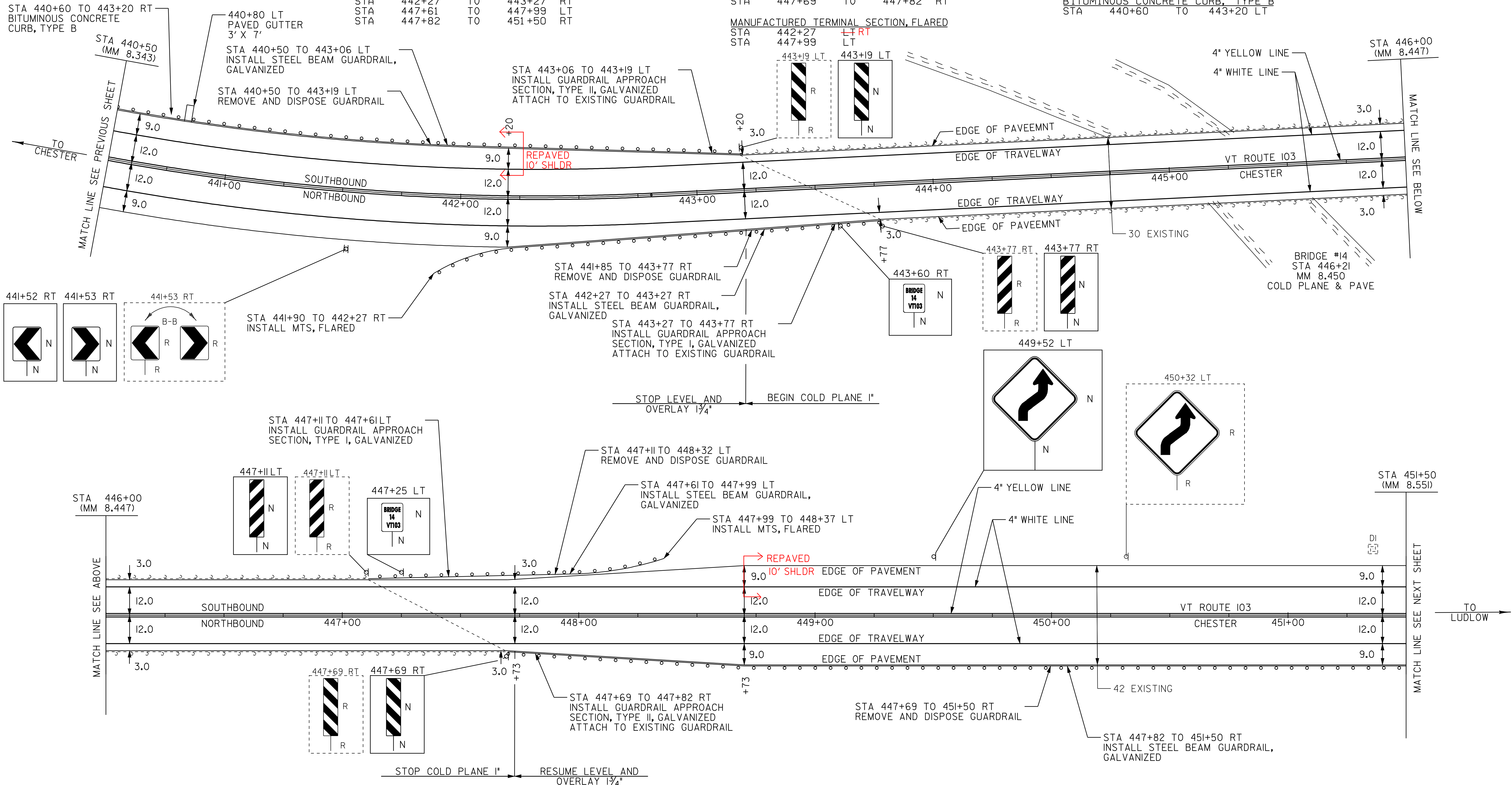

STA 441+90 TO 442+27 RT
 INSTALL MTS, FLARED

STA 441+85 TO 443+77 RT
 REMOVE AND DISPOSE GUARDRAIL

STA 442+27 TO 443+27 RT
 INSTALL STEEL BEAM GUARDRAIL,
 GALVANIZED

STA 443+27 TO 443+77 RT
 INSTALL GUARDRAIL APPROACH
 SECTION, TYPE I, GALVANIZED
 ATTACH TO EXISTING GUARDRAIL

STA 447+11 TO 447+61 LT
 INSTALL GUARDRAIL APPROACH
 SECTION, TYPE I, GALVANIZED

STA 447+11 TO 448+32 LT
 REMOVE AND DISPOSE GUARDRAIL

STA 447+61 TO 447+99 LT
 INSTALL STEEL BEAM GUARDRAIL,
 GALVANIZED

STA 447+99 TO 448+37 LT
 INSTALL MTS, FLARED

STA 447+69 TO 447+82 RT
 INSTALL GUARDRAIL APPROACH
 SECTION, TYPE II, GALVANIZED
 ATTACH TO EXISTING GUARDRAIL

STA 447+69 TO 451+50 RT
 REMOVE AND DISPOSE GUARDRAIL

STA 447+82 TO 451+50 RT
 INSTALL STEEL BEAM GUARDRAIL,
 GALVANIZED

- LEGEND**
- R = REMOVE EXISTING
 - S = SALVAGE
 - R&S = REMOVE AND SALVAGE
 - N = NEW
 - RET = RETAIN
 - B-B = BACK TO BACK
 - = NEW RAIL
 - - - = EXISTING RAIL

**PAVING
 PROJECT
 LAYOUT #23**

PROJECT: _CHESTER-LUDLOW	PROJECT NO.: _NH_2326(1)S_
DESIGN FILE NAME: Zpave\Qlb038\pb038.dgn	PLOT DATE: 16-OCT-2009 17:
IPARM FILE NAME: pb0381a23.1	SURVEY DATE: Q1205
SURVEYED BY: CLD_ENGINEERS, INC	DRAWN BY: MRS
SQUAD LEADER: CRB	SHEET: 37 OF 110
_CLD_04-0396	