

TEMPORARY 4" WHITE LINE, PAINT
 DURABLE 4" WHITE LINE, THERMOPLASTIC
 STA 233+00 TO 243+50 SOLID LT
 STA 233+00 TO 240+03 SOLID RT
 STA 240+40 TO 243+50 SOLID RT

TEMPORARY 24" STOP BAR, PAINT
 DURABLE 24" STOP BAR, THERMOPLASTIC
 STA 240+00 RT (TH 33)

STEEL BEAM GUARDRAIL, GALVANIZED
 STA 238+36 TO 241+11 LT
 238+11
 MANUFACTURED TERMINAL SECTION, FLARED
 STA 238+36 LT 238+11
 STA 241+11 LT

REMOVING SIGNS
 AS SHOWN - 2

TEMPORARY 4" YELLOW LINE, PAINT
 DURABLE 4" YELLOW LINE, THERMOPLASTIC
 STA 233+00 TO 239+80 SOLID LT & RT
 STA 240+00 DOUBLE SOLID RT (TH 33)
 STA 240+20 TO 241+20 SOLID LT & RT
 STA 241+20 TO 243+50 SOLID LT, DASHED RT

TEMPORARY LETTER OR SYMBOL, PAINT
 DURABLE LETTER OR SYMBOL, THERMOPLASTIC
 STA 240+10 RT - "STOP" (TH 33)

REMOVAL AND DISPOSAL OF GUARDRAIL
 STA 237+96 TO 241+49 LT

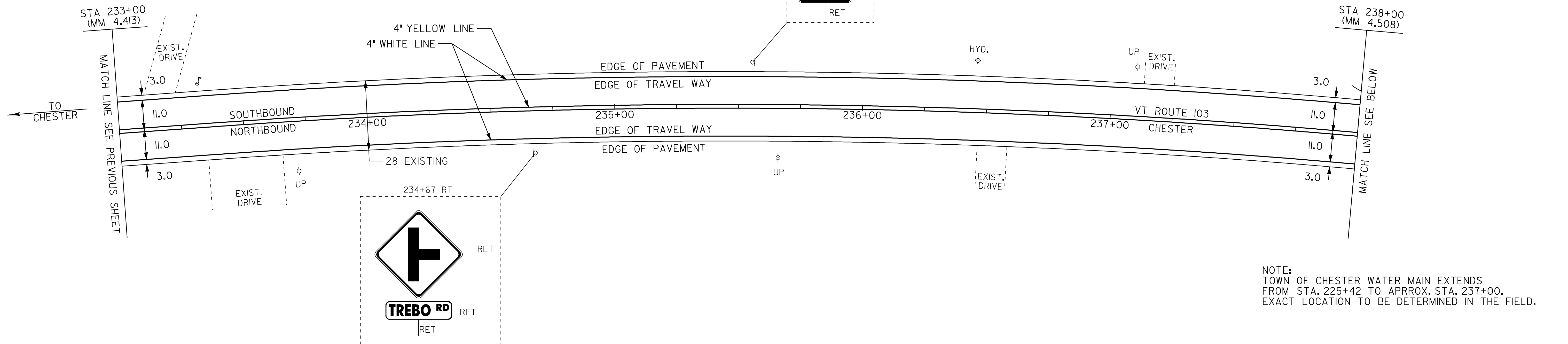

NOTE:
 TOWN OF CHESTER WATER MAIN EXTENDS
 FROM STA. 225+42 TO APPROX. STA. 237+00.
 EXACT LOCATION TO BE DETERMINED IN THE FIELD.

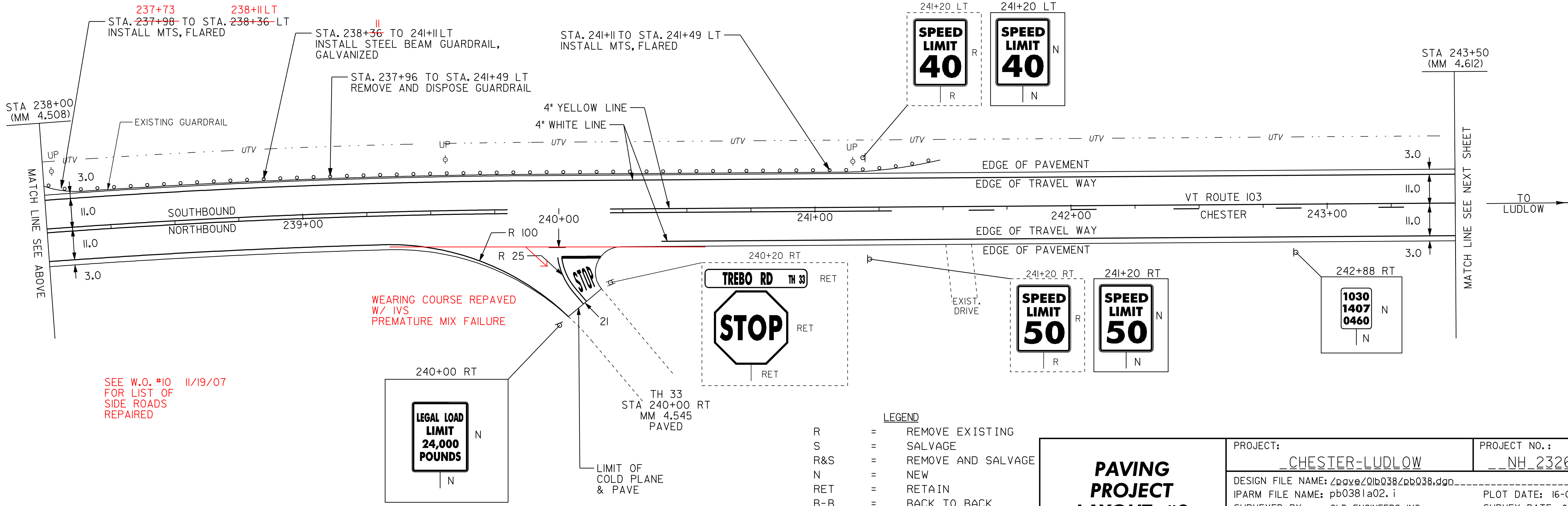

SEE W.O. #10 11/19/07
 FOR LIST OF
 SIDE ROADS
 REPAIRED

- LEGEND
- R = REMOVE EXISTING
 - S = SALVAGE
 - R&S = REMOVE AND SALVAGE
 - N = NEW
 - RET = RETAIN
 - B-B = BACK TO BACK
 - = NEW RAIL
 - = EXISTING RAIL

PAVING PROJECT LAYOUT #2

PROJECT:	PROJECT NO.:
__CHESTER-LUDLOW	__NH_2326(I)S__
DESIGN FILE NAME: \pave\01b\038\pb038.dgn	PLOT DATE: 16-OCT-2009 16:
IPARM FILE NAME: pb0381a02.1	SURVEY DATE: 01/05
SURVEYED BY: CLD_ENGINEERS, INC	DRAWN BY: MRS
SQUAD LEADER: CRB	SHEET: 16 OF 110
_CLD_04-0396	