

604.412 OR 604.415 REHAB.
DIS. CBS OR MHS, CLASS I OR II
STA. 345+97, RT

646.402 DURABLE 4 INCH WHITE LINE, THERMOPLASTIC
(ALL LINES WILL INCLUDE EDGE LINE BREAKS AND
RADI FOR SIDE ROADS)
STA. 345+50 TO 351+50, SOLID LT & RT

646.412 DURABLE 4 INCH YELLOW LINE, THERMOPLASTIC
(ALL LINES WILL INCLUDE @ BREAKS FOR SIDE ROADS)
STA. 345+50 TO 351+50, SOLID LT & RT

646.602 TEMPORARY 4 INCH WHITE LINE, PAINT
(ALL LINES WILL INCLUDE EDGE LINE BREAKS AND
RADI FOR SIDE ROADS)
STA. 345+50 TO 351+50, SOLID LT & RT

646.612 TEMPORARY 4 INCH YELLOW LINE, PAINT
(ALL LINES WILL INCLUDE @ BREAKS FOR SIDE ROADS)
STA. 345+50 TO 351+50, SOLID LT & RT

619.17 YIELDING MARKER POSTS
STA. 349+20, RT
STA. 352+40, LT & RT

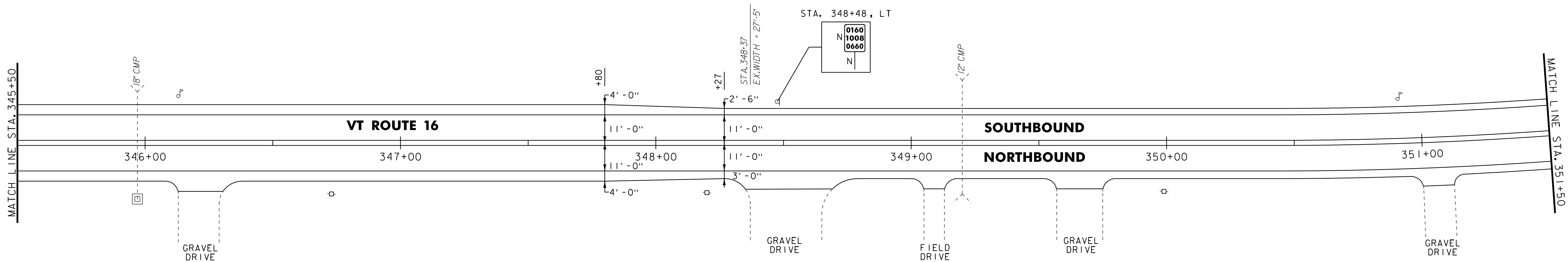

646.402 DURABLE 4 INCH WHITE LINE, THERMOPLASTIC
(ALL LINES WILL INCLUDE EDGE LINE BREAKS AND
RADI FOR SIDE ROADS)
GLOVER STA. 351+50 TO BARTON STA. 3+00, SOLID LT & RT

646.412 DURABLE 4 INCH YELLOW LINE, THERMOPLASTIC
(ALL LINES WILL INCLUDE @ BREAKS FOR SIDE ROADS)
GLOVER STA. 351+50 TO BARTON STA. 3+00, SOLID LT & RT

646.602 TEMPORARY 4 INCH WHITE LINE, PAINT
(ALL LINES WILL INCLUDE EDGE LINE BREAKS AND
RADI FOR SIDE ROADS)
GLOVER STA. 351+50 TO BARTON STA. 3+00, SOLID LT & RT

646.612 TEMPORARY 4 INCH YELLOW LINE, PAINT
(ALL LINES WILL INCLUDE @ BREAKS FOR SIDE ROADS)
GLOVER STA. 351+50 TO BARTON STA. 3+00, SOLID LT & RT

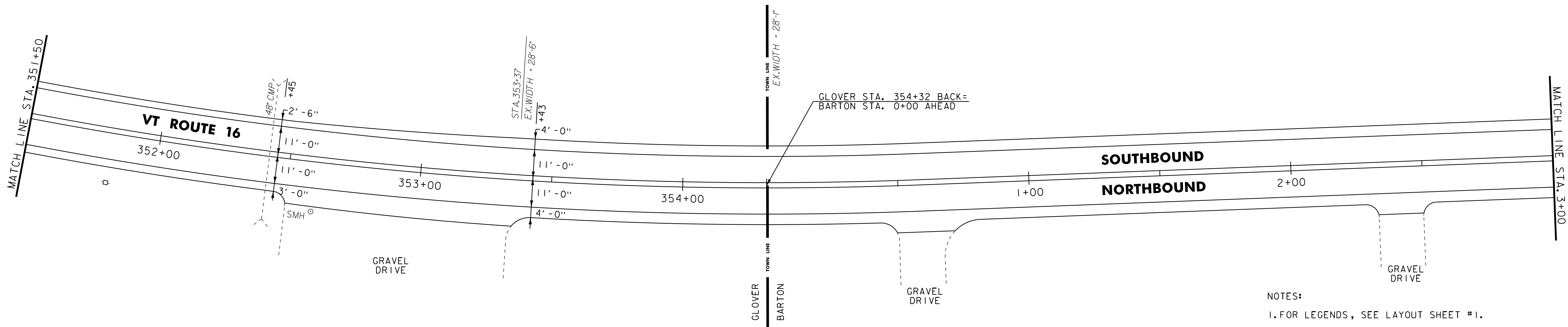

- NOTES:
- FOR LEGENDS, SEE LAYOUT SHEET #1.
 - ALL EXISTING SIGNS NOT SHOWN SHALL BE RETAINED.

NOT TO SCALE

**PROJECT
LAYOUT
SHEET #21**



PROJECT NAME: GLOVER - BARTON
PROJECT NUMBER: STP 2318(I)

FILE NAME: p01b034.dgn
PROJECT LEADER: JLL
DESIGNED BY: STANTEC
IPARM FILE: p01b034I21.i

PLOT DATE: 28-NOV-2012 15:0
DRAWN BY: STANTEC
CHECKED BY: STANTEC
SHEET 33 OF 60