

621.20 STEEL BEAM GUARDRAIL, GALVANIZED
 STA. 265+25.0 TO 268+50.0, LT
 621.50 MANUFACTURED TERMINAL SECTION, FLARED
 STA. 264+87.5 TO 265+25.0, LT
 621.80 REMOVAL AND DISPOSAL OF GUARDRAIL
 STA. 265+28 TO 268+50, LT

646.402 DURABLE 4 INCH WHITE LINE, THERMOPLASTIC
 (ALL LINES WILL INCLUDE EDGE LINE BREAKS AND
 RADII FOR SIDE ROADS)
 STA. 262+50 TO 268+50, SOLID LT & RT
 646.412 DURABLE 4 INCH YELLOW LINE, THERMOPLASTIC
 (ALL LINES WILL INCLUDE C BREAKS FOR SIDE ROADS)
 STA. 262+50 TO 266+11, DASHED LT, SOLID RT
 STA. 266+11 TO 268+50, SOLID LT & RT

646.602 TEMPORARY 4 INCH WHITE LINE, PAINT
 (ALL LINES WILL INCLUDE EDGE LINE BREAKS AND
 RADII FOR SIDE ROADS)
 STA. 262+50 TO 268+50, SOLID LT & RT
 646.612 TEMPORARY 4 INCH YELLOW LINE, PAINT
 (ALL LINES WILL INCLUDE C BREAKS FOR SIDE ROADS)
 STA. 262+50 TO 266+11, DASHED LT, SOLID RT
 STA. 266+11 TO 268+50, SOLID LT & RT

621.205 STEEL BEAM GUARDRAIL, WITH 8FT POST
 STA. 266+25 TO 269+37.5 LT

613.11 STONE FILL, TYPE 11
 STA. 265+98 TO 267+89 LT (SLOPE EROSION REPAIR)

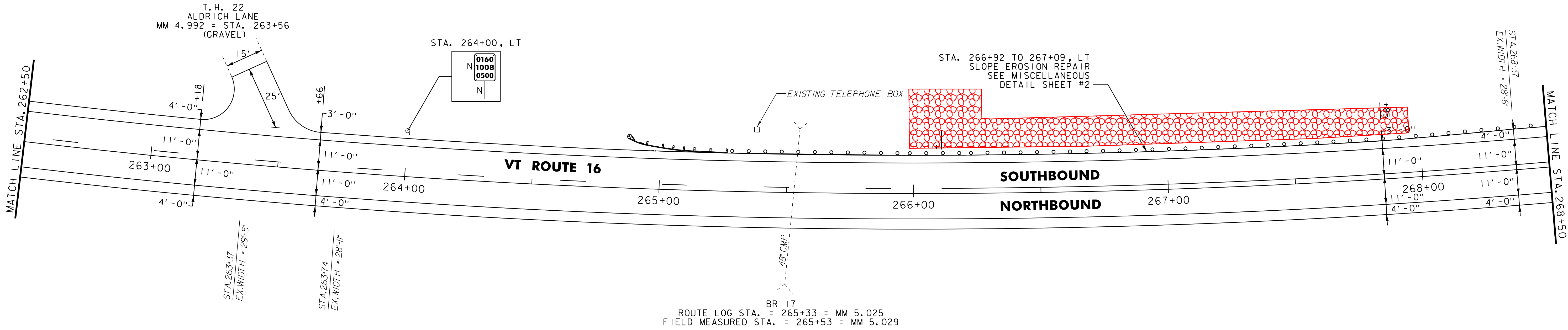

BR 17
 ROUTE LOG STA. = 265+33 = MM 5.025
 FIELD MEASURED STA. = 265+53 = MM 5.029

621.20 STEEL BEAM GUARDRAIL, GALVANIZED
 STA. 268+50.0 TO 269+37.5, LT
 621.50 MANUFACTURED TERMINAL SECTION, FLARED
 STA. 269+37.5 TO 269+75.0, LT
 621.80 REMOVAL AND DISPOSAL OF GUARDRAIL
 STA. 268+50 TO 269+75, LT

646.402 DURABLE 4 INCH WHITE LINE, THERMOPLASTIC
 (ALL LINES WILL INCLUDE EDGE LINE BREAKS AND
 RADII FOR SIDE ROADS)
 STA. 268+50 TO 274+50, SOLID LT & RT
 646.412 DURABLE 4 INCH YELLOW LINE, THERMOPLASTIC
 (ALL LINES WILL INCLUDE C BREAKS FOR SIDE ROADS)
 STA. 268+50 TO 274+50, SOLID LT & RT

646.602 TEMPORARY 4 INCH WHITE LINE, PAINT
 (ALL LINES WILL INCLUDE EDGE LINE BREAKS AND
 RADII FOR SIDE ROADS)
 STA. 268+50 TO 274+50, SOLID LT & RT
 646.612 TEMPORARY 4 INCH YELLOW LINE, PAINT
 (ALL LINES WILL INCLUDE C BREAKS FOR SIDE ROADS)
 STA. 268+50 TO 274+50, SOLID LT & RT

619.17 YIELDING MARKER POSTS
 STA. 273+35, RT

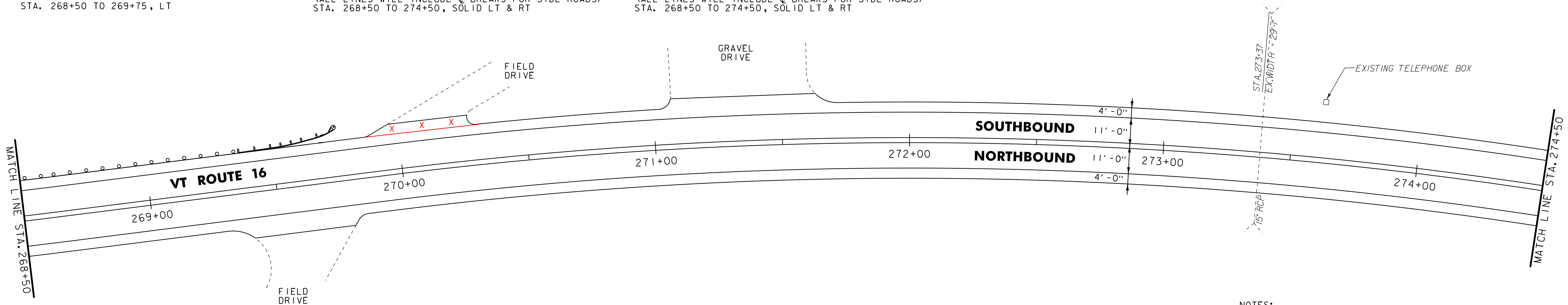

- NOTES:
- FOR LEGENDS, SEE LAYOUT SHEET #1.
 - ALL EXISTING SIGNS NOT SHOWN SHALL BE RETAINED.

NOT TO SCALE

**PROJECT
 LAYOUT
 SHEET #12**



PROJECT NAME: GLOVER - BARTON
 PROJECT NUMBER: STP 2318(I)

FILE NAME: p01b034.dgn
 PROJECT LEADER: JLL
 DESIGNED BY: STANTEC
 IPARM FILE: p01b034112.i

PLOT DATE: 28-NOV-2012 15:0
 DRAWN BY: STANTEC
 CHECKED BY: STANTEC
 SHEET 24 OF 60