

621.20 STEEL BEAM GUARDRAIL, GALVANIZED
 STA. ~~171+67.0 TO 174+04.5~~, LT ~~171+72.5 TO 174+10~~
 STA. ~~173+63.5 TO 174+13.5~~, RT ~~173+23 TO 173+87.5~~
 621.50 MANUFACTURED TERMINAL SECTION, FLARED
 STA. ~~171+29.5 TO 171+67.0~~, LT ~~171+35 TO 171+72.5~~
 STA. ~~173+26.0 TO 173+63.5~~, RT
 STA. ~~174+04.5 TO 174+42.0~~, LT ~~174+10 TO 174+47.5~~
 STA. ~~174+13.5 TO 174+51.0~~, RT ~~174+12.5 TO 174+50~~
 621.80 REMOVAL AND DISPOSAL OF GUARDRAIL
 STA. 171+35 TO 174+42, LT 174+35
 STA. ~~173+26 TO 174+53~~, RT 173+23 TO 174+48

646.402 DURABLE 4 INCH WHITE LINE, THERMOPLASTIC
 (ALL LINES WILL INCLUDE EDGE LINE BREAKS AND
 RADII FOR SIDE ROADS)
 STA. 170+50 TO 176+50, SOLID LT & RT
 646.412 DURABLE 4 INCH YELLOW LINE, THERMOPLASTIC
 (ALL LINES WILL INCLUDE C BREAKS FOR SIDE ROADS)
 STA. 170+50 TO 175+56, SOLID LT, DASHED RT
 STA. 175+56 TO 176+50, DASHED C

646.602 TEMPORARY 4 INCH WHITE LINE, PAINT
 (ALL LINES WILL INCLUDE EDGE LINE BREAKS AND
 RADII FOR SIDE ROADS)
 STA. 170+50 TO 176+50, SOLID LT & RT
 646.612 TEMPORARY 4 INCH YELLOW LINE, PAINT
 (ALL LINES WILL INCLUDE C BREAKS FOR SIDE ROADS)
 STA. 170+50 TO 175+56, SOLID LT, DASHED RT
 STA. 175+56 TO 176+50, DASHED C

675.50 REMOVING SIGNS
 AS SHOWN - 2

621.60 ANCHOR FOR STEEL BEAM RAIL
 STA. 173+23, RT

621.205 STEEL BEAM GUARDRAIL, WITH 8' POST
 STA. 173+87.5 TO 174+12.5, RT

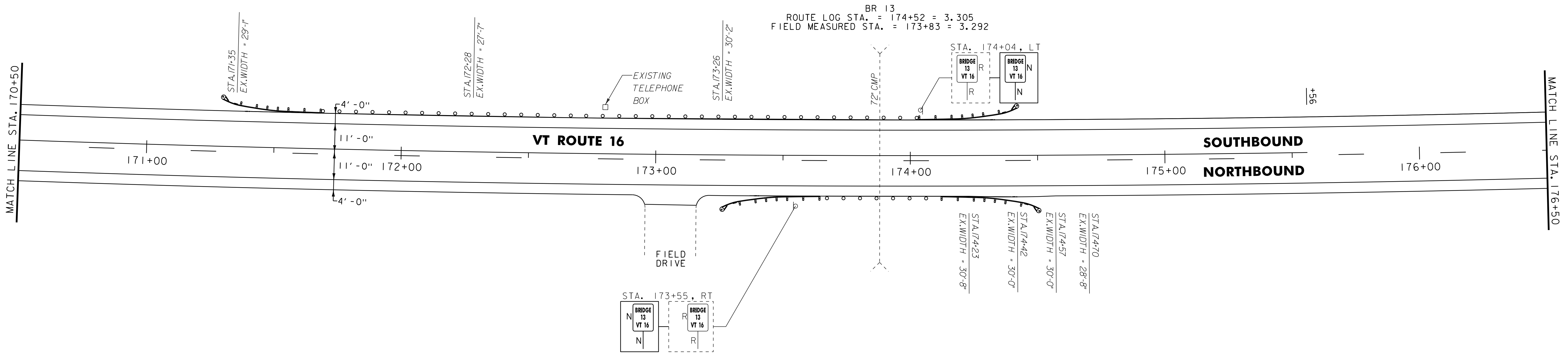

646.402 DURABLE 4 INCH WHITE LINE, THERMOPLASTIC
 (ALL LINES WILL INCLUDE EDGE LINE BREAKS AND
 RADII FOR SIDE ROADS)
 STA. 176+50 TO 182+50, SOLID LT & RT
 646.412 DURABLE 4 INCH YELLOW LINE, THERMOPLASTIC
 (ALL LINES WILL INCLUDE C BREAKS FOR SIDE ROADS)
 STA. 176+50 TO 181+16, DASHED C
 STA. 181+16 TO 182+50, DASHED LT, SOLID RT

646.602 TEMPORARY 4 INCH WHITE LINE, PAINT
 (ALL LINES WILL INCLUDE EDGE LINE BREAKS AND
 RADII FOR SIDE ROADS)
 STA. 176+50 TO 182+50, SOLID LT & RT
 646.612 TEMPORARY 4 INCH YELLOW LINE, PAINT
 (ALL LINES WILL INCLUDE C BREAKS FOR SIDE ROADS)
 STA. 176+50 TO 181+16, DASHED C
 STA. 181+16 TO 182+50, DASHED LT, SOLID RT

675.50 REMOVING SIGNS
 AS SHOWN - 1

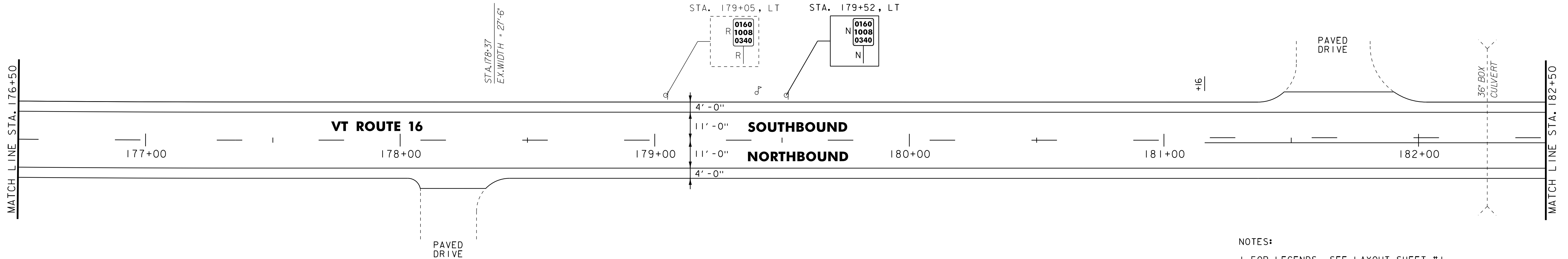

NOTES:
 1. FOR LEGENDS, SEE LAYOUT SHEET #1.
 2. ALL EXISTING SIGNS NOT SHOWN SHALL BE RETAINED.

NOT TO SCALE

PROJECT LAYOUT SHEET #3

PROJECT NAME: GLOVER - BARTON
 PROJECT NUMBER: STP 2318(I)

FILE NAME: p01b034.dgn
 PROJECT LEADER: JLL
 DESIGNED BY: STANTEC
 IPARM FILE: p01b034I03.i

PLOT DATE: 28-NOV-2012 15:00
 DRAWN BY: STANTEC
 CHECKED BY: STANTEC
 SHEET 15 OF 60

