

646.40 DURABLE 100 mm WHITE LINE
 (ALL LINES WILL INCLUDE EDGE LINE BREAKS AND RADIUS FOR TOWN HIGHWAYS)
 MT. HOLLY:
 STA. 10+820.0 - STA. 11+360.0, LT & RT

646.60 TEMPORARY 100 mm WHITE LINE
 (ALL LINES WILL INCLUDE EDGE LINE BREAKS AND RADIUS FOR TOWN HIGHWAYS)
 MT. HOLLY:
 STA. 10+820.0 - STA. 11+360.0, LT & RT

646.41 DURABLE 100 mm YELLOW LINE
 (ALL LINES WILL INCLUDE C/L BREAKS FOR TOWN HIGHWAYS) S=SOLID, D=DASHED
 MT. HOLLY:
 STA. 10+820.0 - STA. 11+360.0 LT S C RT S

646.61 TEMPORARY 100 mm YELLOW LINE
 (ALL LINES WILL INCLUDE C/L BREAKS FOR TOWN HIGHWAYS) S=SOLID, D=DASHED
 MT. HOLLY:
 STA. 10+820.0 - STA. 11+360.0 LT S C RT S

675.50 REMOVING SIGNS
 AS SHOWN - 2

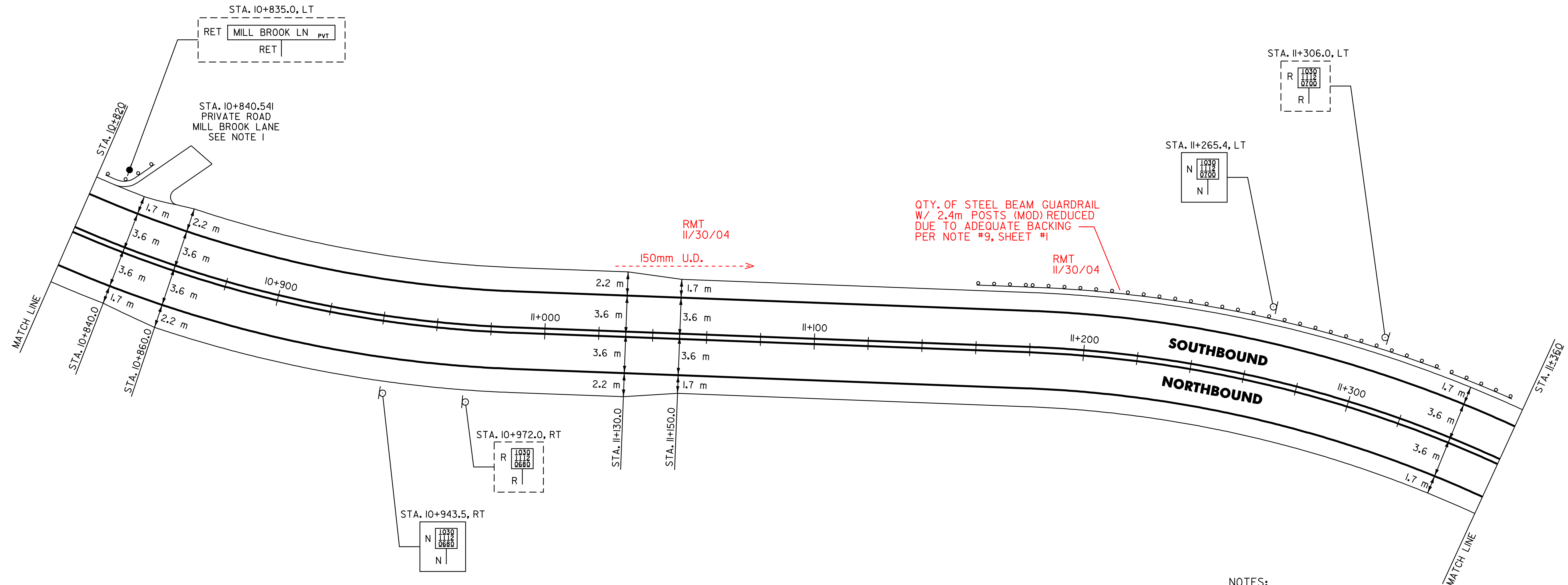

QTY. OF STEEL BEAM GUARDRAIL W/ 2.4m POSTS (MOD) REDUCED DUE TO ADEQUATE BACKING PER NOTE #9, SHEET #1

RMT 11/30/04

RMT 11/30/04

150mm U.D.

NOTES:

1. THE CONTRACTOR SHOULD BE AWARE THAT EXISTING BURIED UTILITIES (SUCH AS PHONE CABLE, FIBER OPTIC CABLE, SEWER LINES, ETC.) ARE LOCATED ADJACENT TO VT. ROUTE 103 WITHIN THE PROJECT LIMITS. THE CONTRACTOR IS RESPONSIBLE FOR CONTACTING "DIG SAFE" AT 1-888-344-7233 TO DETERMINE THE EXACT LOCATIONS OF THESE UTILITIES PRIOR TO INSTALLING GUARDRAIL, CLEANING DITCHES OR PERFORMING ANY OTHER OPERATIONS THAT MAY DISTURB THE EXISTING SUBSURFACE CONDITIONS.
2. PROVIDE A 30 mm TYPE IVS 5 m WIDE APRON FOR THE EXISTING PRIVATE ROAD. ANY REQUIRED EXCAVATION SHALL BE PERFORMED AS DIRECTED BY THE RESIDENT ENGINEER AND PAID FOR UNDER ITEM 210.10 OR 608.25.

ARCHIVED ON CADD

ADD TO 621.20 ~ STEEL BEAM G.R.

STA 11+164.0 ~ STA 11+203.8 LT (39.8m)
 STA 11+289.4 ~ STA 11+344.9 LT (55.5m)

621.20 STEEL BEAM GUARDRAIL RMT 11/30/04
 MT. HOLLY:
 STA. 10+820.0 - STA. 10+840.0 LT (20.0 m)

621.20 STEEL BEAM GUARDRAIL WITH 2.4 m POSTS (MOD.)
 MT. HOLLY:
 STA. 11+164.0 - STA. 11+342.6 LT (178.6 m)
 STA 11+203.8 ~ STA 11+289.4 LT (83.8m) RMT 11/30/04

605.10 150mm UNDERDRAIN RMT 11/30/04
 MT HOLLY
 STA 11+025 ~ STA 11+077 LT (51.2m)

621.60 ANCHOR FOR STEEL BEAM GUARDRAIL RMT 11/30/04

MT HOLLY
 STA 10+822 LT (1EA)
 621.505 MANUFACTURED TERMINAL SECTION (FLARED)
 MT. HOLLY:
 STA. 10+840.0 LT NOT INSTALLED
 STA. 11+164.0 LT
 STA. 11+342.6 LT RMT 11/30/04

621.80 REMOVAL AND DISPOSAL OF GUARDRAIL
 MT. HOLLY:
 STA. 10+820.0 - STA. 10+850.0 LT (30.0 m)
 STA. 11+155.0 - STA. 11+354.0 LT (199.0 m)

SIGN LEGEND
 R= REMOVE
 S= SALVAGE
 N= NEW
 RET= RETAIN
 B-B= BACK TO BACK
 EXISTING= -----
 NEW= -----

DATUM	
VERTICAL	N/A
HORIZONTAL	N/A

PAVING PROJECT LAYOUT # 30	SURVEYED BY	N/A	DATE	N/A
	DRAWN BY	C.A.K.	DATE	
	SQUAD LEADER	T.P.K.		
	DESIGN FILE NO.	/pave/01b024/pb024.dgn		
	IPARM FILE	pb0241301	DATE PLOTTED	\$DATE\$
PROJ. NAME	LUDLOW - MT. HOLLY			
PROJ. NO.	NH_2327(1)S			
SHEET	39	OF	84	SHEETS