

646.40 DURABLE 100 mm WHITE LINE
 (ALL LINES WILL INCLUDE EDGE LINE BREAKS AND RADIUS FOR TOWN HIGHWAYS)
 MT. HOLLY:
 STA. 10+280.0 - STA. 10+820.0 LT & RT

646.4I DURABLE 100 mm YELLOW LINE
 (ALL LINES WILL INCLUDE C/L BREAKS FOR TOWN HIGHWAYS) S=SOLID, D=DASHED
 MT. HOLLY:
 STA. 10+280.0 - STA. 10+820.0 LT S C RT S

675.50 REMOVING SIGNS
 AS SHOWN - 15

646.60 TEMPORARY 100 mm WHITE LINE
 (ALL LINES WILL INCLUDE EDGE LINE BREAKS AND RADIUS FOR TOWN HIGHWAYS)
 MT. HOLLY:
 STA. 10+280.0 - STA. 10+820.0 LT & RT

646.6I TEMPORARY 100 mm YELLOW LINE
 (ALL LINES WILL INCLUDE C/L BREAKS FOR TOWN HIGHWAYS) S=SOLID, D=DASHED
 MT. HOLLY:
 STA. 10+280.0 - STA. 10+820.0 LT S C RT S

675.60 ERECTING SALVAGED SIGNS
 AS SHOWN - 2

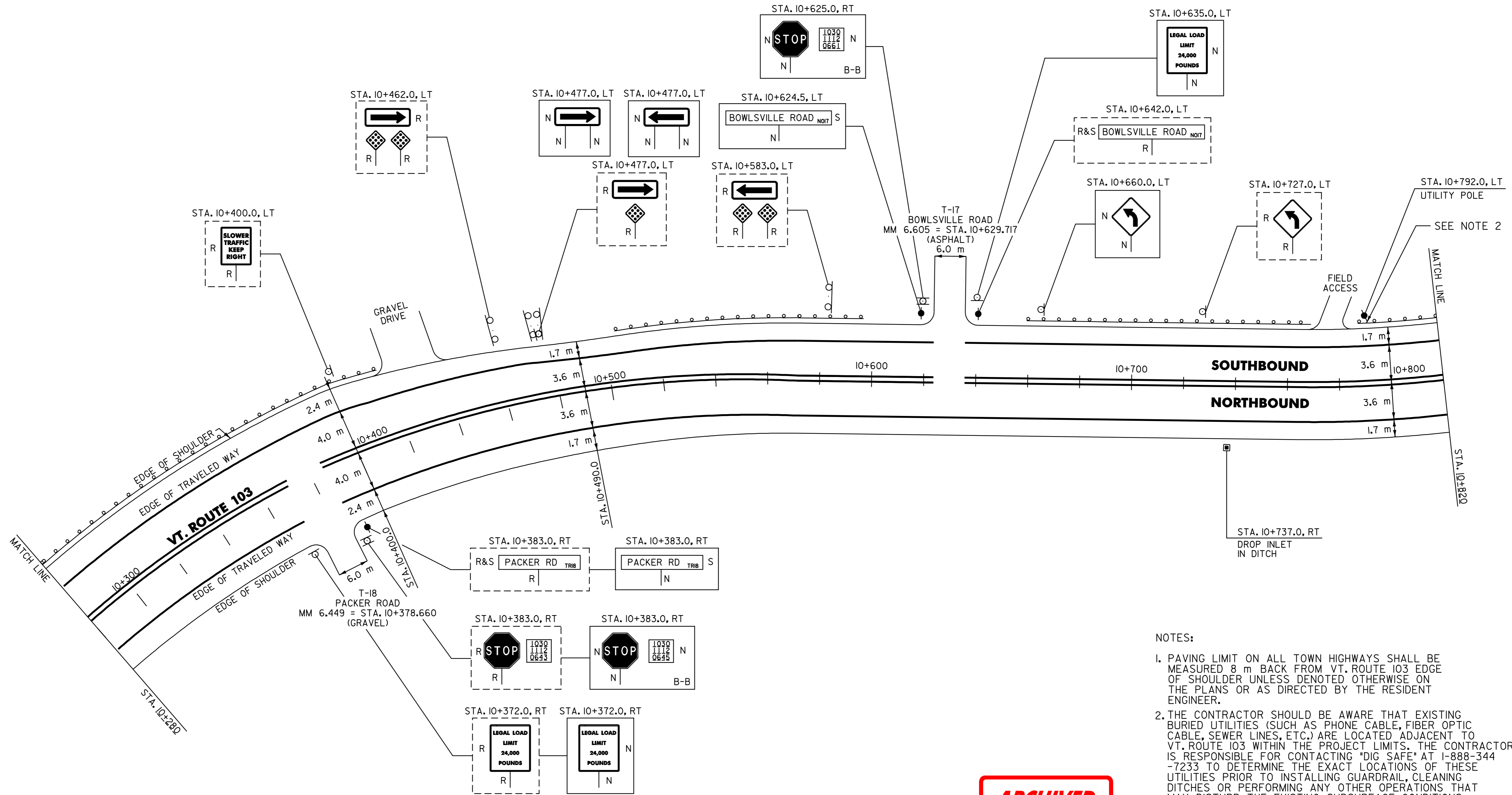

NOTES:

- PAVING LIMIT ON ALL TOWN HIGHWAYS SHALL BE MEASURED 8 m BACK FROM VT. ROUTE 103 EDGE OF SHOULDER UNLESS DENOTED, OTHERWISE ON THE PLANS OR AS DIRECTED BY THE RESIDENT ENGINEER.
- THE CONTRACTOR SHOULD BE AWARE THAT EXISTING BURIED UTILITIES (SUCH AS PHONE CABLE, FIBER OPTIC CABLE, SEWER LINES, ETC.) ARE LOCATED ADJACENT TO VT. ROUTE 103 WITHIN THE PROJECT LIMITS. THE CONTRACTOR IS RESPONSIBLE FOR CONTACTING "DIG SAFE" AT 1-888-344-7233 TO DETERMINE THE EXACT LOCATIONS OF THESE UTILITIES PRIOR TO INSTALLING GUARDRAIL, CLEANING DITCHES OR PERFORMING ANY OTHER OPERATIONS THAT MAY DISTURB THE EXISTING SUBSURFACE CONDITIONS.

**ARCHIVED
ON CADD**

621.20 STEEL BEAM GUARDRAIL
 MT. HOLLY:
 STA. 10+280.2 - STA. 10+405.6 LT (125.4 m)
 STA. 10+510.7 - STA. 10+575.3 LT (64.6 m)
 STA. 10+664.8 - STA. 10+763.6 LT (98.8 m)
 STA. 10+794.4 - STA. 10+820.0 LT (25.6 m)

621.80 REMOVAL AND DISPOSAL OF GUARDRAIL
 MT. HOLLY:
 STA. 10+280.0 - STA. 10+417.0 LT (137.0 m)
 STA. 10+500.0 - STA. 10+586.0 LT (86.0 m)
 STA. 10+659.0 - STA. 10+775.0 LT (116.0 m)
 STA. 10+783.0 - STA. 10+820.0 LT (37.0 m)

621.505 MANUFACTURED TERMINAL SECTION (FLARED)
 MT. HOLLY:
~~STA. 10+280.2 LT~~ MOVED TO EXTEND GUARDRAIL
~~STA. 10+405.6 LT~~ SEE SHEET #37 OF #84
~~STA. 10+510.7 LT~~
~~STA. 10+575.3 LT~~
~~STA. 10+664.8 LT~~
~~STA. 10+763.6 LT~~ NOT INSTALLED
 STA. 10+794.4 LT
 RMT 11/30/04

621.60 ANCHOR FOR STEEL BEAM GUARDRAIL
 MT. HOLLY
 STA. 10+764 LT (1EA)
 RMT 11/30/04

DATUM	
VERTICAL	N/A
HORIZONTAL	N/A

SIGN LEGEND
 R= REMOVE
 S= SALVAGE
 N= NEW
 RET= RETAIN
 B-B= BACK TO BACK
 EXISTING= _____
 NEW= _____

PAVING PROJECT LAYOUT # 29	SURVEYED BY	N/A	DATE	N/A
	DRAWN BY	C.A.K.	DATE	
	SQUAD LEADER	T.P.K.		
	DESIGN FILE NO.	/pave/01b024/pb024.dgn		
	IPARM FILE	pb024i29.i	DATE PLOTTED	\$DATE\$
	PROJ. NAME	LUDLOW - MT. HOLLY		
PROJ. NO.	NH_2327(I)S			
SHEET	38	OF	84	SHEETS