

646.40 DURABLE 100 mm WHITE LINE
 (ALL LINES WILL INCLUDE EDGE LINE BREAKS AND RADIUS FOR TOWN HIGHWAYS)
 LUDLOW:
 STA. 6+080.0 - STA. 6+305.0, LT & RT

646.41 DURABLE 100 mm YELLOW LINE
 (ALL LINES WILL INCLUDE C/L BREAKS FOR TOWN HIGHWAYS) S=SOLID, D=DASHED
 LUDLOW:
 STA. 6+080.0 - STA. 6+305.0 LT S RT S

675.50 REMOVING SIGNS
 AS SHOWN - 6

646.60 TEMPORARY 100 mm WHITE LINE
 (ALL LINES WILL INCLUDE EDGE LINE BREAKS AND RADIUS FOR TOWN HIGHWAYS)
 LUDLOW:
 STA. 6+080.0 - STA. 6+305.0, LT & RT

646.61 TEMPORARY 100 mm YELLOW LINE
 (ALL LINES WILL INCLUDE C/L BREAKS FOR TOWN HIGHWAYS) S=SOLID, D=DASHED
 LUDLOW:
 STA. 6+080.0 - STA. 6+305.0 LT S RT S

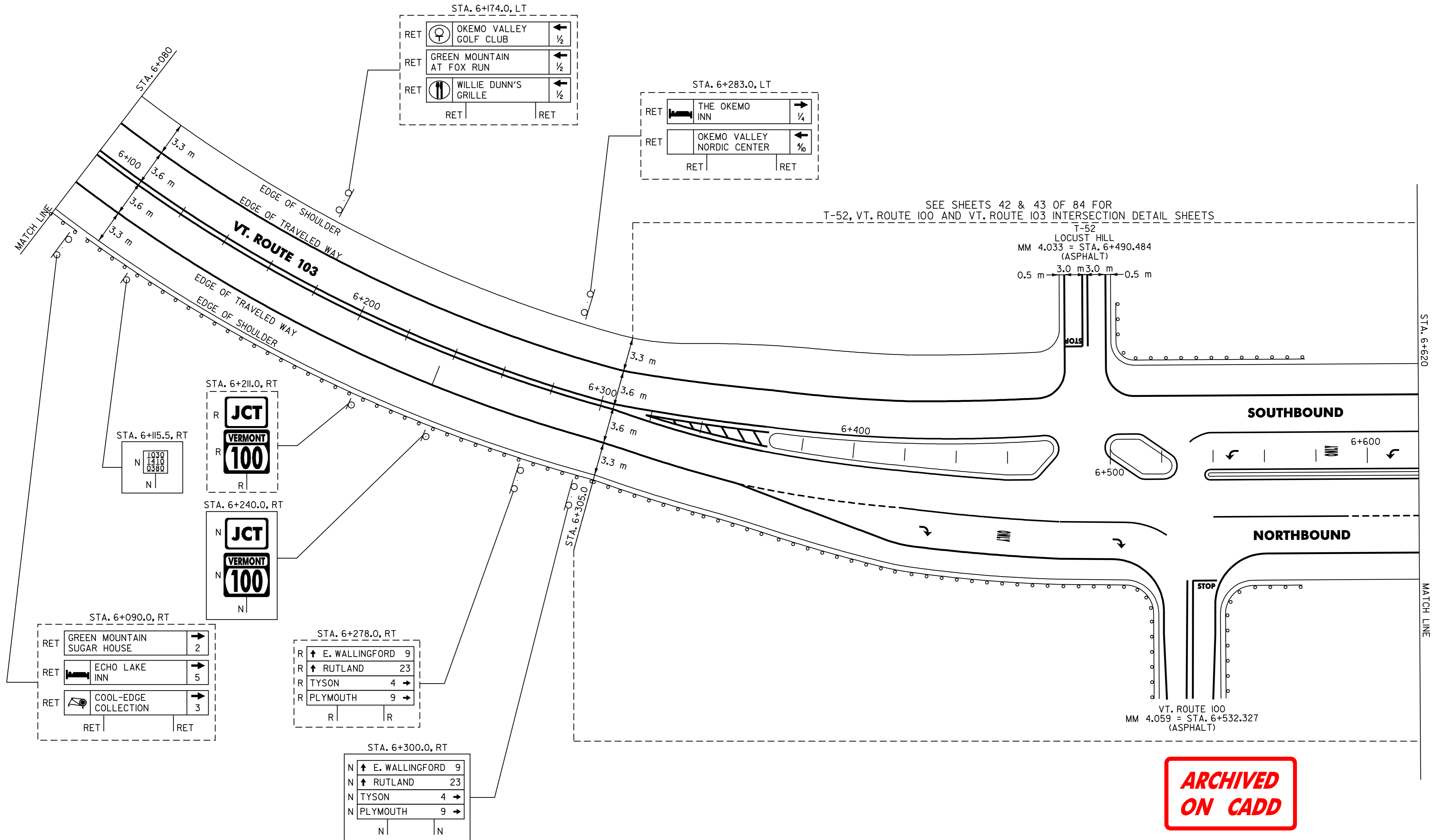

621.60 ANCHORS FOR STEEL BEAM GUARDRAIL RMT
 LUDLOW: II/30/04
 STA 6+501 & STA 6+507 LT (2 EA)

621.20 STEEL BEAM GUARDRAIL
 LUDLOW:
 STA. 6+080.0 - STA. 6+305.0 (225.0 m)

621.80 REMOVAL AND DISPOSAL OF GUARDRAIL
 LUDLOW:
 STA. 6+080.0 - STA. 6+305.0 (225.0 m)

NOTE:
 1. THE CONTRACTOR SHOULD BE AWARE THAT EXISTING BURIED UTILITIES (SUCH AS PHONE CABLE, FIBER OPTIC CABLE, SEWER LINES, ETC.) ARE LOCATED ADJACENT TO VT. ROUTE 103 WITHIN THE PROJECT LIMITS. THE CONTRACTOR IS RESPONSIBLE FOR CONTACTING "DIG SAFE" AT 1-888-344-7233 TO DETERMINE THE EXACT LOCATIONS OF THESE UTILITIES PRIOR TO INSTALLING GUARDRAIL, CLEANING DITCHES OR PERFORMING ANY OTHER OPERATIONS THAT MAY DISTURB THE EXISTING SUBSURFACE CONDITIONS.

SIGN LEGEND
 R= REMOVE
 S= SALVAGE
 N= NEW
 RET= RETAIN
 B-B= BACK TO BACK
 EXISTING= _____
 NEW= _____

ARCHIVED
ON CADD

PAVING
PROJECT
LAYOUT
4

SURVEYED BY	N/A	DATE	N/A
DRAWN BY	C.A.K.	DATE	
SQUAD LEADER	T.P.K.		
DESIGN FILE NO.	/pave/Qlb024/pb024.dgn		
IPARM FILE	pb024i04.L	DATE PLOTTED	*DATE*
PROJ. NAME	LUDLOW - .MT. HOLLY		
PROJ. NO.	NH_2327(1)S		
SHEET	13	OF	84 SHEETS

DATUM
 VERTICAL N/A
 HORIZONTAL N/A