

REMOVAL AND DISPOSAL OF GUARDRAIL

STA. 2+360 LT. - STA. 2+462 LT.
 STA. 2+360 RT. - STA. 2+464 RT.

STEEL BEAM GUARDRAIL

STA. 2+360 LT. - STA. 2+451 LT.
 STA. 2+360 RT. - STA. 2+460 RT.

TRAILING END TERMINAL

STA. 2+460 RT. - STA. 2+464 RT.

MANUFACTURED TERMINAL SECTION (FLARED)

STA. 2+451 LT. - STA. 2+462 LT. - **Gld**
 ANCHOR FOR STEEL BEAM GUARDRAIL

STA. 2+462 RT.

TEMPORARY AND DURABLE 600 mm STOP BAR

STA. 2+467 RT. STA. 2+476 LT.
 STA. 2+539 RT.

TEMPORARY AND DURABLE RAILROAD XING SYMBOLS

STA. 2+372 RT. STA. 2+524 LT.

TEMPORARY AND DURABLE 150 mm WHITE LINE

STA. 2+360 LT. - STA. 2+539 LT. (SOLID)
 STA. 2+360 LT. - STA. 2+539 LT. (DASHED)
 STA. 2+360 RT. - STA. 2+460 RT. (DASHED)
 STA. 2+460 RT. - STA. 2+539 RT. (SOLID)
 STA. 2+360 RT. - STA. 2+539 RT. (SOLID)

TEMPORARY AND DURABLE 150 mm YELLOW LINE

STA. 2+360 LT. - STA. 2+539 LT. (SOLID)
 STA. 2+360 RT. - STA. 2+539 RT. (SOLID)

TEMPORARY AND DURABLE LETTERS OR SYMBOLS

STA. 2+460 RT. (ONLY)
 STA. 2+464 RT. (LEFT TURN/THROUGH ARROW,
 RIGHT TURN ARROW)
 STA. 2+490 RT. (ONLY)
 STA. 2+494 RT. (LEFT TURN/THROUGH ARROW,
 RIGHT TURN ARROW)
 STA. 2+530 RT. (ONLY)
 STA. 2+534 RT. (LEFT TURN/THROUGH ARROW,
 RIGHT TURN ARROW)

BITUMINOUS CONCRETE GUTTERS AND TRAFFIC ISLANDS

STA. 2+361 MEDIAN STA. 2+414 MEDIAN
 STA. 2+464 MEDIAN

REHABILITATION OF DI'S, CB'S, OR MH'S-CLASS I

STA. 2+361 MEDIAN **CE** STA. 2+464 LT. **IN RR ROW**
 STA. 2+361 RT. STA. 2+464 MEDIAN **CE ELIMINATED**
 STA. 2+414 MEDIAN **CE** STA. 2+525 LT.
 STA. 2+416 RT. STA. 2+525 RT.



REMOVING SIGNS

12 EACH

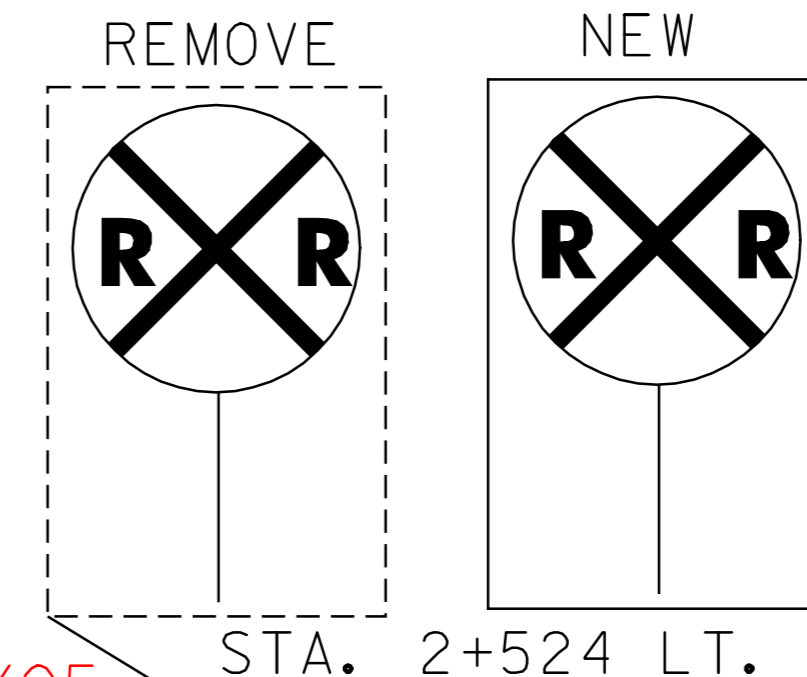

**2+539 TO 2+360 LT
 COLD PLANED FULL WIDTH 4/27/05**

~~NOTE: CONSTRUCT NEW RCDI W/450 mm CPEP SL PIPE
 AT STA. 2+539 LT. OUTLET INTO EXISTING RCDI AT
 STA. 2+524 LT.~~

REMOVING & RESETTING CURB

STA. 2+539 LT.

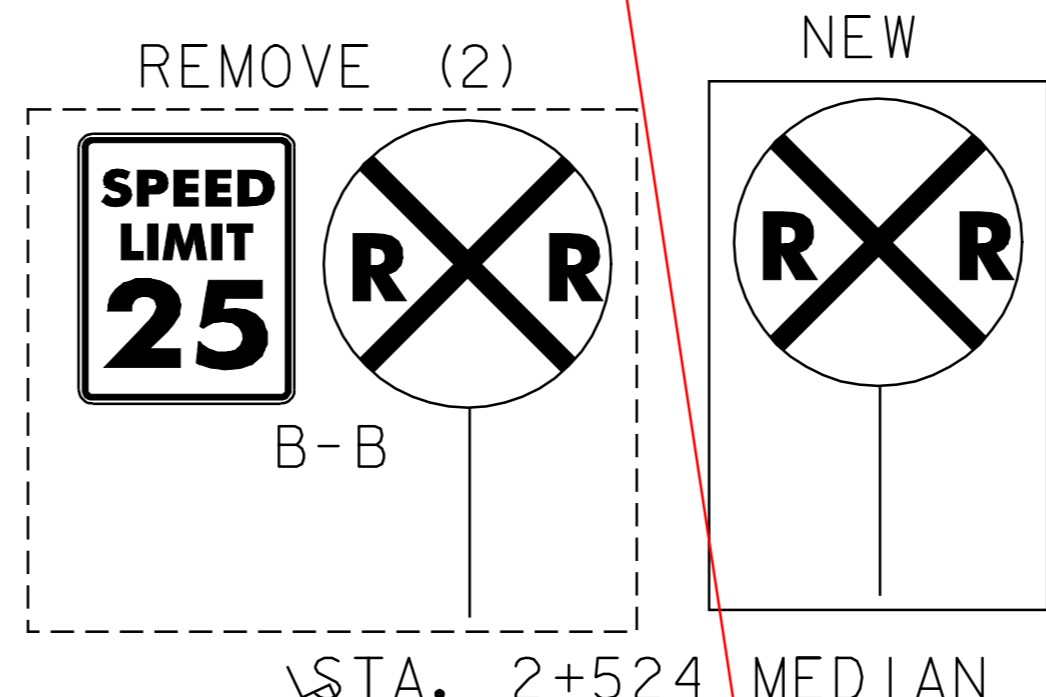
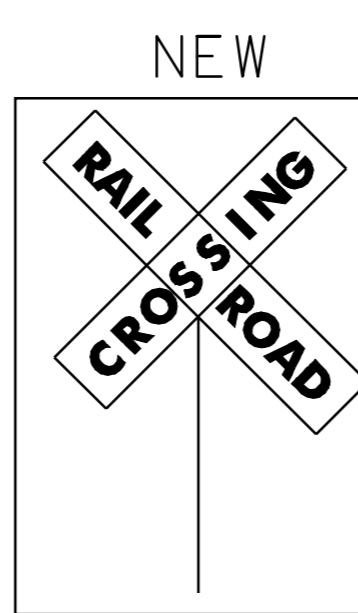

**COLD PLANE
 LIMIT**

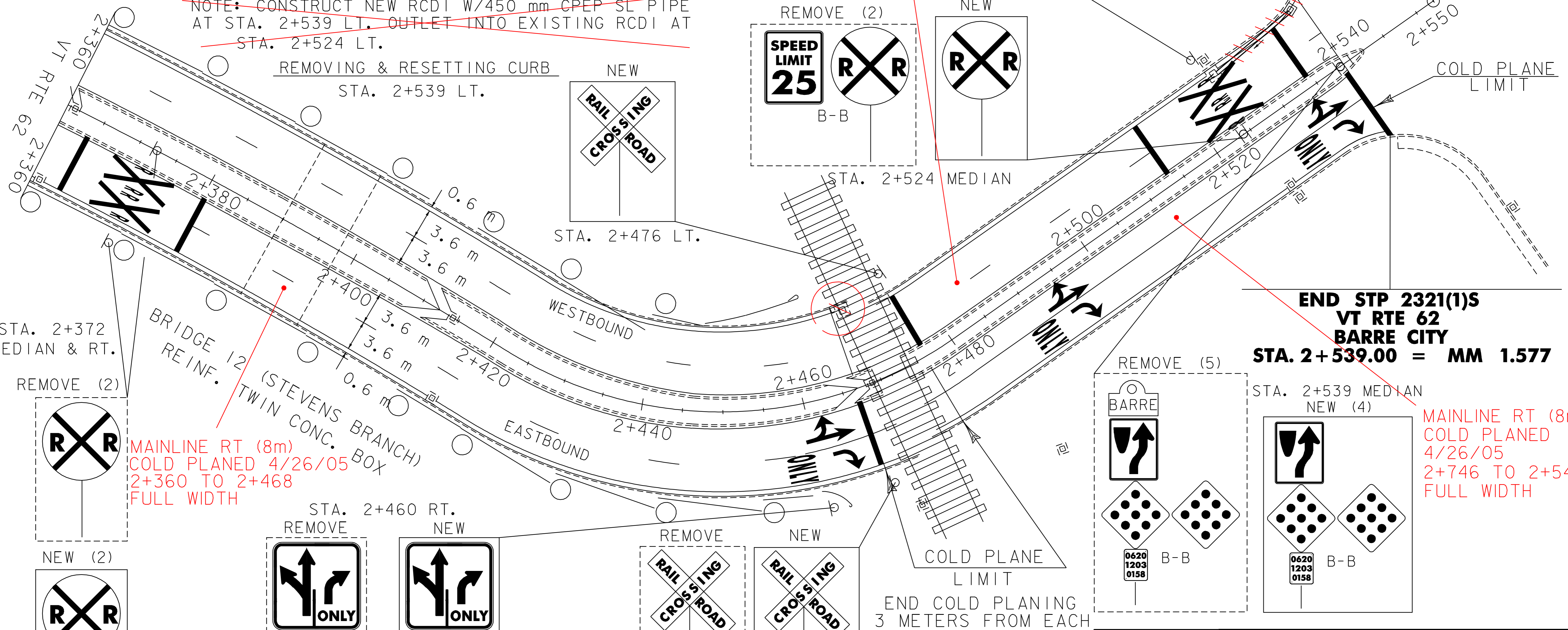

**END STP 2321(1)S
 VT RTE 62
 BARRE CITY
 STA. 2+539.00 = MM 1.577**

**MAINLINE RT (8m)
 COLD PLANED
 4/26/05
 2+746 TO 2+540
 FULL WIDTH**

STA. 2+372
 MEDIAN & RT.
 REMOVE (2)
 BRIDGE 12 (STEVENS BRANCH)
 REINF. TWIN CONC. BOX
**MAINLINE RT (8m)
 COLD PLANED 4/26/05
 2+360 TO 2+468
 FULL WIDTH**

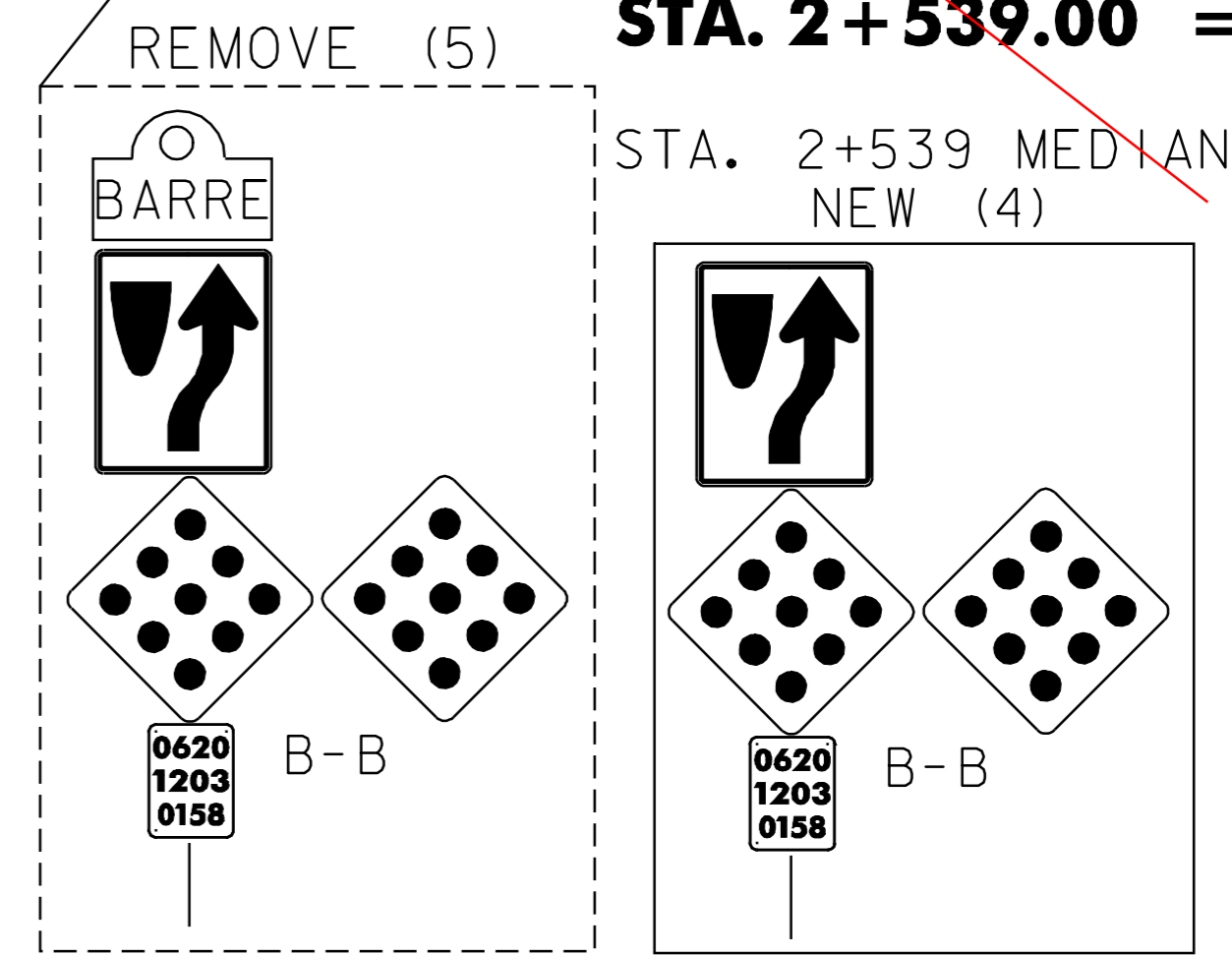
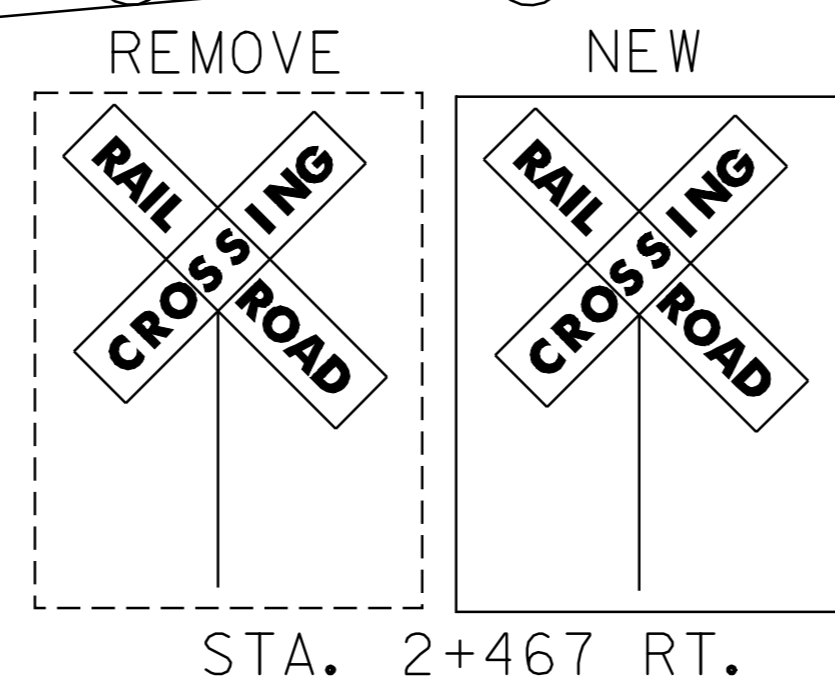
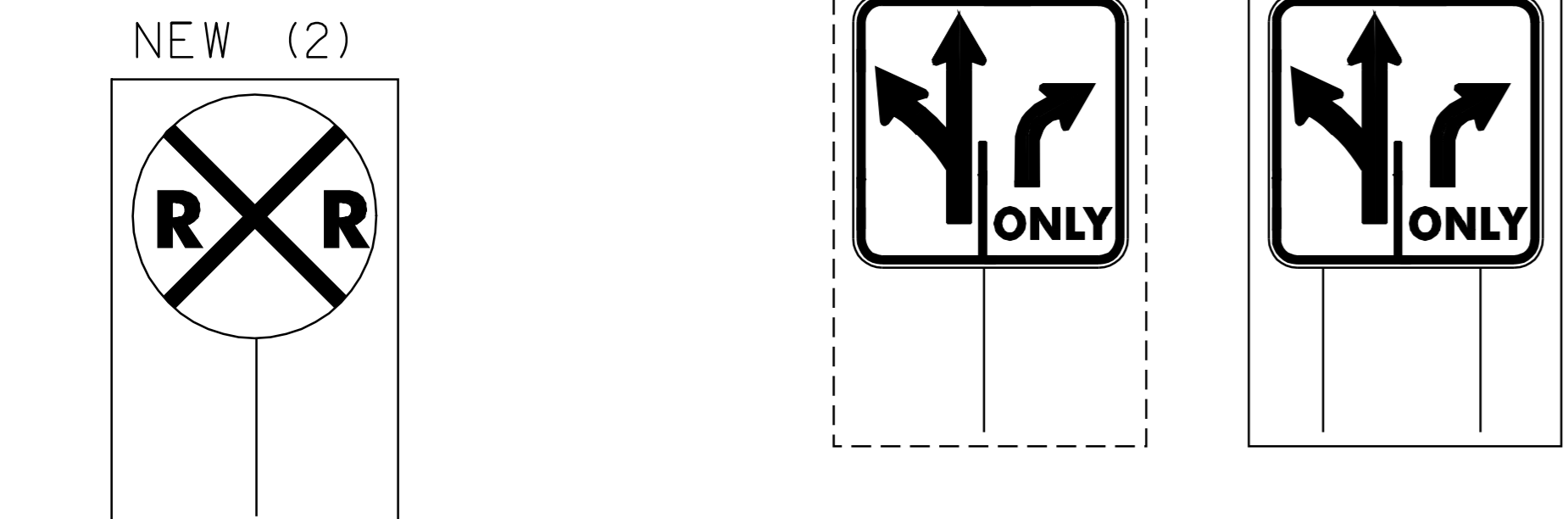

**PAVING
 PROJECT
 LAYOUT
 #17**

PROJECT NAME: BERLIN-BARRE CITY
 PROJECT NUMBER: STP 2321(1)S
 FILE NAME: /pave/01b022/pb022.dgn
 PROJECT LEADER: WOOLLAVER
 DESIGNED BY: LOCKE
 pb0221a17.1
 PLOT DATE: 12-MAR-2007 11:0
 DRAWN BY: LOCKE
 CHECKED BY:
 SHEET 29 OF 39