

U.S. ROUTE 7
MM 1.123 = STA. 1+807.293
BEGIN PROJECT NH 2311(1)S

U.S. ROUTE 7
MM 4.276 = STA. 6+881.555
END PROJECT NH 2311(1)S

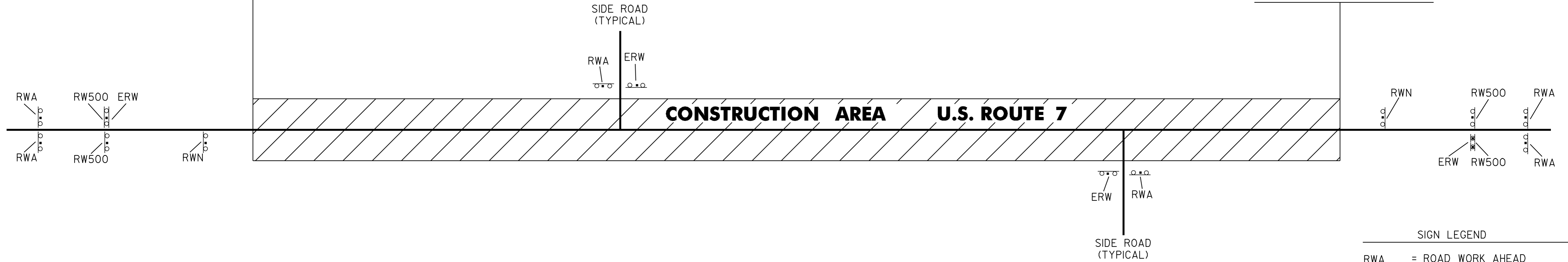

CONSTRUCTION APPROACH SIGNING

SEE STD. E-100M FOR ADDITIONAL SIGN PLACEMENT

SIGN LEGEND

- RWA = ROAD WORK AHEAD
- RW500 = ROAD WORK 500 FEET
- ERW = END ROAD WORK
- RWN = ROAD WORK NEXT 7³/₄ MILES

LIST OF TOWN HIGHWAYS FOR CONSTRUCTION SIGNS

TOWN HIGHWAY NUMBER	ROAD WORK AHEAD	END ROAD WORK	OTHER
BEGIN PROJECT	2	1	2 - RW500 1 - RWN
T-23	1	1	
T-23	1	1	
T-3	1	1	
T-9	1	1	
T-10	1	1	
VT. ROUTE 116	1	1	
VT. ROUTE 125	1	1	
T-24	1	1	
T-12	1	1	
T-26	1	1	
T-7	1	1	
T-9	1	1	
T-115	1	1	
T-113	1	1	
T-115	1	1	
T-20	1	1	
END PROJECT	2	1	2 - RW500 1 - RWN
TOTAL	20	18	6

DATUM	
VERTICAL	N/A
HORIZONTAL	N/A

CONSTRUCTION APPROACH SIGNING SHEET

SURVEYED BY N/A DATE N/A
 DRAWN BY C.A.K. DATE 2/02
 SQUAD LEADER D.E.G.
 DESIGN FILE NO. pave/01b018/pb018.dgn
 IPARM FILE pb018cgs.i DATE 10-JUL-2006 13:30
 PLOTTER
 PROJ. NAME SALISBURY - MIDDLEBURY
 PROJ. NO. NH_2311(1)S
 SHEET 67 OF 67 SHEETS