

646.40 DURABLE 100 mm WHITE LINE  
(ALL LINES WILL INCLUDE EDGE LINE BREAKS AND RADIUS FOR TOWN HIGHWAYS)

MIDDLEBURY:  
STA. 4+260.0 - STA. 4+800.0 LT & RT

646.60 TEMPORARY 100 mm WHITE LINE  
(ALL LINES WILL INCLUDE EDGE LINE BREAKS AND RADIUS FOR TOWN HIGHWAYS)

MIDDLEBURY:  
STA. 4+260.0 - STA. 4+800.0 LT & RT

646.41 DURABLE 100 mm YELLOW LINE  
(ALL LINES WILL INCLUDE C/L BREAKS FOR TOWN HIGHWAYS) S=SOLID, D=DASHED

MIDDLEBURY: LT C RT  
STA. 4+260.0 - STA. 4+300.0 S - D  
STA. 4+300.0 - STA. 4+313.0 - D -  
STA. 4+313.0 - STA. 4+554.4 D - S  
STA. 4+554.4 - STA. 4+800.0 S - S  
STA. 4+654.223 DOUBLE SOLID LT, T-9

646.61 TEMPORARY 100 mm YELLOW LINE  
(ALL LINES WILL INCLUDE C/L BREAKS FOR TOWN HIGHWAYS) S=SOLID, D=DASHED

MIDDLEBURY: LT C RT  
STA. 4+260.0 - STA. 4+300.0 S - D  
STA. 4+300.0 - STA. 4+313.0 - D -  
STA. 4+313.0 - STA. 4+554.4 D - S  
STA. 4+554.4 - STA. 4+800.0 S - S  
STA. 4+654.223 DOUBLE SOLID LT, T-9

646.46 DURABLE 600 mm STOP BAR

MIDDLEBURY:  
STA. 4+654.223 LT, T-9

646.66 TEMPORARY 600 mm STOP BAR

MIDDLEBURY:  
STA. 4+654.223 LT, T-9

646.50 DURABLE LETTER OR SYMBOL

MIDDLEBURY:  
STA. 4+654.223 LT, T-9, "S,T,O,P" (4 EA)

646.70 TEMPORARY LETTER OR SYMBOL

MIDDLEBURY:  
STA. 4+654.223 LT, T-9, "S,T,O,P" (4 EA)

675.50 REMOVING SIGNS

AS SHOWN - 6

675.60 ERECTING SALVAGED SIGNS

AS SHOWN - 3

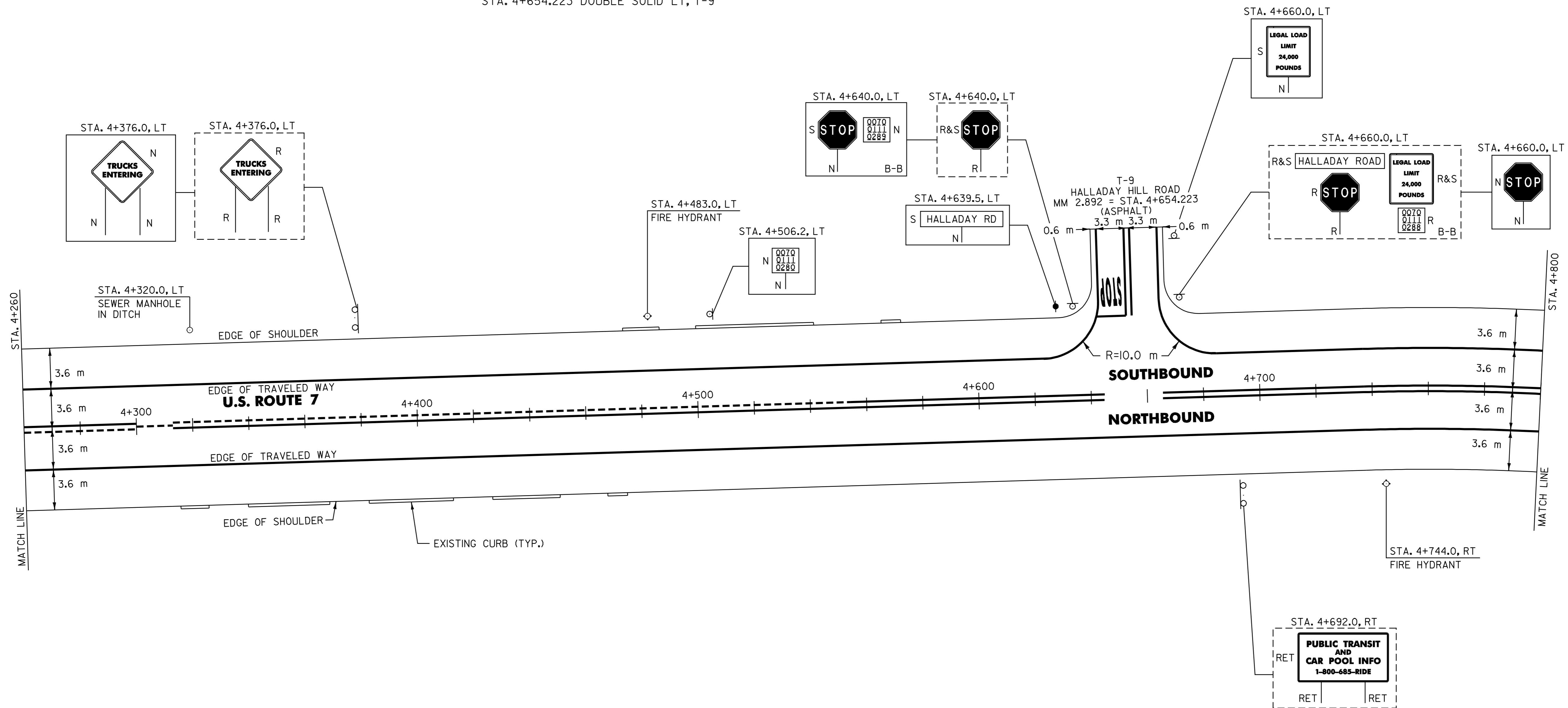

NOTE:  
I. PAVING LIMIT ON ALL TOWN HIGHWAYS SHALL BE MEASURED 8 m BACK FROM U.S. ROUTE 7 EDGE OF SHOULDER UNLESS DENOTED OTHERWISE ON THE PLANS OR AS DIRECTED BY THE RESIDENT ENGINEER.

DATUM	
VERTICAL	N/A
HORIZONTAL	N/A

SIGN LEGEND  
R= REMOVE  
S= SALVAGE  
N= NEW  
RET= RETAIN  
B-B= BACK TO BACK  
EXISTING= \_\_\_\_\_  
NEW= \_\_\_\_\_

<h2>PAVING PROJECT LAYOUT # 21</h2>	SURVEYED BY	N/A	DATE	N/A
	DRAWN BY	C.A.K.	DATE	2/02
	SQUAD LEADER	D.E.G.		
	DESIGN FILE NO.	pave/01b018/pb018.dgn		
	IPARM FILE	pb018p21.i	DATE PLOTTED	10-JUL-2006 13:58
	PROJ. NAME	SALISBURY - MIDDLEBURY		
PROJ. NO.	NH_231111S			
SHEET	30	OF	67	SHEETS