

646.40 DURABLE 100 mm WHITE LINE
 (ALL LINES WILL INCLUDE EDGE LINE BREAKS AND RADIUS FOR TOWN HIGHWAYS)

MIDDLEBURY:
 STA. 3+720.0 - STA. 4+260.0 LT & RT

646.60 TEMPORARY 100 mm WHITE LINE
 (ALL LINES WILL INCLUDE EDGE LINE BREAKS AND RADIUS FOR TOWN HIGHWAYS)

MIDDLEBURY:
 STA. 3+720.0 - STA. 4+260.0 LT & RT

646.41 DURABLE 100 mm YELLOW LINE
 (ALL LINES WILL INCLUDE C/L BREAKS FOR TOWN HIGHWAYS) S=SOLID, D=DASHED

MIDDLEBURY: LT C RT
 - D D - S
 STA. 3+720.0 - STA. 3+887.0 D - S
 STA. 3+887.0 - STA. 4+063.6 D - S
 STA. 4+063.6 - STA. 4+128.0 S - S
 STA. 4+128.0 - STA. 4+260.0 S - D
 STA. 4+092.562 DOUBLE SOLID LT, T-26
 STA. 4+115.093 DOUBLE SOLID RT, T-7

646.61 TEMPORARY 100 mm YELLOW LINE
 (ALL LINES WILL INCLUDE C/L BREAKS FOR TOWN HIGHWAYS) S=SOLID, D=DASHED

MIDDLEBURY: LT C RT
 - D D - S
 STA. 3+720.0 - STA. 3+887.0 D - S
 STA. 3+887.0 - STA. 4+063.6 D - S
 STA. 4+063.6 - STA. 4+128.0 S - S
 STA. 4+128.0 - STA. 4+260.0 S - D
 STA. 4+092.562 DOUBLE SOLID LT, T-26
 STA. 4+115.093 DOUBLE SOLID RT, T-7

646.46 DURABLE 600 mm STOP BAR

MIDDLEBURY:
 STA. 4+092.562 LT, T-26
 STA. 4+115.093 RT, T-7

646.66 TEMPORARY 600 mm STOP BAR

MIDDLEBURY:
 STA. 4+092.562 LT, T-26
 STA. 4+115.093 RT, T-7

675.50 REMOVING SIGNS

AS SHOWN - 12

675.60 ERECTING SALVAGED SIGNS

AS SHOWN - 7

604.42 CHANGING ELEVATION OF SEWER MANHOLES

STA. 4+092.6 LT.

646.50 DURABLE LETTER OR SYMBOL

MIDDLEBURY:
 STA. 4+092.562 LT, T-26, "S,T,O,P" (4 EA)
 STA. 4+115.093 RT, T-7, "S,T,O,P" (4 EA)

646.70 TEMPORARY LETTER OR SYMBOL

MIDDLEBURY:
 STA. 4+092.562 LT, T-26, "S,T,O,P" (4 EA)
 STA. 4+115.093 RT, T-7, "S,T,O,P" (4 EA)

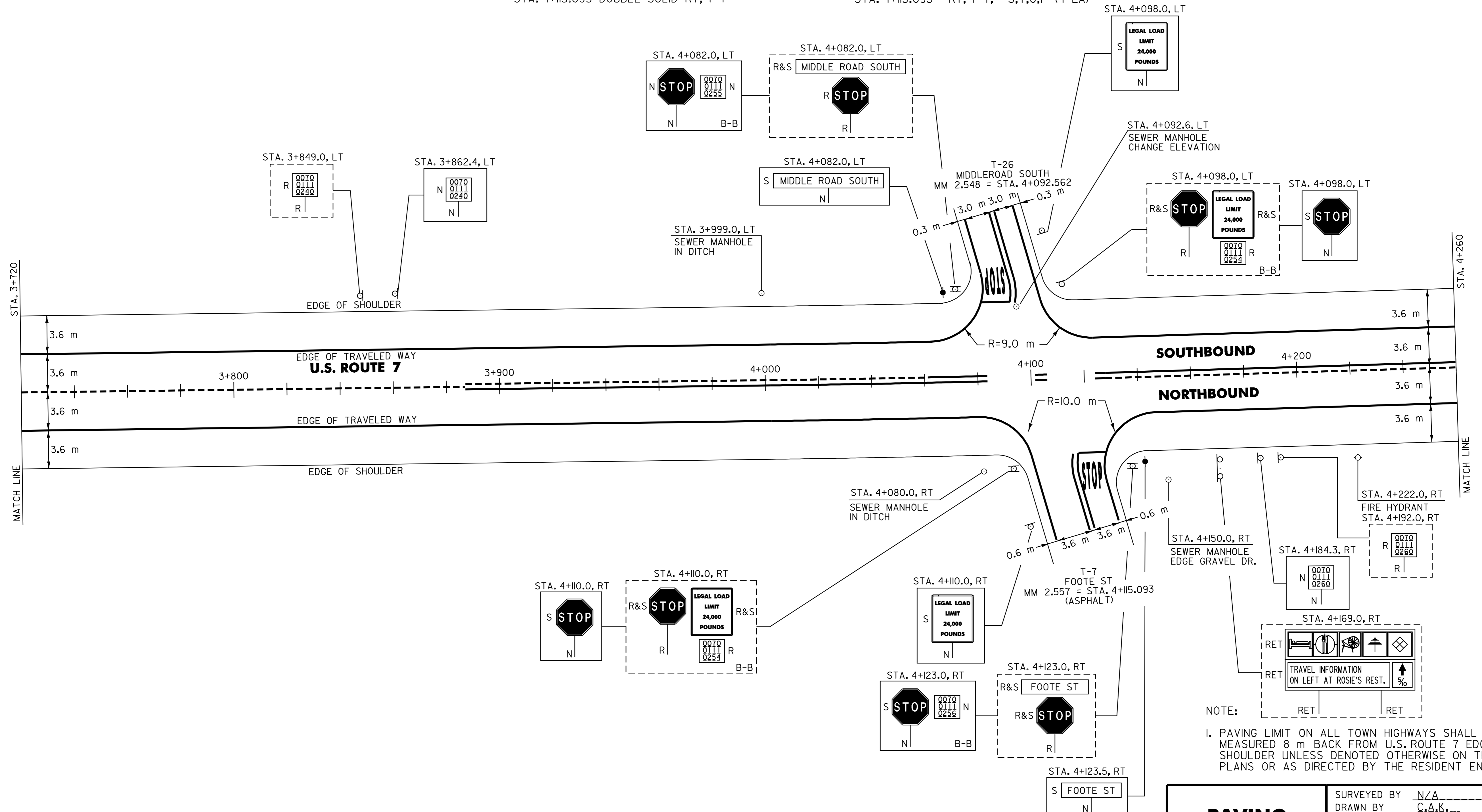

PAVING PROJECT LAYOUT # 20

SIGN LEGEND
 R= REMOVE
 S= SALVAGE
 N= NEW
 RET= RETAIN
 B-B= BACK TO BACK
 EXISTING=
 NEW=

SURVEYED BY	N/A	DATE	N/A
DRAWN BY	C.A.K.	DATE	2/02
SQUAD LEADER	D.E.G.		
DESIGN FILE NO.	pave/01b018/01b018.dgn		
IPARM FILE	p018p20.i	DATE PLOTTED	10-JUL-2006 13:30
PROJ. NAME	SALISBURY - MIDDLEBURY		
PROJ. NO.	NH_231111		
SHEET	29	OF	67 SHEETS

DATUM	
VERTICAL	N/A
HORIZONTAL	N/A